

AUTOMATIC ABOVE-GROUND COVER

# Rollin

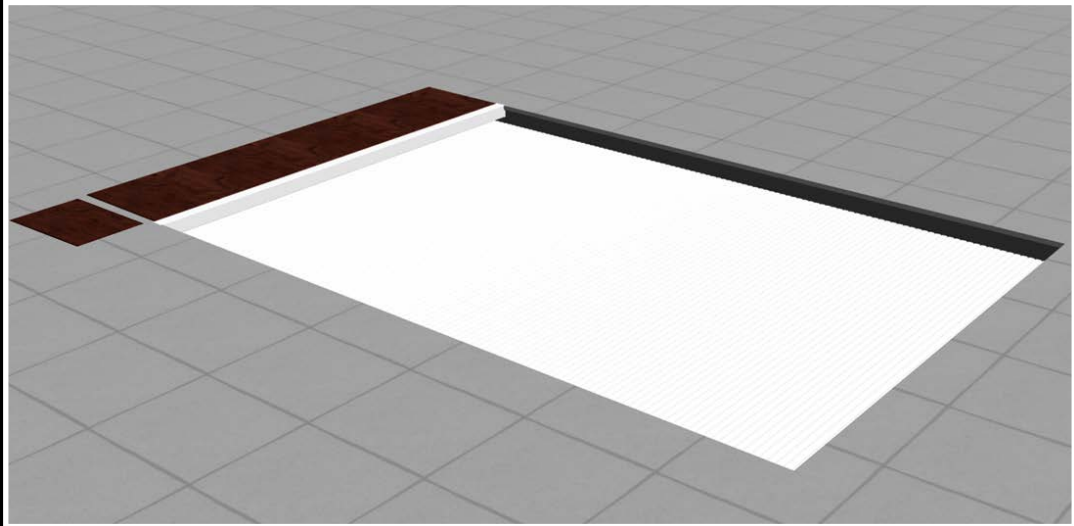

## TECHNICAL INSTRUCTIONS

Installation / Use / Cleaning / Maintenance / Safety advice

**DEL**   
**Comfort**



**THIS NOTICE MUST BE GIVEN TO THE POOL OWNER  
PLEASE READ CAREFULLY AND KEEP IN A SAFE PLACE**

## PARTS INCLUDED IN THE DELIVERY

### Wall units

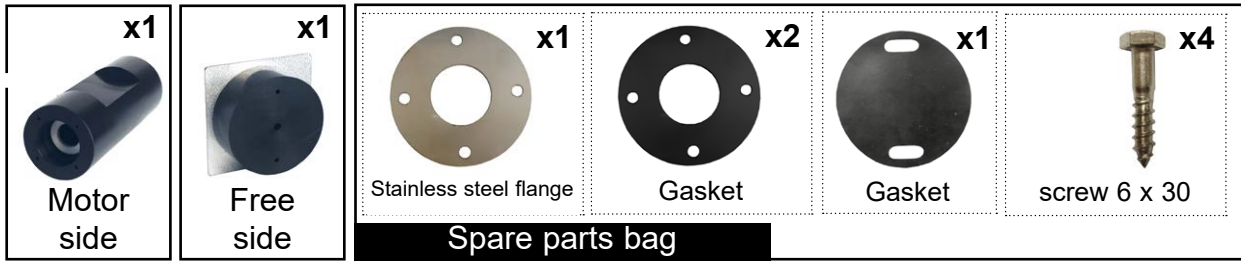

### Installation kit

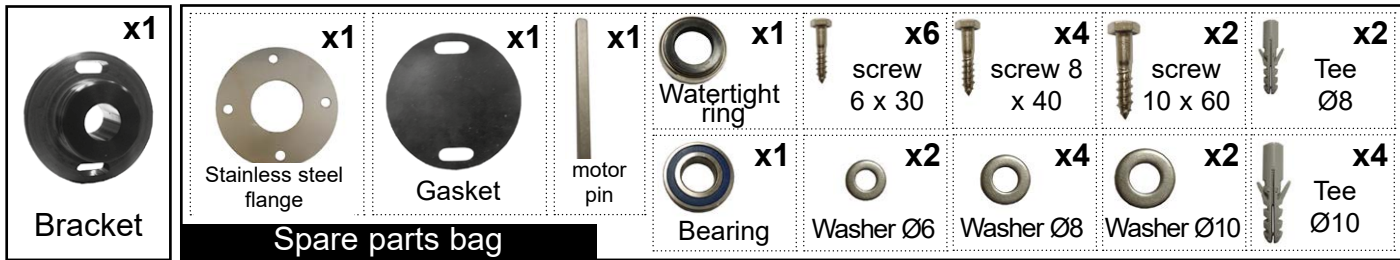

### Motor with support

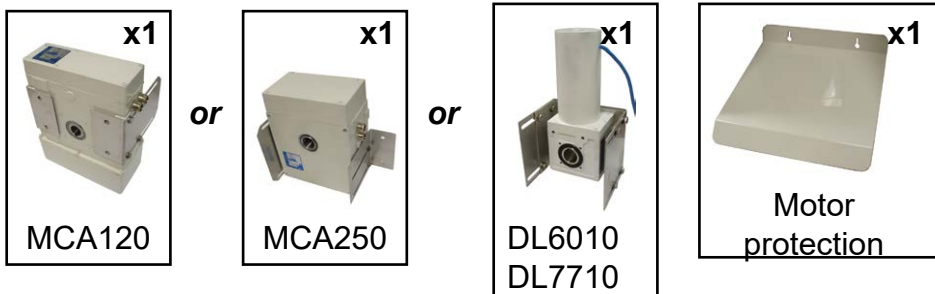

### Control panel with

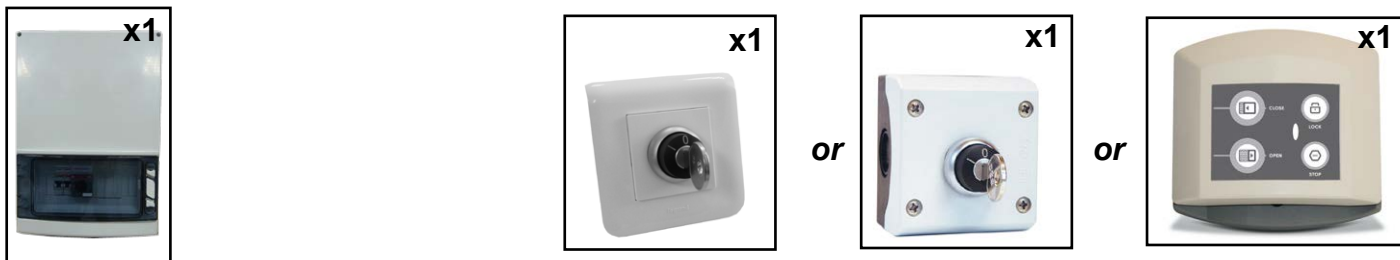

### Weights



### Tube

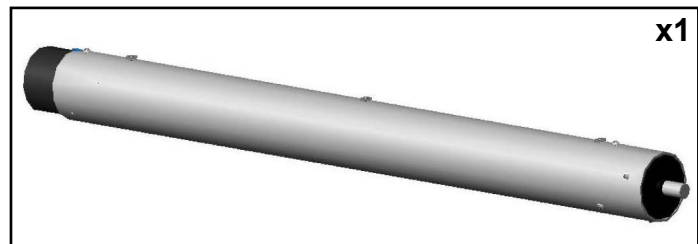
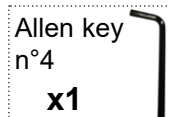

### OPTION - Safety locking kit «according to your order» (1 box)

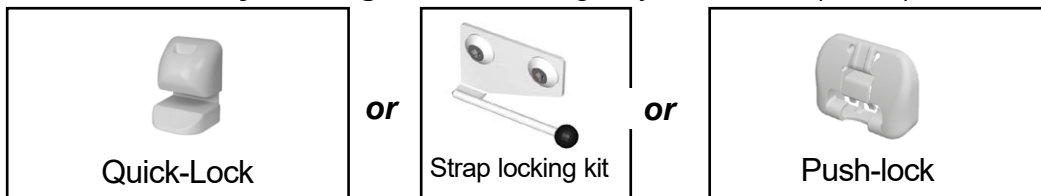

3 fitting models : Surface mounted - Insert mounted - Hanging mounted

### Beam support «Model according to your order» (1 box)

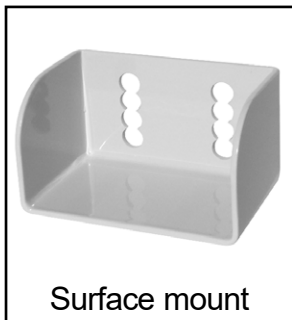

Surface mount

or



Adjustable hanging mount

or



Insert mount

### Slats (model, colour and number of boxes according to your order)



### Decking "Model according to your order" (1 pallet)



### Aluminium beam "Model according to your order" (1 box)



Hanging and surface mount

or

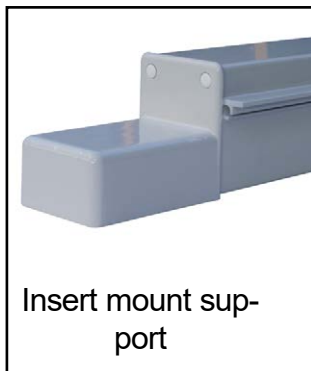

Insert mount support

### Middle telescopic support (1 box)

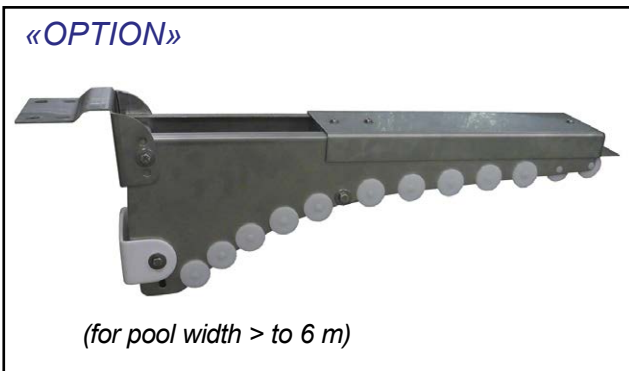

## NECESSARY TOOLS - (INSTALLATION - 2 PERSONS)

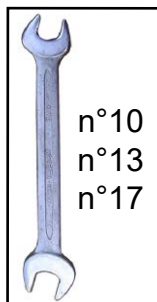

## PACKING LIST

### example - for a 5 x 10 m pool with Ø3 m step unit

Support + control box : 1 box of 0.65 x 0.45 x 0.25 --- 40 Kg

Tube with motor : 1 box of 0.20 x 5.10 m --- 40 Kg

Aluminum beam : 1 box of 0.15 x 0.15 x 5.10 m --- 40 Kg

Beam support : 1 box of 0.30 x 0.20 x 0.20 m --- 10 Kg

Decking : 1 pallet of 1.20 x 1.00 x 0.50 m --- 100 Kg

Slats : 5 box of 0.25 x 0.20 x 5.00 m --- 250 Kg

locking kit : 1 box of 0.30 x 0.20 x 0.20 m or 0.75 x 0.25 x 0.15 m --- 5 KG

**Total weight : 485 Kg**



**INFORMATION**

For concrete, cellular concrete, full or hollow masonry pools.

Open pool : the cover is in the cover pit under the decking.

The decking is supported by a beam installed on beam supports.

The depth of the tube is 55cm under the coping stones.

The mains supply comes from the electric control panel in the plant room.

The motor is located in a watertightness pit, and must be kept dry (forecast a drainage).

The automatic stop are adjusted in the motor or in the control panel (depends on the model).

The switch is located in a dry location with a view on the pool.

The cover is made of watertight floating slats

motor conform to electrical standards



Decking

slats

Gap between the wall and the cover

Safety wall or Sécuriwall



Switch with maintained contact during locking looking at the pool



OPTION Safety locking kits



Control box conform to electrical standards :  
C 15-100  
NF EN 60335  
NF EN 61000-6-3  
NF EN 55014-1

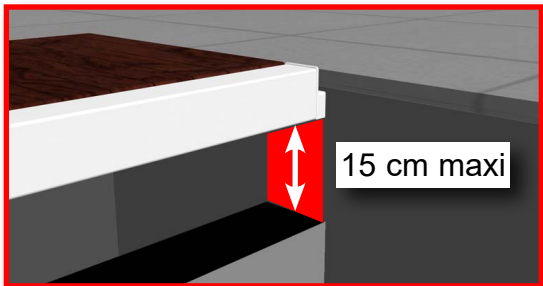

15 cm maxi

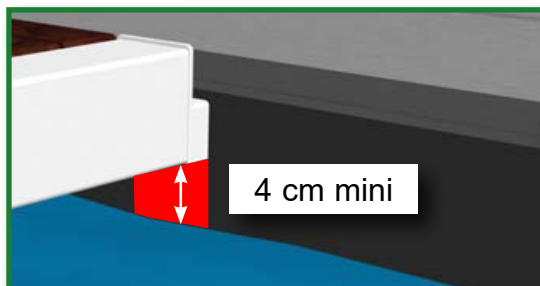

4 cm mini

## COVER PIT

**i** The sides of the cover pit must be vertical and parallel between them.

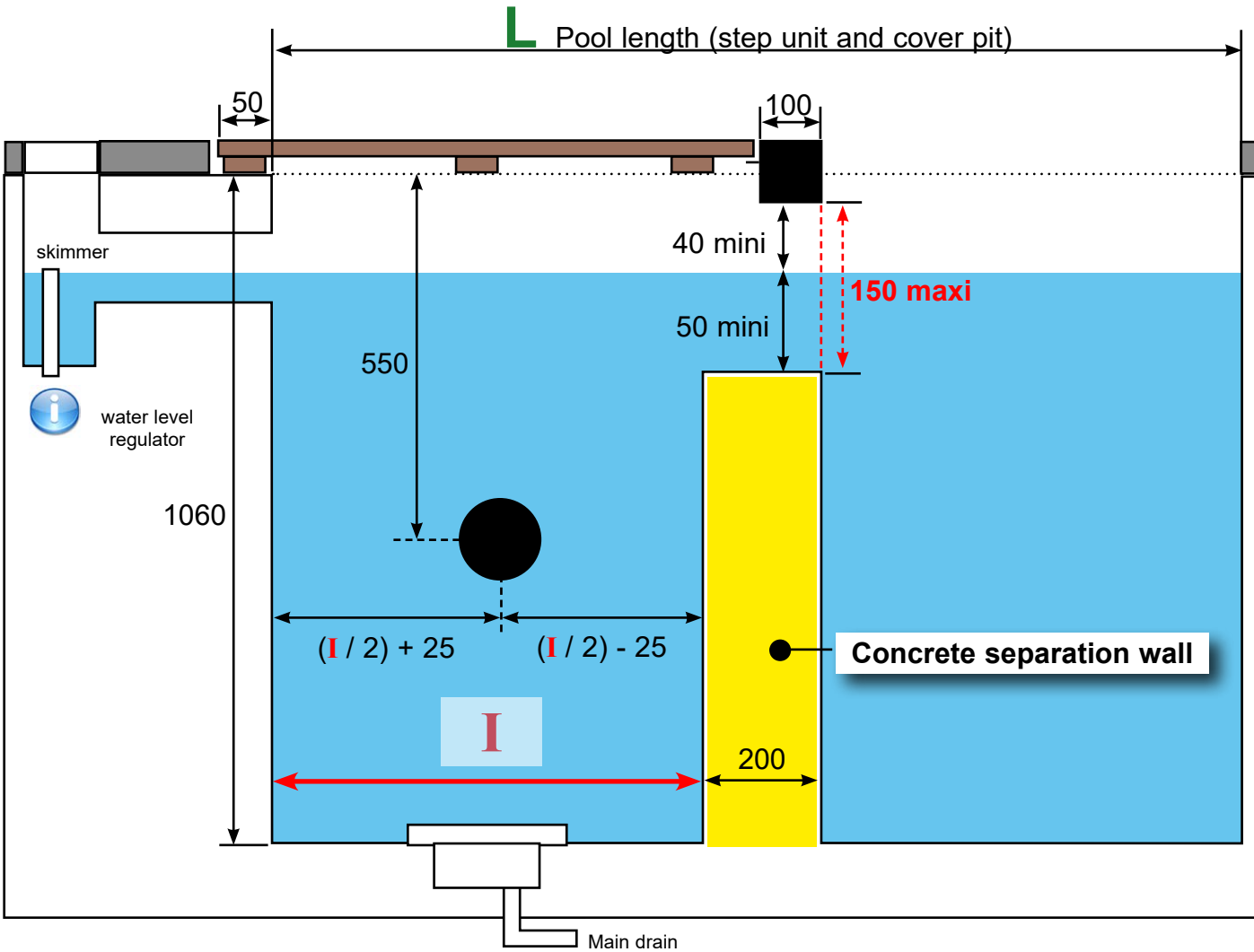

6



With straight radius or radius and cut sides  $\leq$  to 10 cm back of the cover pit

Decking  
750

Decking  
900

L (en m)	< 6	6 à 7	7 à 8	8à9	9à10	10à11	11à12	12à13	13à14	14à15	15à16	16à17
I (en mm)	548	574	600	621	643	664	684	703	722	740	750	775

L (en m)	17à18	18à19	19à20	20à21	21à22	22à23	23à24	24à25	25à26	26à27	27à28	28à30
I (en mm)	791	807	823	839	854	869	883	897	911	925	938	965

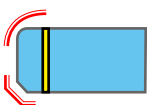

With radius and cut sides  $>$  to 10 cm back of the cover pit

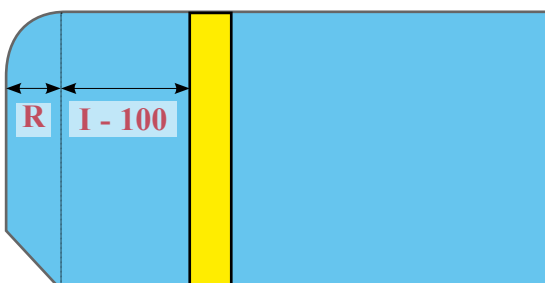

**The dimension I (minimum distance of the cover pit) must be taken at the end of the radius or the cut side.**

# COVER PIT

**i** the cover may be placed to the right or left of the pool.

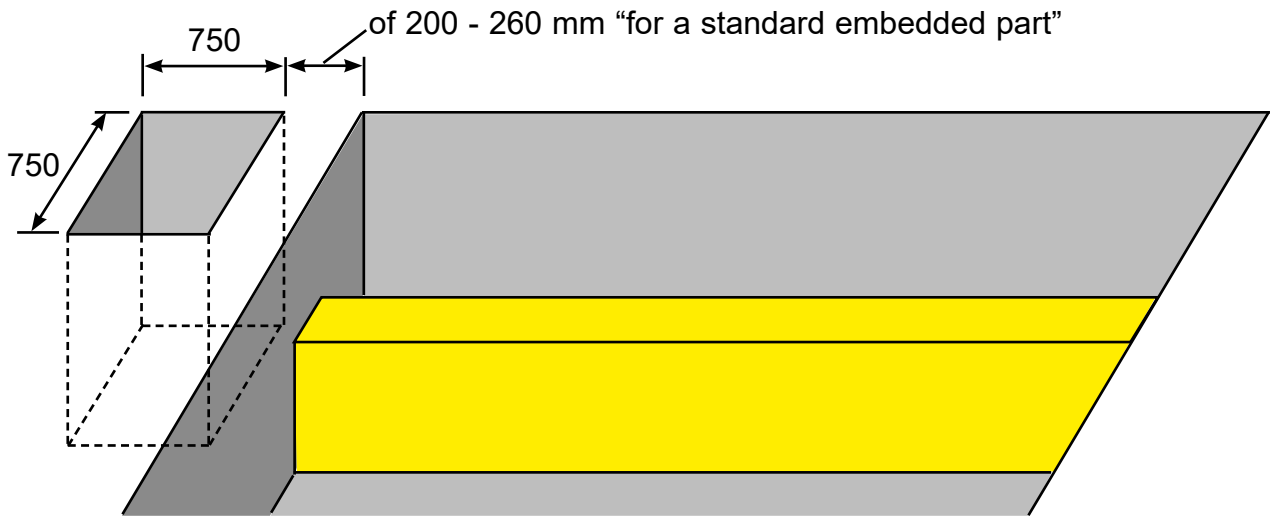

# WALL UNITS

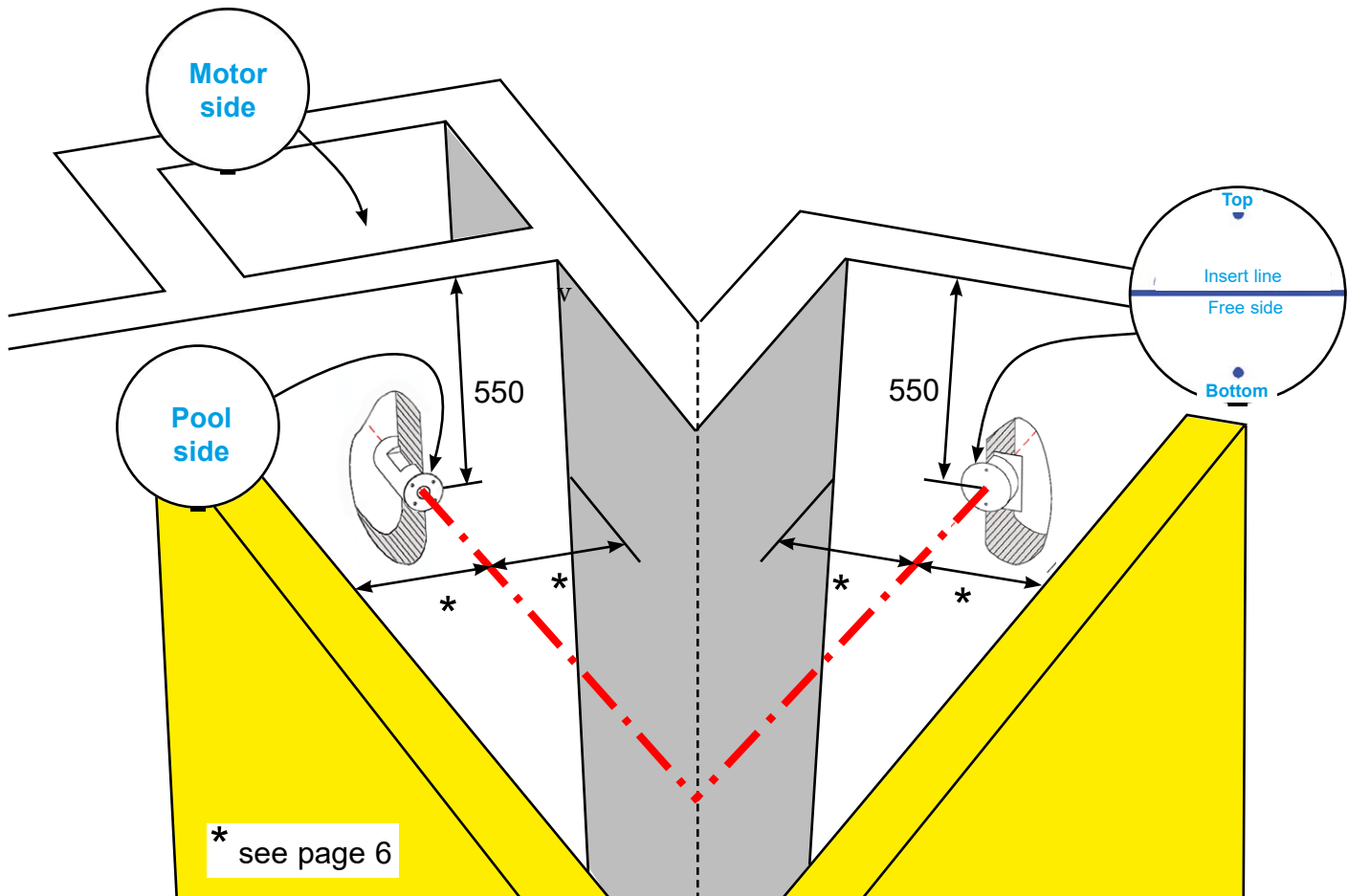
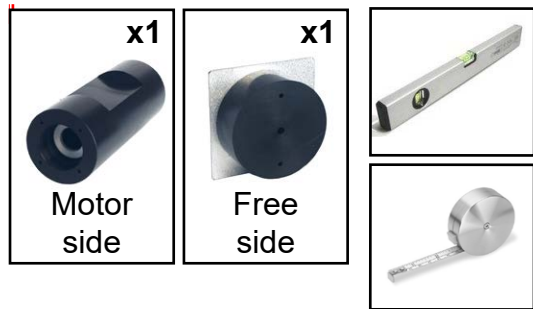

## INSTALLATION OF THE FLANGE MOTOR SIDE

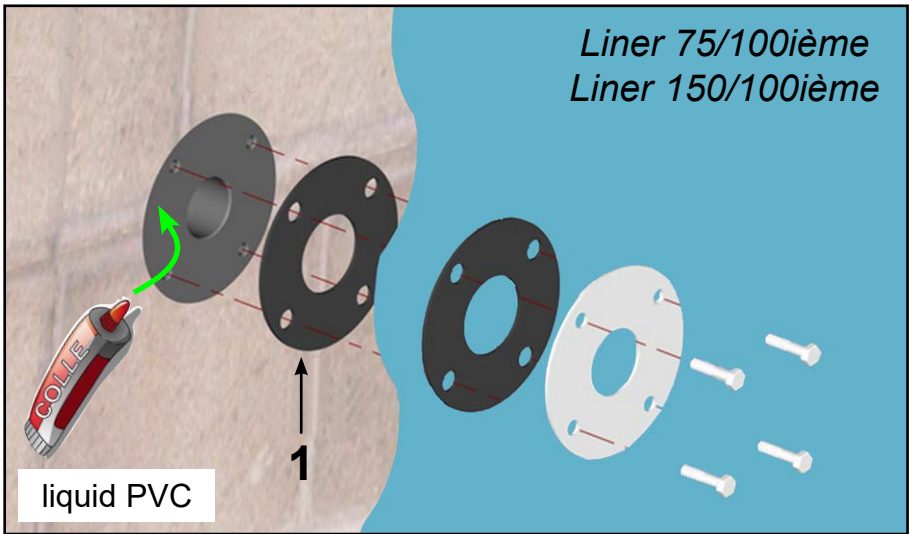
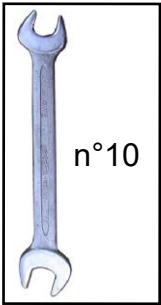
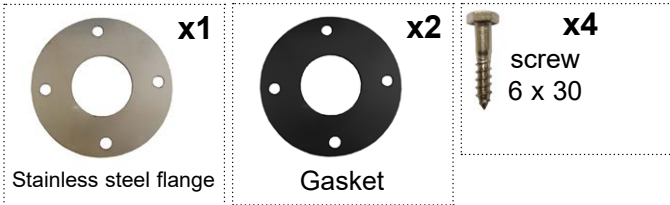

for other kind of water-tightness, do not install the gasket n°1.

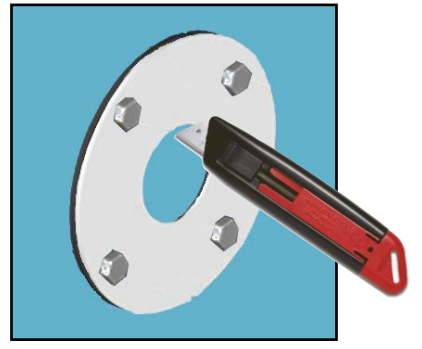

- Fill in with water (approximately 20cm) before fixing the flange.
- Cut the liner in the middle of the flange with a punch

## INSTALLATION OF THE FLANGE FREE SIDE

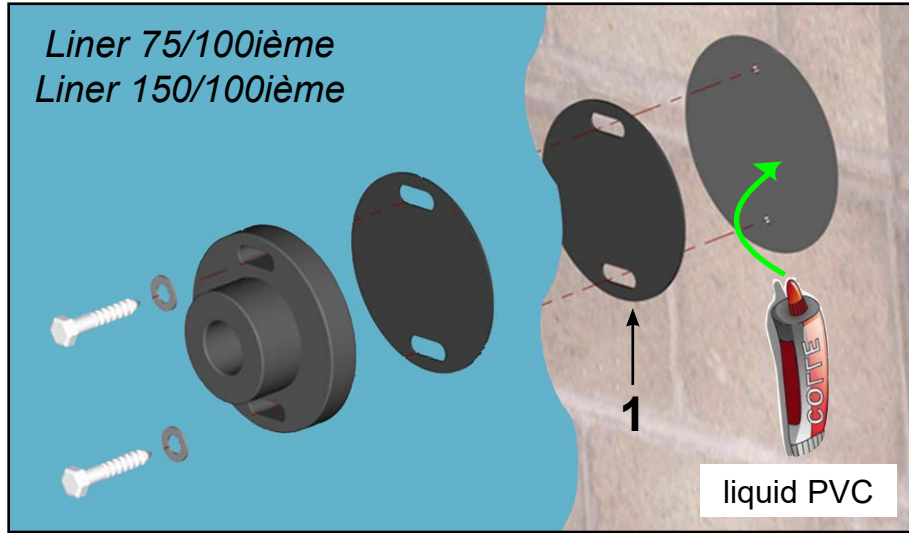
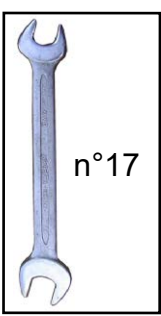
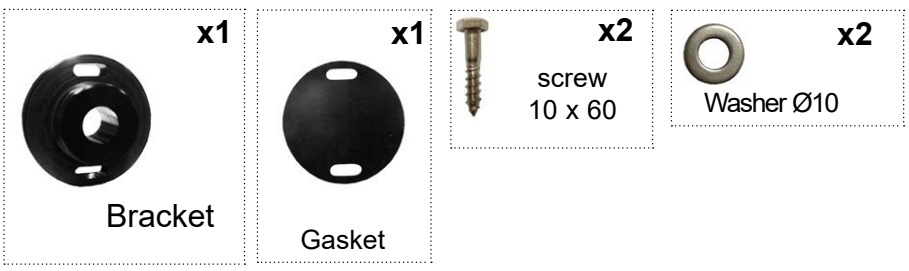

for other kind of water-tightness, do not install the gasket n°1.

- Fill in with water (approximately 20cm) before fixing the flange.
- Cut the liner in the middle of the flange with a punch.



# TUBE INSTALLATION

- |                               |                             |                               |
|-------------------------------|-----------------------------|-------------------------------|
| allen key<br>n°4<br><b>x1</b> | screw<br>M6x30<br><b>x5</b> | Washer<br>PVC Ø6<br><b>x5</b> |
|-------------------------------|-----------------------------|-------------------------------|
- Spare parts bag

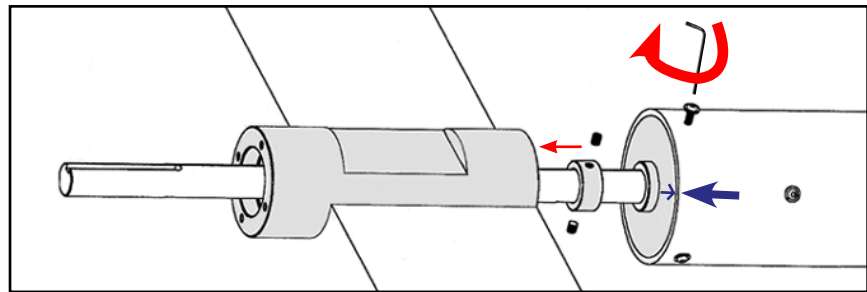
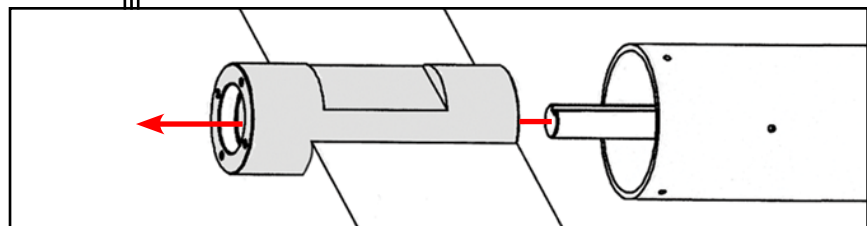
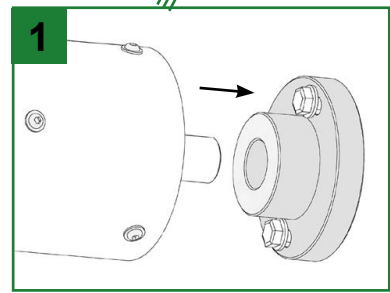
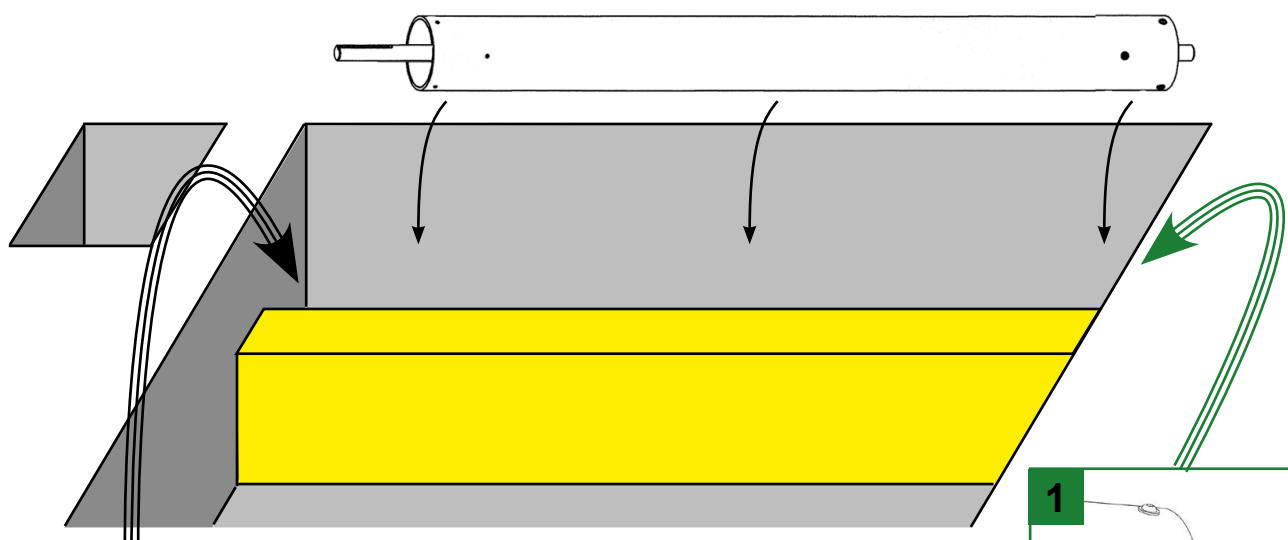
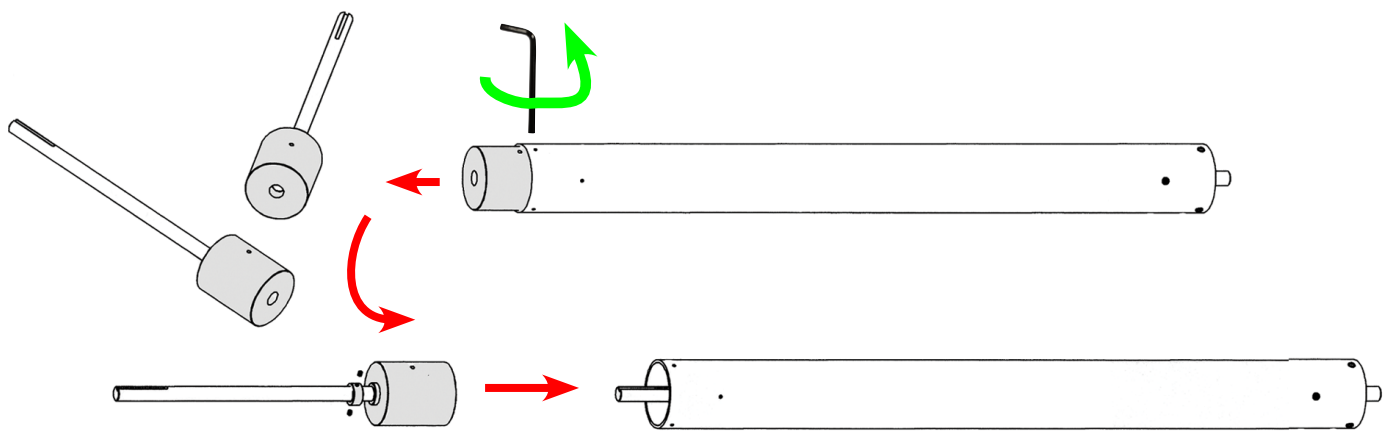
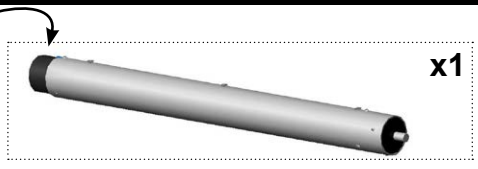

- |                             |                               |
|-----------------------------|-------------------------------|
| Screw<br>M6x30<br><b>x5</b> | Washer<br>PVC Ø6<br><b>x5</b> |
|-----------------------------|-------------------------------|

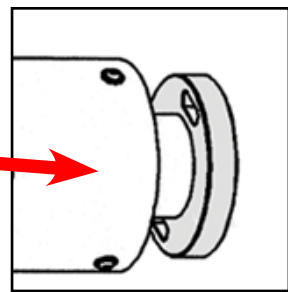
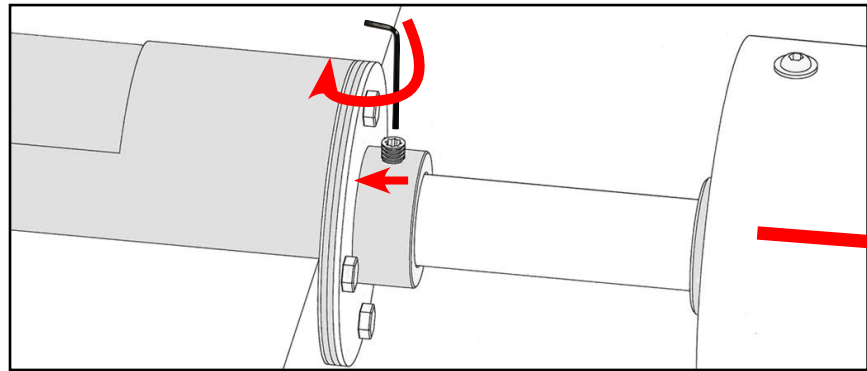

## MOTOR WATER TIGHTNESS

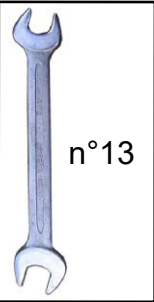
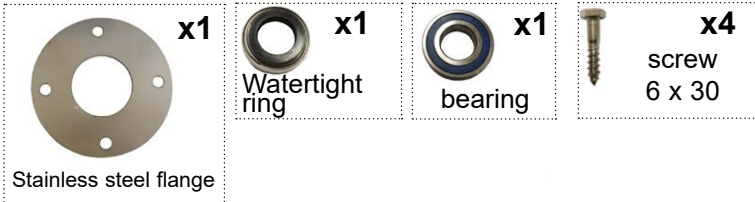

*The spring of this ring must be on the bearing side*

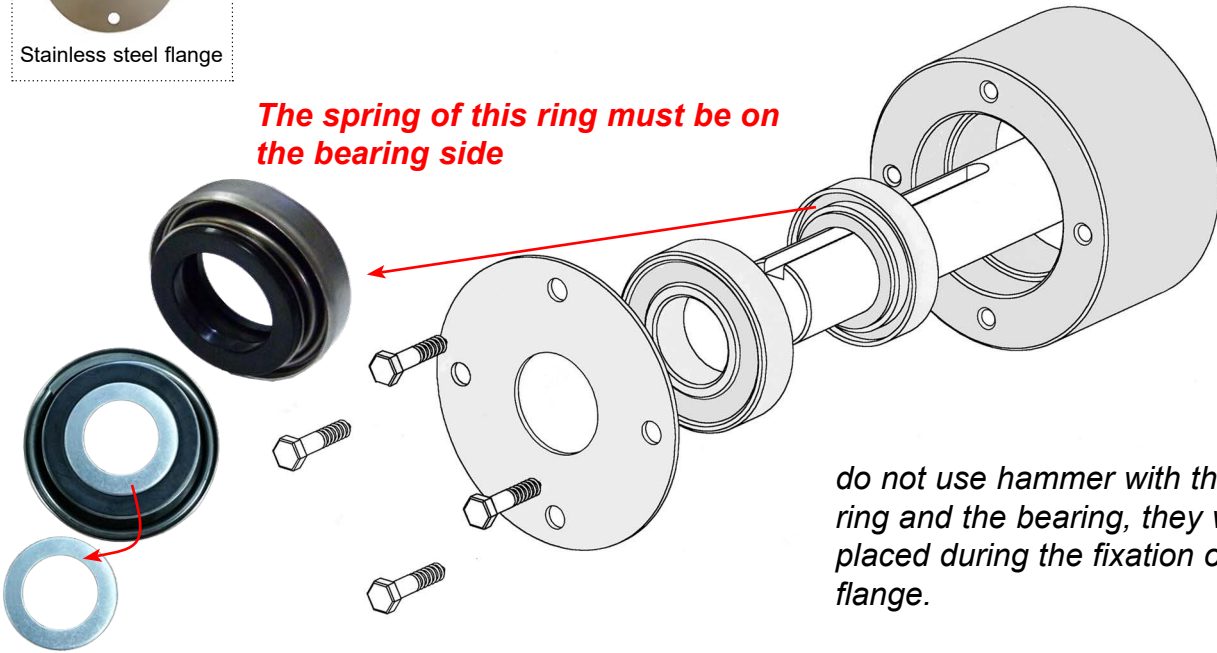

*do not use hammer with the watertight ring and the bearing, they will be placed during the fixation of the flange.*

## MOTOR INSTALLATION

10

### Change the motor supports



MCA 120

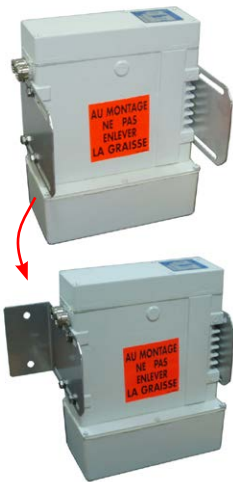

MCA 250



### Motor installation

MCA 120

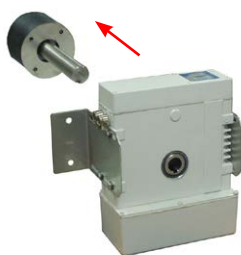

MCA 250

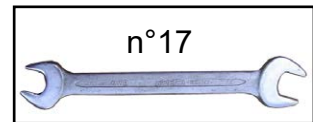

PL6010/7710



PL6010/7710

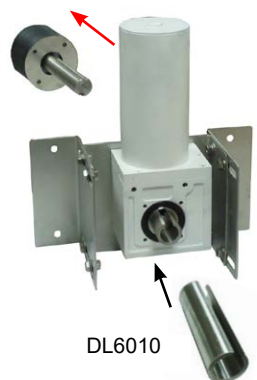

## Fixation

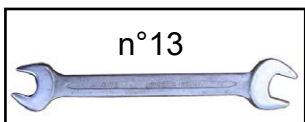

MCA 120

MCA 250

PL6010/7710

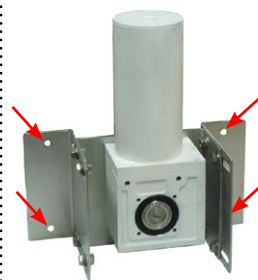
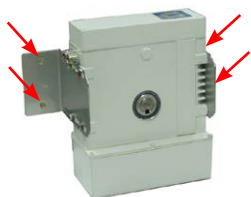

## Put the motor pin

MCA 120

MCA 250

PL6010/7710



## Motor protection installation

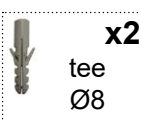
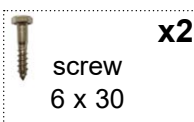
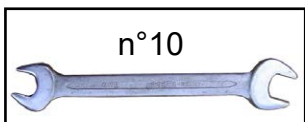

MCA 120

MCA 250

PL6010/7710



Option : electrical plug

## BEAM SUPPORTS

### Adjustable hanging mounted model

For concrete or panel pools



Align the beam support with the separating wall

Cover pit

15 cm  
Max

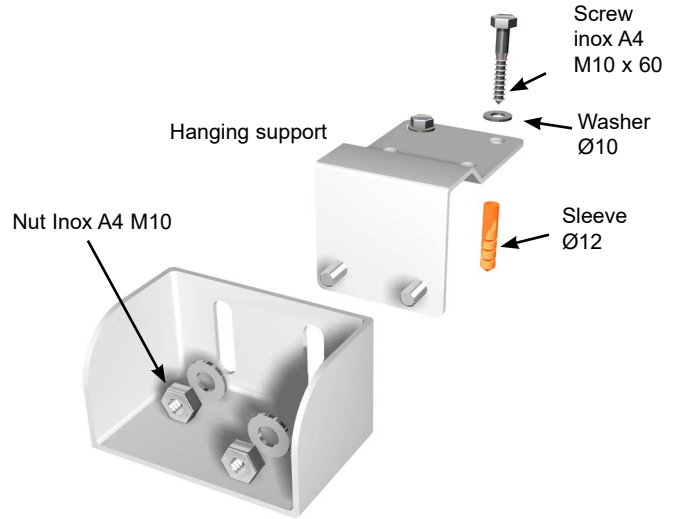

**Panel settlement :**

	<b>Screw M8 x 20</b> 	<b>Washer Ø8</b> 	<b>Nut M8</b> 
---	---	---	--

### Insert mounted model

For concrete pools

Align the beam support with the separating wall

Cover pit

15 cm  
Max

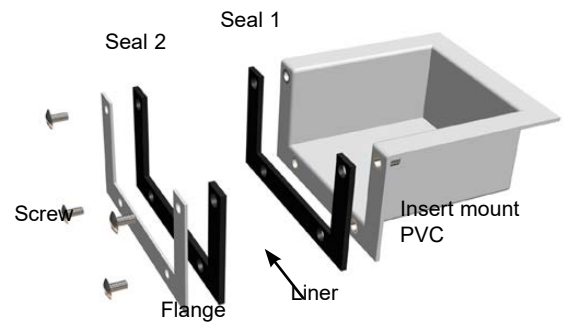

**Information icon**

Glue the first gasket of the beam support.  
Install the liner.  
Install the second gasket, the stainless steel flange and screw.  
Cut the liner inside the beam support with a cutter.

## Surface mounted model

For concrete or panel pools and pools with a wall thicker than 8mm

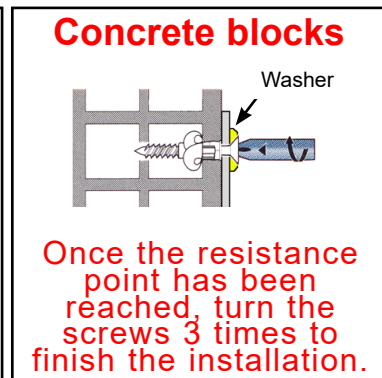
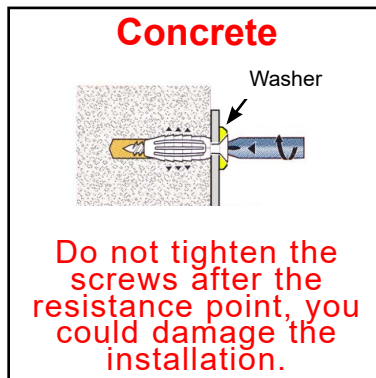
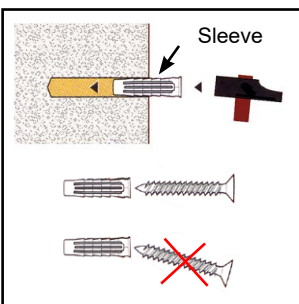
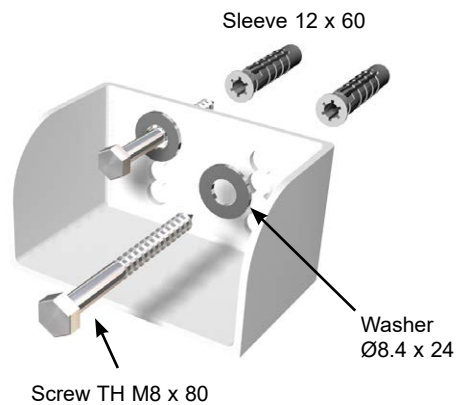
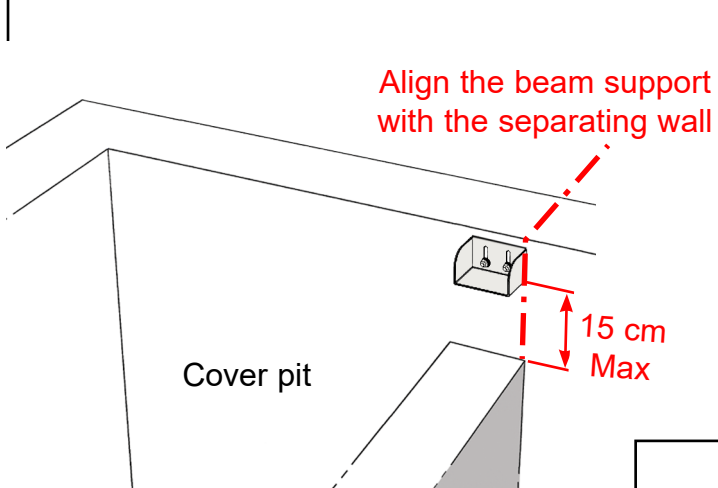

## COVER INSTALLATION

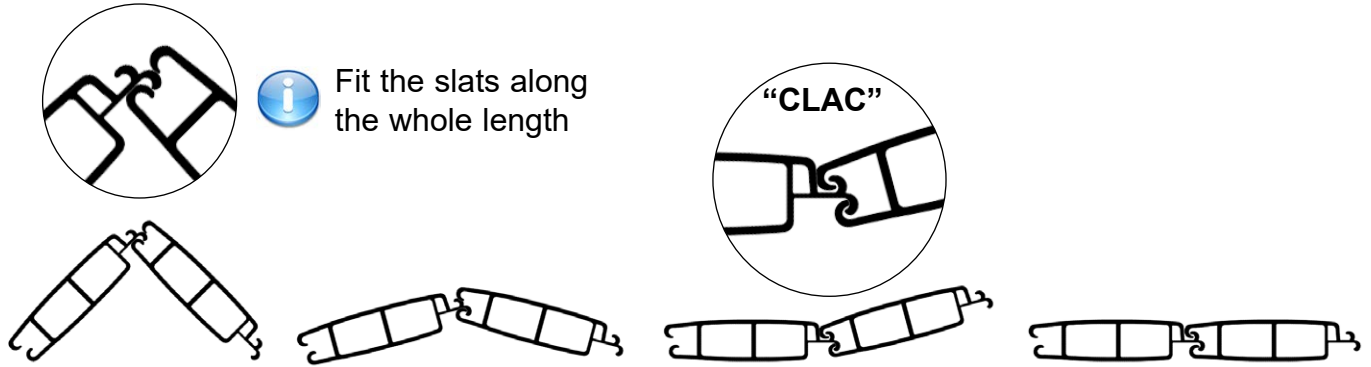
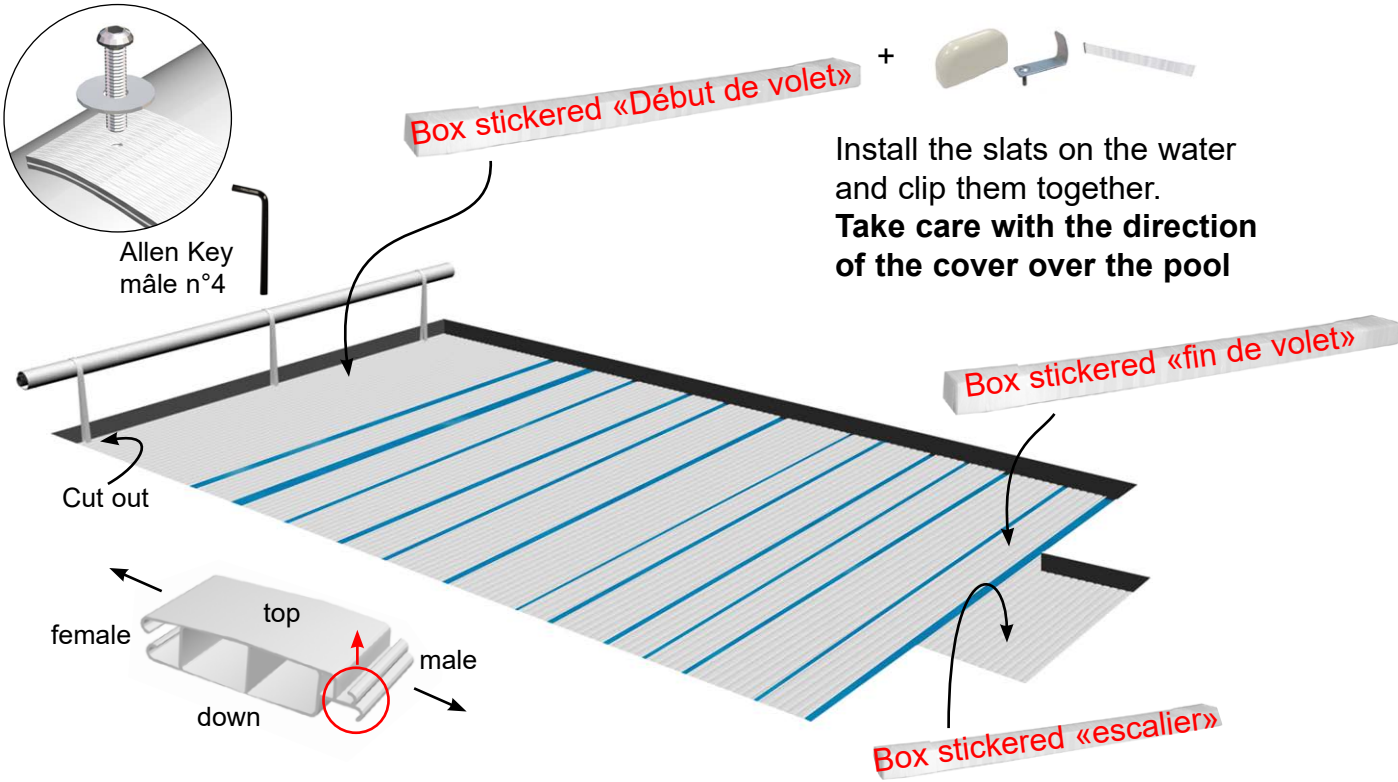

**i** Repeated wiggling/handling of the slats may be needed..

## STEP UNIT HOOK INSTALLATION

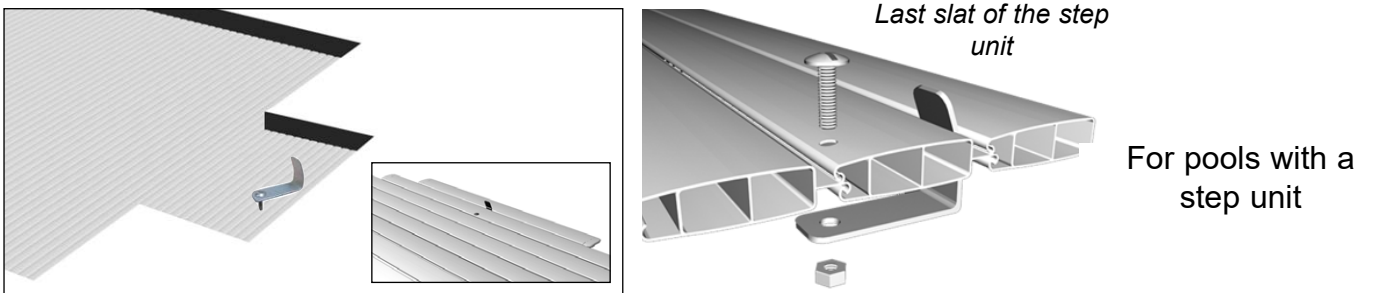

## HOW TO TAKE OFF A SLAT AND END CAPS ?

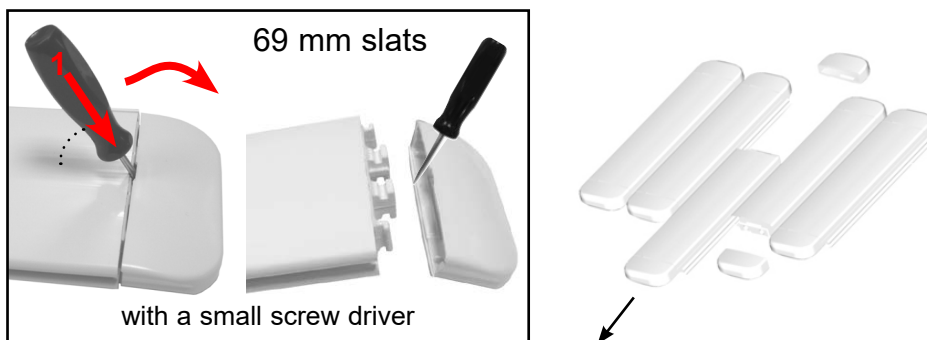

# ALUMINIUM BEAM INSTALLATION

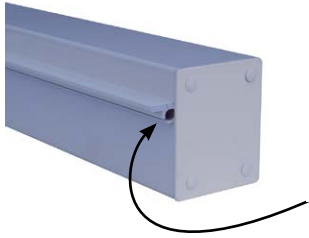

Cover pit side

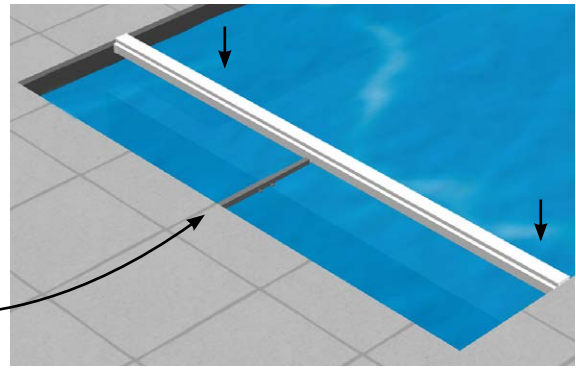

Middle telescopic support

# OPTION MIDDLE TELESCOPIC SUPPORT

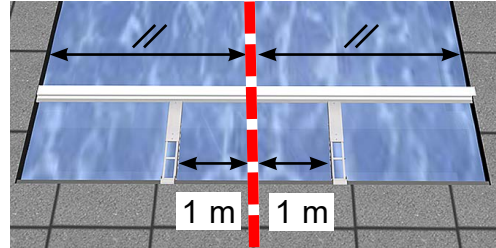
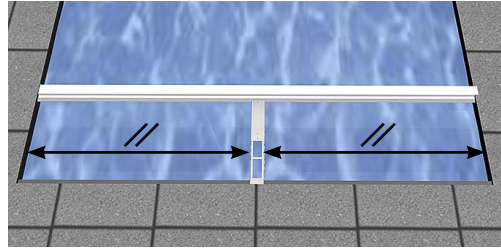
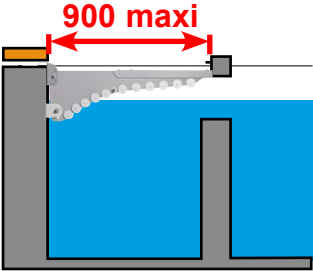

For pool over 6 m wide, you need to install 1 or 2 middle telescopic support, to maintain the beam.

# WEIGHT INSTALLATION

Weights guarantee a better reeling of the cover around the tube and guide the cover. The weight for the step unit prevents the slats from falling behind the cover pit.

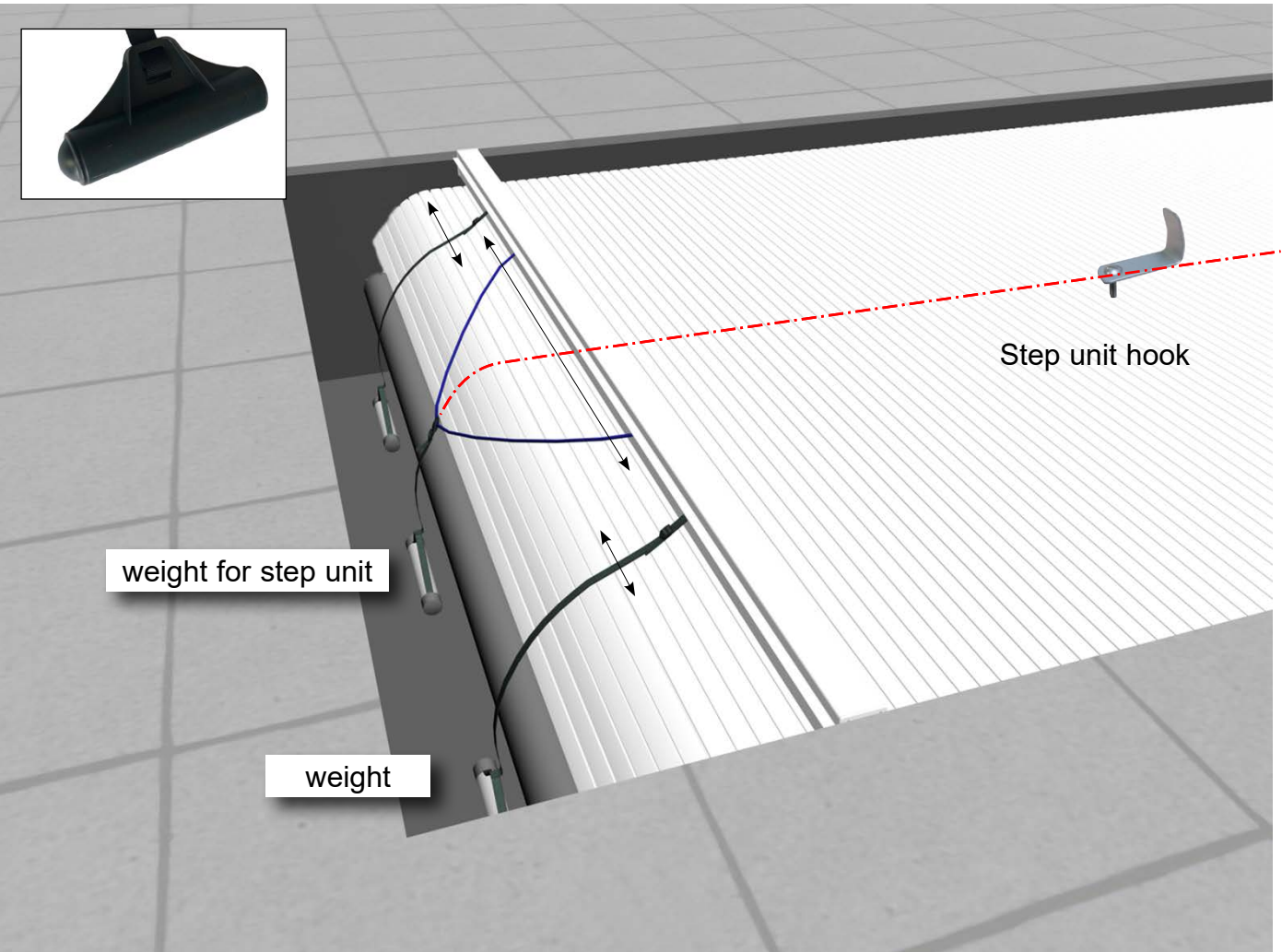

ADJUSTMENT OF THE WEIGHT DEPTH

Adjust the depth of the weight

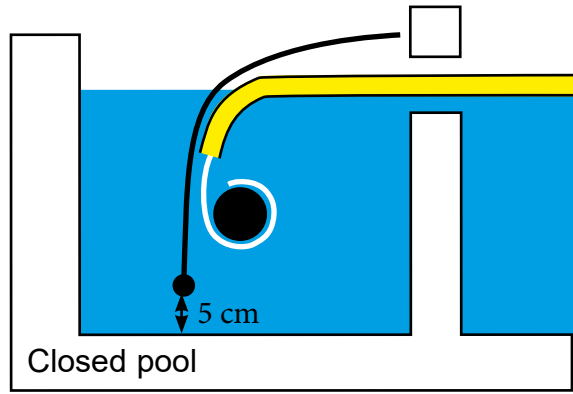
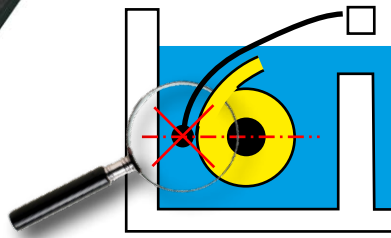

Closed pool

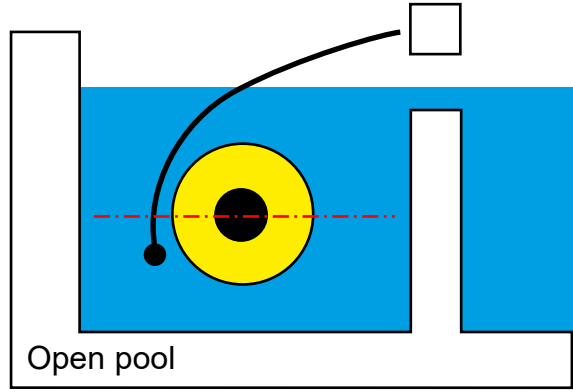

Open pool

DECKING INSTALLATION

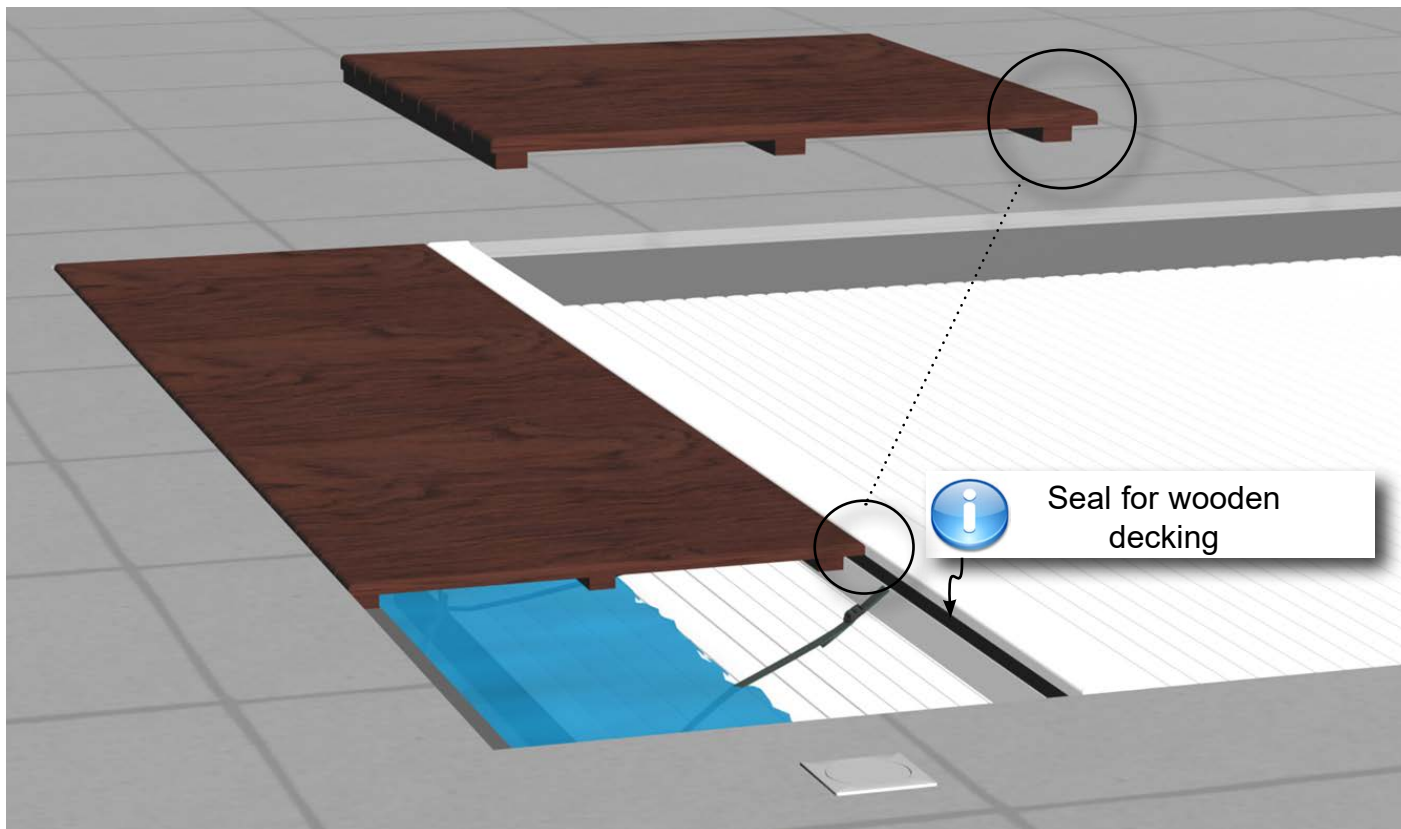

Seal for wooden decking



# ELECTRICAL DRAWING CONTROL BOX - MOTOR MCA120 / MCA250 / WI-KEY

The electric control box must be fitted in a dry room.  
 The installation must comply with the NF C15-100 standard, et CEI 60364 (Last applicable version) ask your electrician for advice or contact your electricity provider.  
 All our control boxes use a 230 Volt single phase (50Hz) power supply.  
 The required power at the input terminals is 0.15 Kw.  
 Upstream from the control box a suitably sized circuit breaker with a 30 mA ground fault device must be provided.  
 For additional information, see the instructions supplied with the electrical box.

\* Bornier « 15-16-17 » Pilotage de la pompe de filtration.  
 Lorsque la couverture est en mouvement : Contact C-NO ouvert (stop flow) et contact C-NC fermé (go flow)  
 Lorsque la couverture est à l'arrêt : Contact C-NO fermé et contact C-NC ouvert  
 \*\* Bornier « 12-13-14 » Gestion de l'électrolyseur.  
 Tablier fermé :  
 Contact C-NO fermé et contact C-NC ouvert  
 Tablier ouvert :  
 Contact C-NO ouvert et contact C-NC fermé

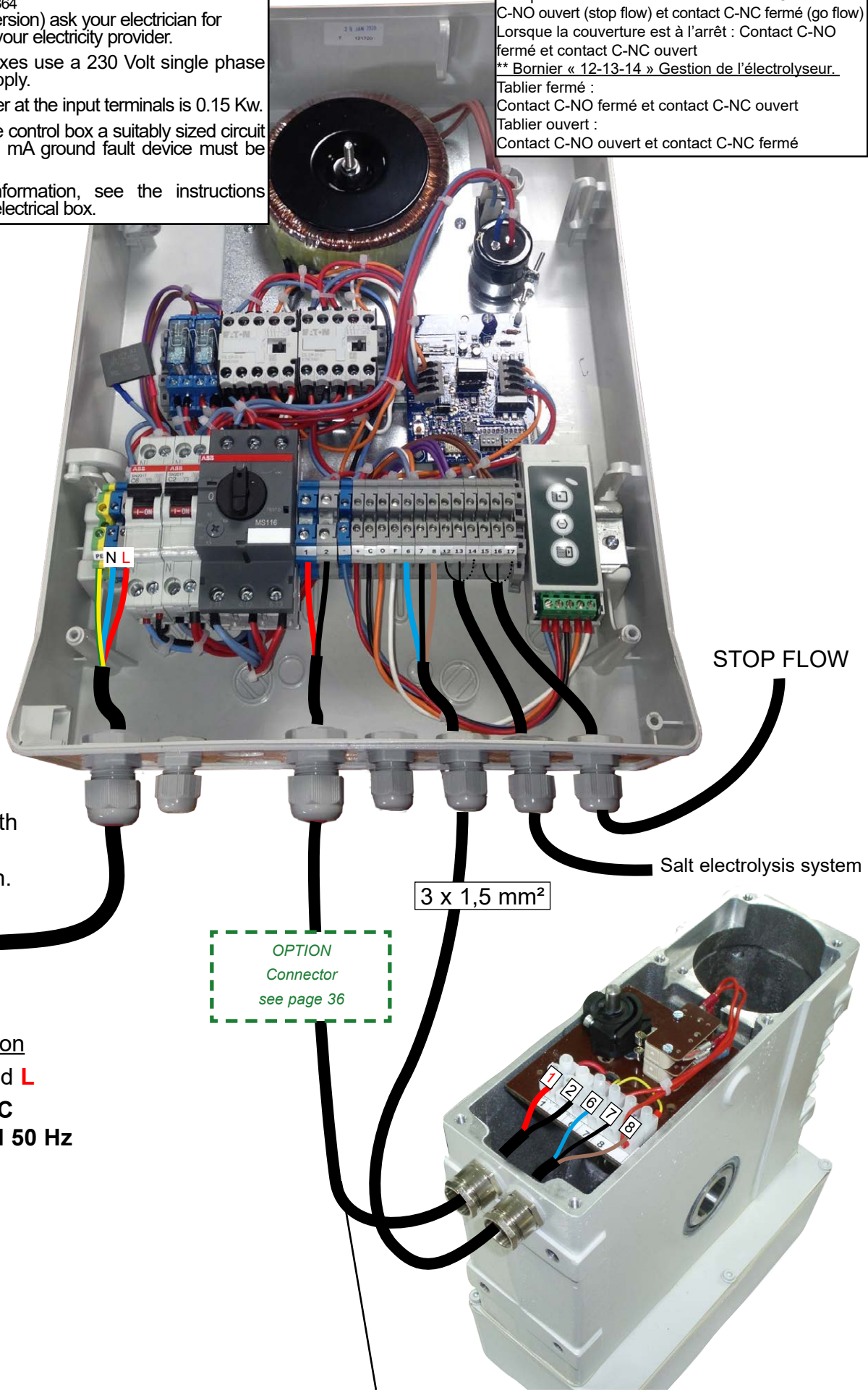

Circuit breaker with a 30 mA protection.



**Connection**  
 Plug **N** and **L**  
**230 VDC**  
**monophased 50 Hz**

STOP FLOW

Salt electrolysis system

3 x 1,5 mm<sup>2</sup>

OPTION  
 Connector  
 see page 36

(U1000RO2V in a sheath)

2 x 4 mm<sup>2</sup> - up to 16 m in length.  
 2 x 6 mm<sup>2</sup> - from 16 to 25 m in length.

The electric control box must be fitted in a dry room.  
The installation must comply with the NF C15-100 standard, et CEI 60364 (Last applicable version) ask your electrician for advice or contact your electricity provider.  
All our control boxes use a 230 Volt single phase (50Hz) power supply.  
The required power at the input terminals is 0.15 Kw.  
Upstream from the control box a suitably sized circuit breaker with a 30 mA ground fault device must be provided.  
For additional information, see the instructions supplied with the electrical box.

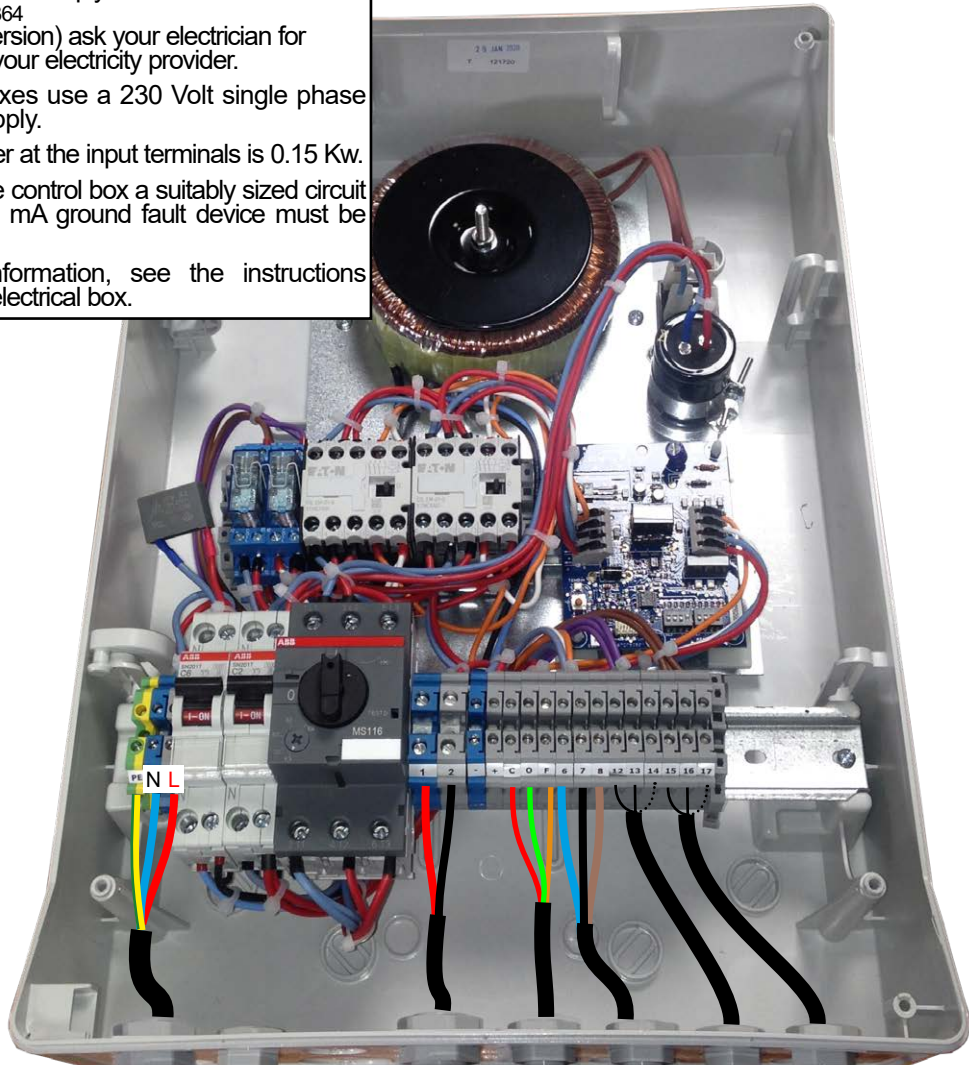

STOP FLOW

Circuit breaker with a 30 mA protection.



Connection  
Plug **N** and **L**  
230 VDC  
monophased 50 Hz

key switch



Salt electrolysis system

3 x 1,5 mm<sup>2</sup>

OPTION  
Connector  
see page 36

3 x 1,5 mm<sup>2</sup>

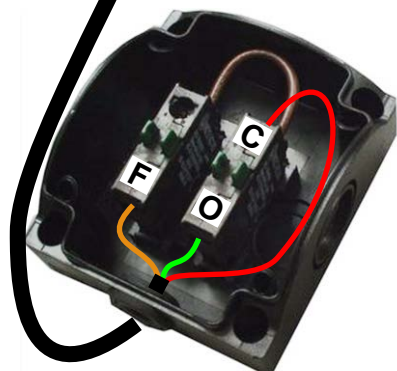

(U1000RO2V in a sheath)

2 x 4 mm<sup>2</sup> - up to 16 m in length.  
2 x 6 mm<sup>2</sup> - from 16 to 25 m in length.

The electric control box must be fitted in a dry room.  
 The installation must comply with the NF C15-100 standard. et CEI 60364 (Last applicable version) ask your electrician for advice or contact your electricity provider.  
 All our control boxes use a 230 Volt single phase (50Hz) power supply.  
 The required power at the input terminals is 0.15 Kw.  
 Upstream from the control box a suitably sized circuit breaker with a 30 mA ground fault device must be provided.  
 For additional information, see the instructions supplied with the electrical box.

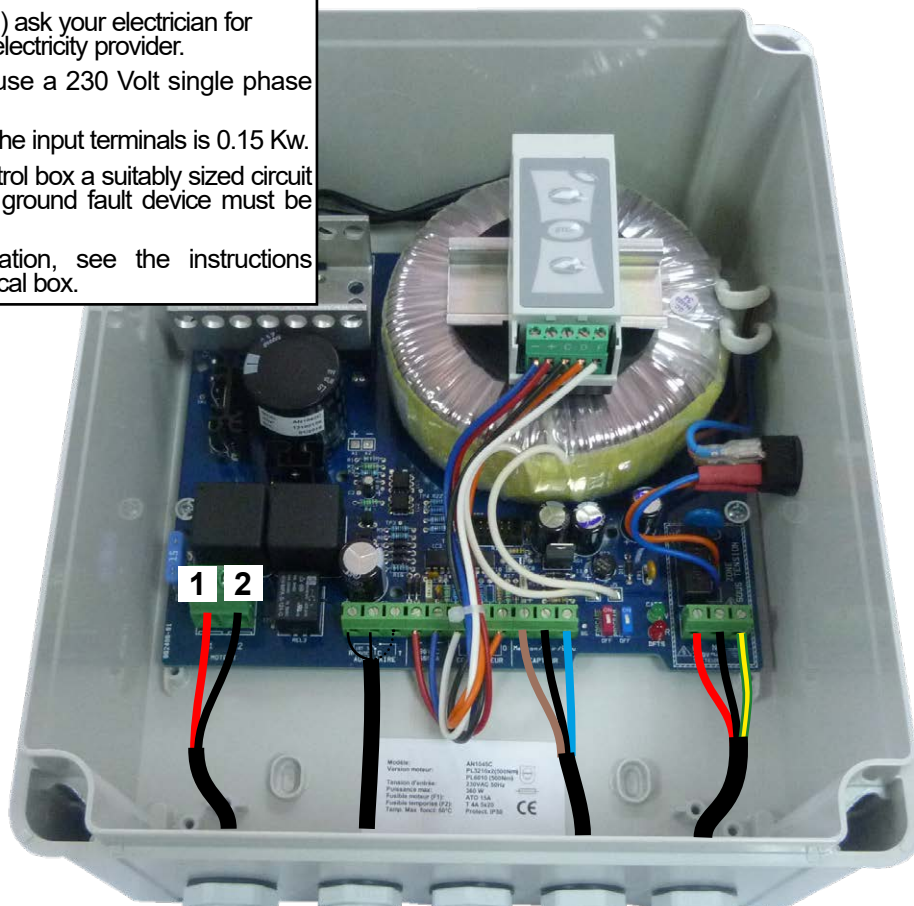

Connection  
**N and L plug**  
**230 Volts**  
**single**  
**phased 50 Hz**

3 x 1,5 mm<sup>2</sup>

*OPTION  
 Connector  
 see page 36*



(U1000RO2V in a sheath)

2 x 4 mm<sup>2</sup> - up to 16 m in length.  
 2 x 6 mm<sup>2</sup> - from 16 to 25 m in length.

The electric control box must be fitted in a dry room.  
 The installation must comply with the NF C15-100 standard, et CEI 60364 (Last applicable version) ask your electrician for advice or contact your electricity provider.  
 All our control boxes use a 230 Volt single phase (50Hz) power supply.  
 The required power at the input terminals is 0.15 Kw.  
 Upstream from the control box a suitably sized circuit breaker with a 30 mA ground fault device must be provided.  
 For additional information, see the instructions supplied with the electrical box.

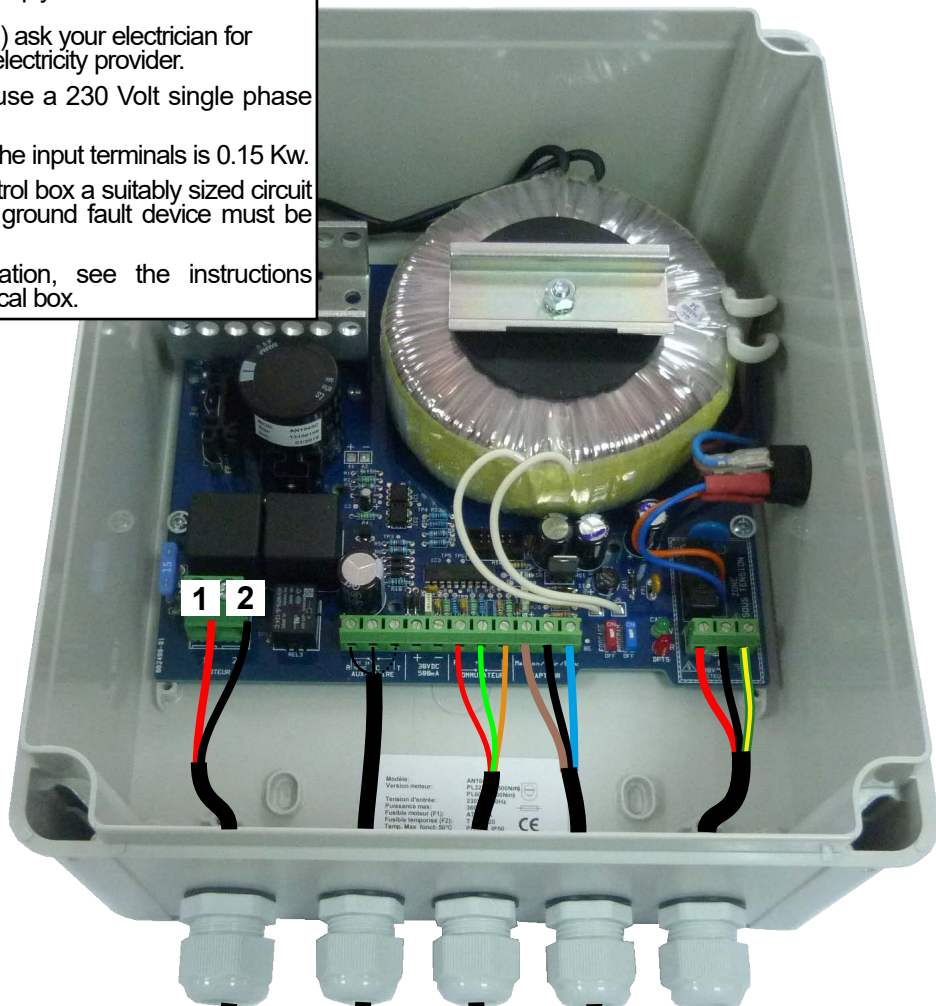

Connection  
**N and L plug**  
**230 Volts**  
**single**  
**phased 50 Hz**

3 x 1,5 mm<sup>2</sup>

### Key Switch



Its location must be in a place from which it is possible to check that no one enters the pool during the manoeuvre.

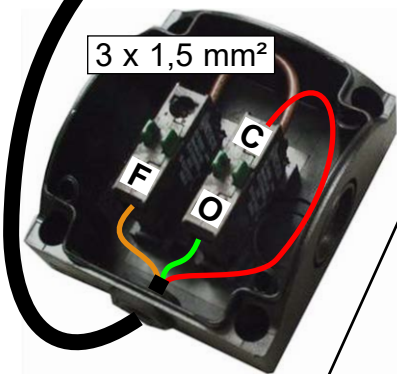

*OPTION  
 Connector  
 see page 36*



(U1000RO2V in a sheath)

2 x 4 mm<sup>2</sup> - up to 16 m in length.  
 2 x 6 mm<sup>2</sup> - from 16 to 25 m in length.



Located between the motor and the control panel, allows to unplug the motor without dismantling it  
For winterizing, replace the motor by the winterizing handle

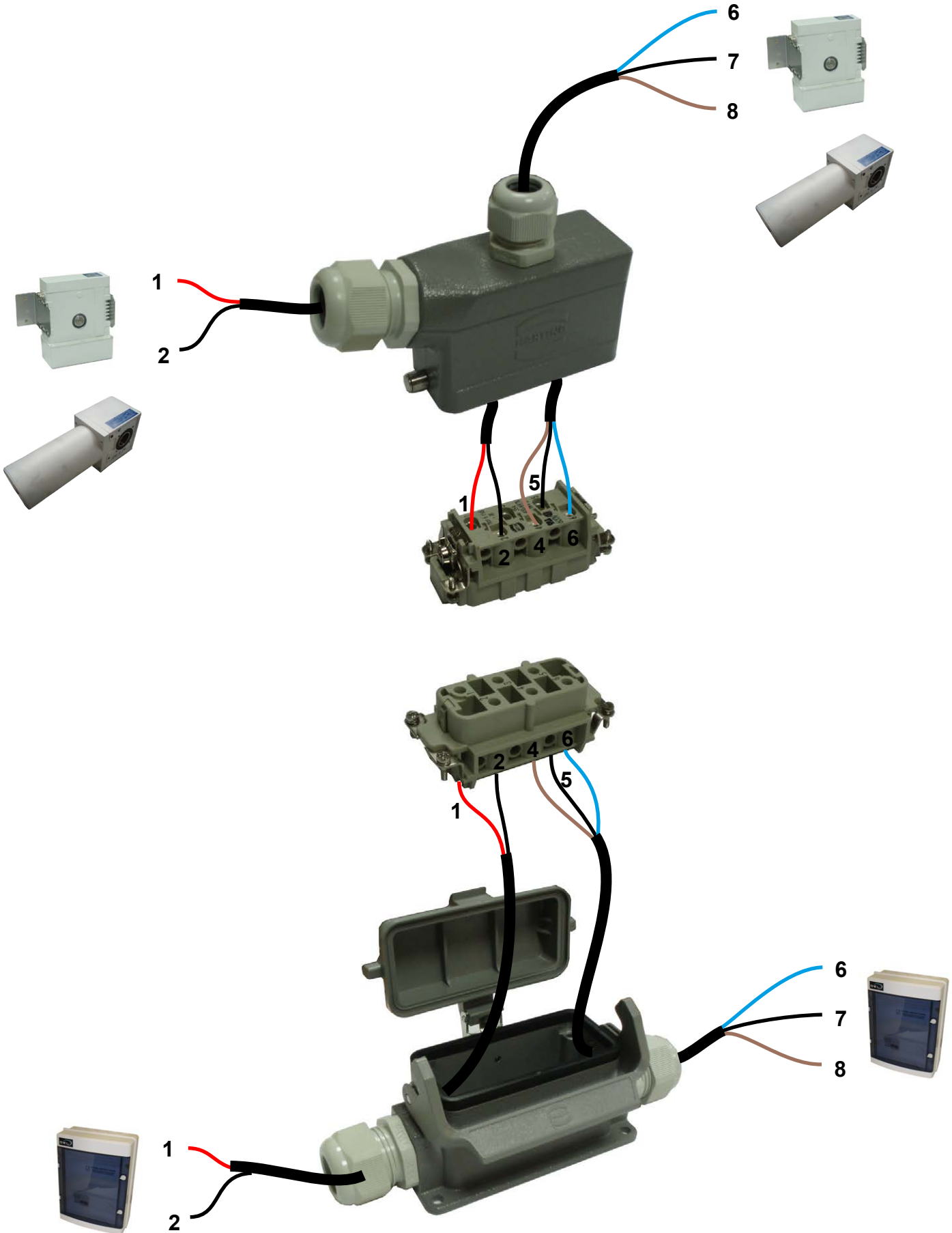

## WI-KEY INSTALLING THE CONTROL BOX



red / green flashing = emitter locked  
 Emitter unlocking procedure see «page 36»

The emitter must be located outside volume 0.

The distance between the emitter and the receiver must not exceed:

- 50 m in an obstacle-free zone.
- 25 m behind a basic wall.
- 15 m behind several walls or an especially thick wall.

we recommend checking emitter/receiver communication before fixing permanently.



- It must be located in a place from which it is possible to check that no one enters the pool during the manoeuvre.
- It is mandatory to install the locking «strip».
- Before fixing the control box, check that the emitter is communicating with the receiver.

The support must be attached to a fixed support

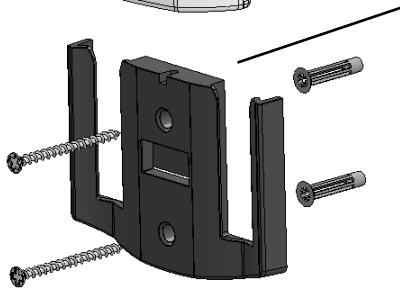

Closing

Opening



Keyboard lock

Stops the current action

**1 Checking of the automatic stop position**

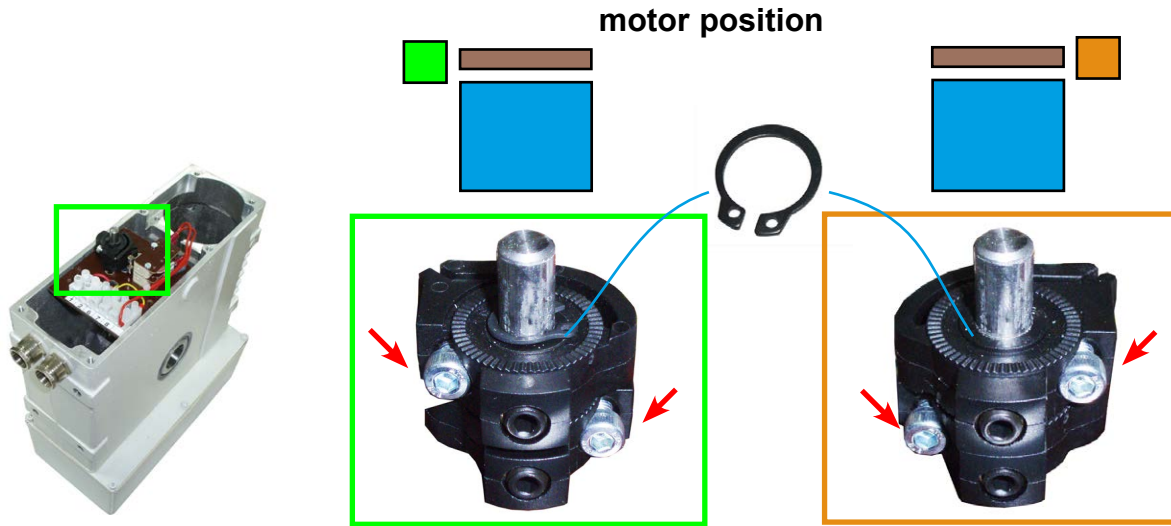

**2 Untighten the cam screws**

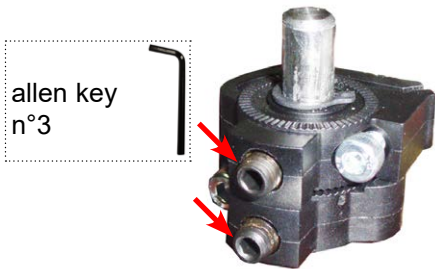

**3 Close the electronic card**

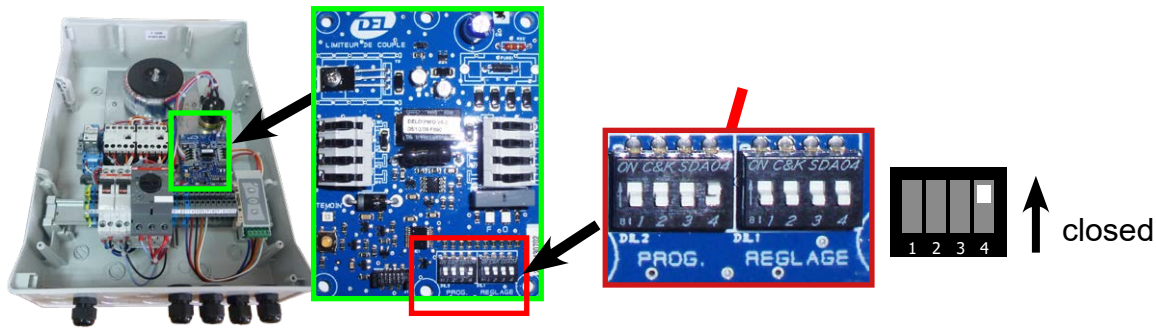

**4 Checking of the roll in roll out direction**

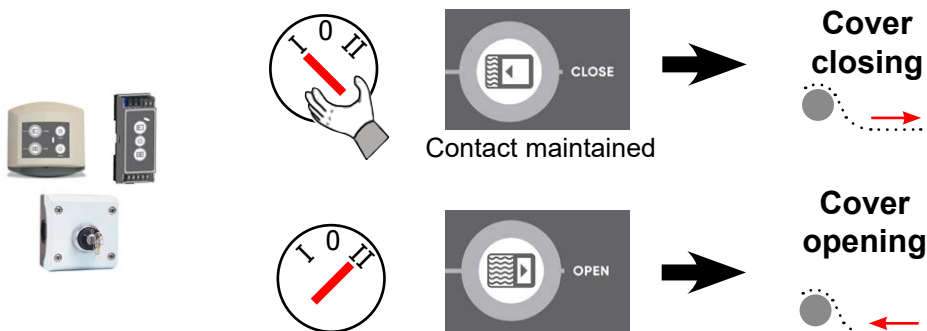

**if the control logic is incorrect, Check the wiring installation**

5

## Cover installation «open pool»



Adjust the position of the cover using the programme «open and closed»



Be careful to choose the right position, it will be the starting reference.

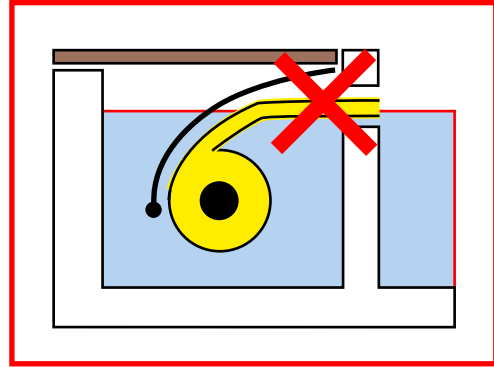
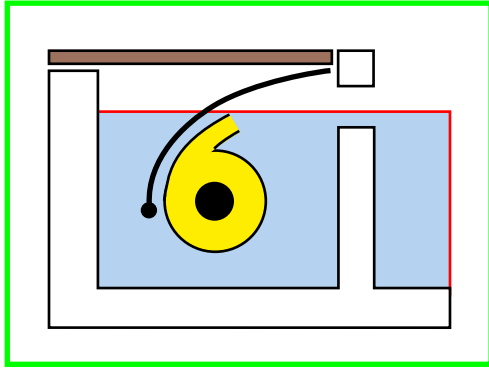

24

6

## Recording position «open pool»

Allen key  
n°3

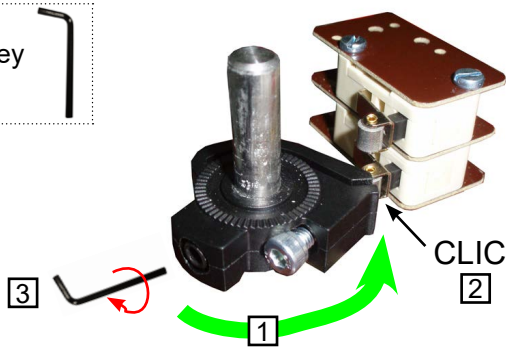

or

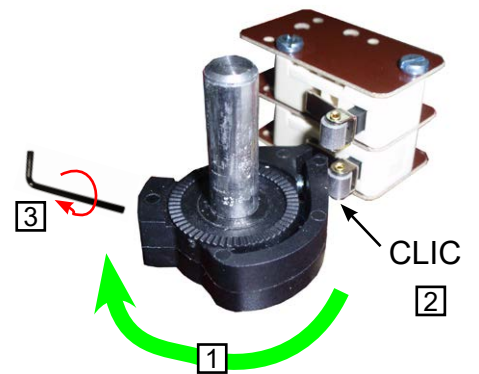



## Cover installation «closed pool»



Adjust the position of the cover using the programme «open and closed»

7

**Be careful : the last operation used must be a closing.**

«if you cannot close the cover, chek the electric control is correct and start the automatic stop ajustement procedure from the deginning. »

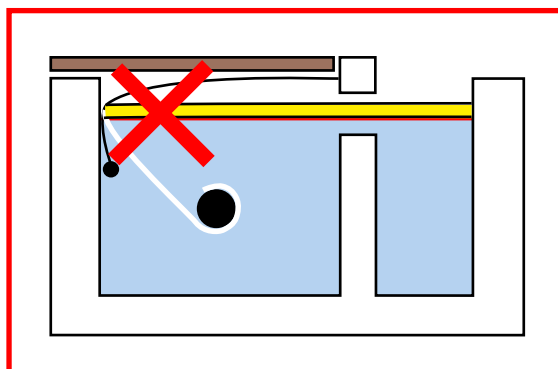
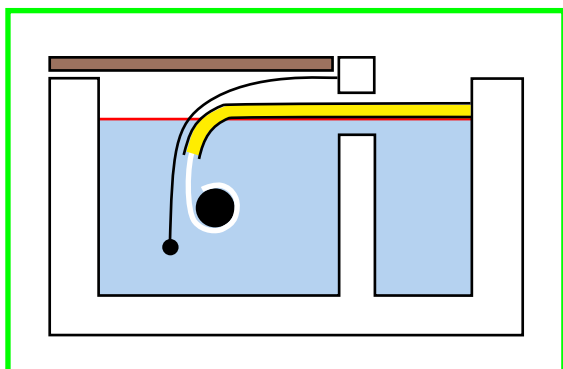

25

## Recording position «closed pool»

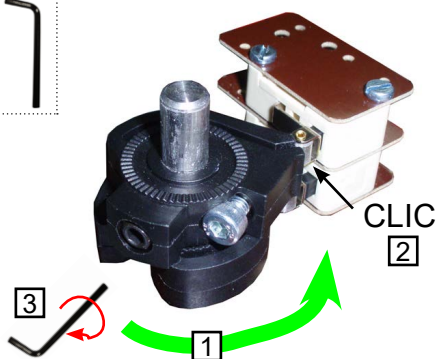
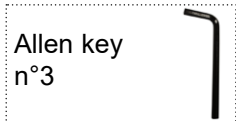

or

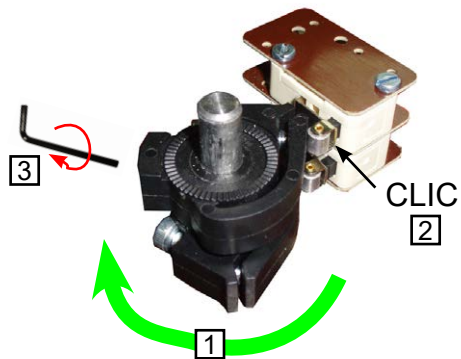

8

## Automatic stop adjustment

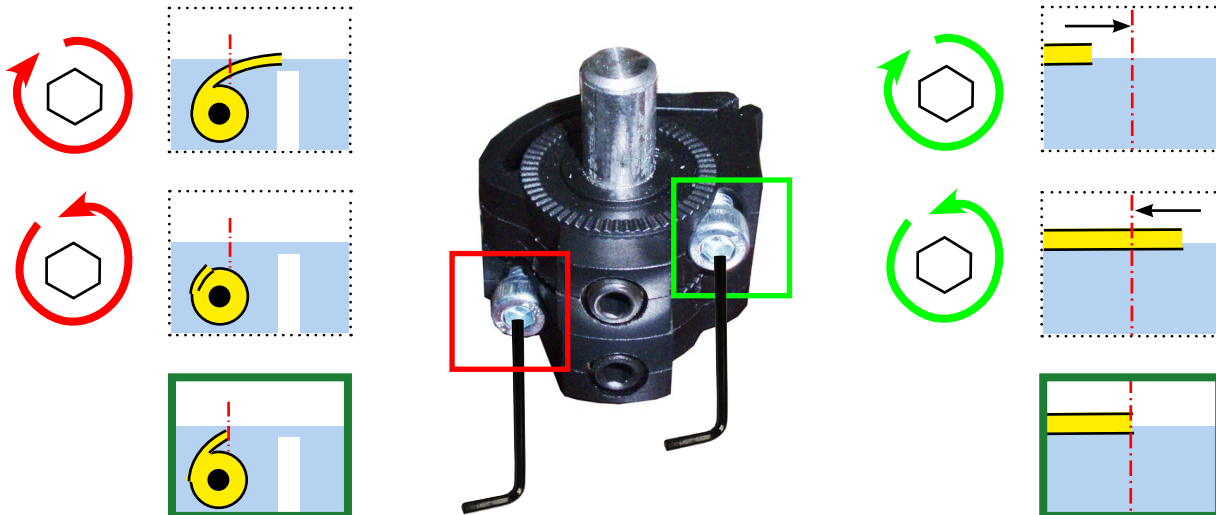

1

1 - Programme starting :



2

check up



Cover closing

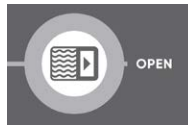

Cover opening

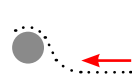

**if the control logic is incorrect, Check the wiring installation**

26

3

Cover installation «open pool»



Adjust the position of the cover using the programme «open and closed»

Be careful to choose the right position, it will be the starting reference.

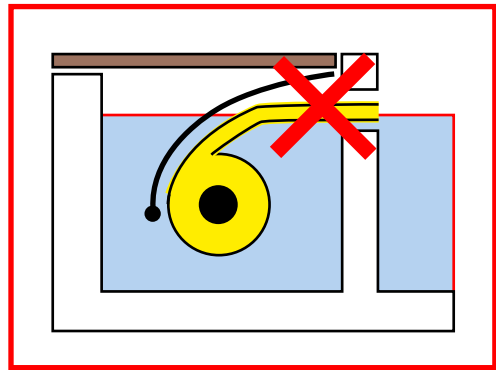
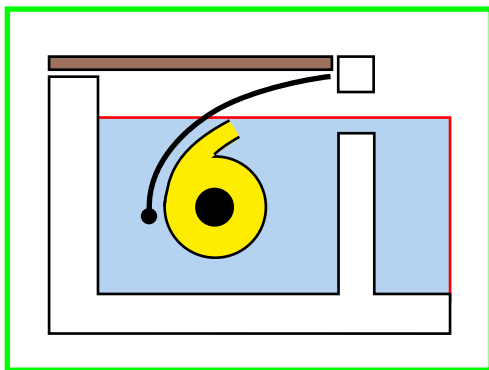

4

Recording position «open pool»

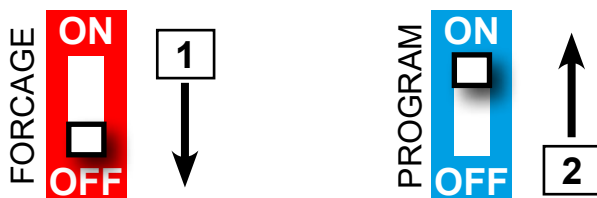

5

## Cover installation «closed pool»



Adjust the position of the cover using the programme «open and closed»

**Be careful : the last operation used must be a closing.**

«if you cannot close the cover, chek the electric control is correct and start the automatic stop adjustment procedure from the deginning. »

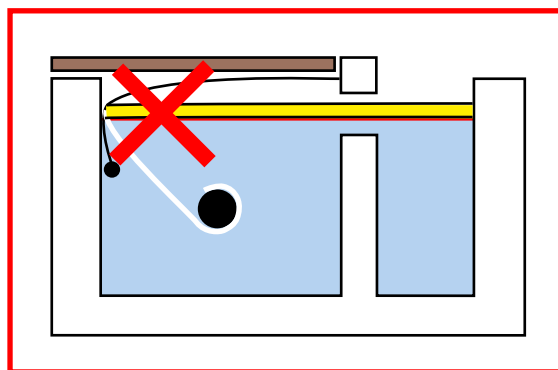
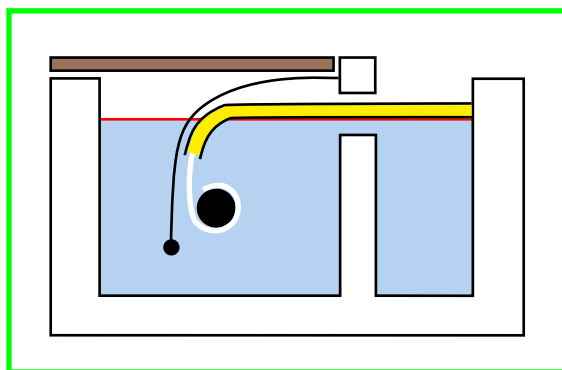

6

## Recording position «closed pool»



7

Automatic stop adjustment is over.

## TORQUE LIMITER DEVICE

### INFORMATIONS

The torque limiter device protects the system in case locking kits are unreleased during the opening.

In the event of excessive resistance during opening the sotor is automatically stopped.

#### Cases of torque limiter activation :

- Unreleased safety locking kit.
- cover rudding (coping stone...)
- Object wedged on / under the cover (cleaner ...).

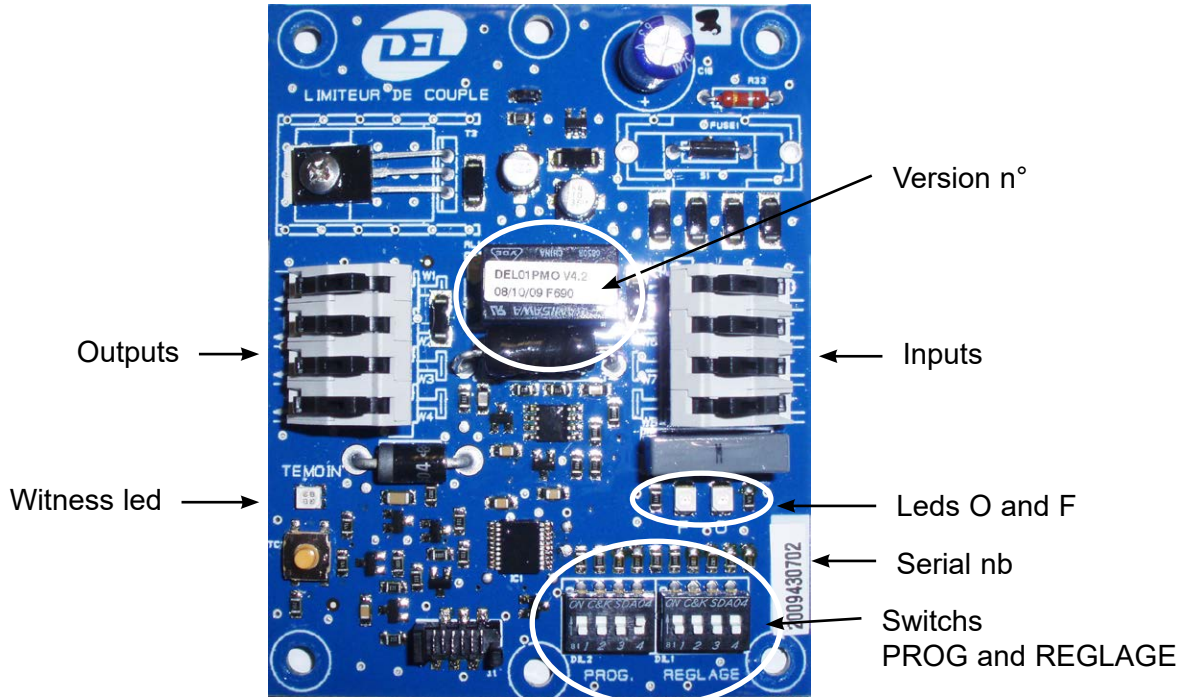

## TORQUE LIMITER DEVICE CONTROL CHECKING

- Close the electronic card



(Switch PROG)



- Check:

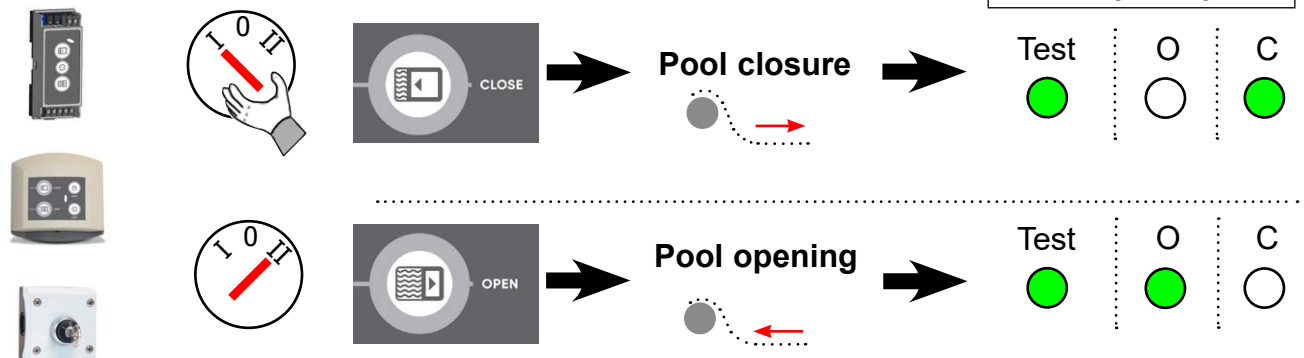

**If the key switch is incorrectly wired refer to page 15.**

## CARD ADJUSTMENT (SWITCH REGLAGE)



## CONTROL TIME ADJUSTMENT (SWITCH REGLAGE)

$L$  = pool length step unit included

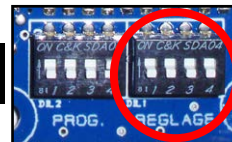

$L \leq 12$  m

$L > 12$  m



30 seconds

60 seconds

## ADJUSTEMENT OF THE SENSITIVITY (SWITCH PROG)

$l$  = pool width

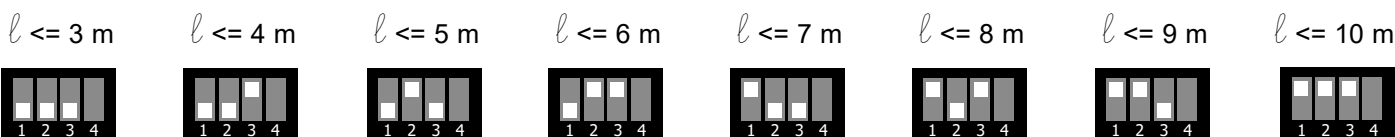

← maximum sensitivity ————— minimum sensitivity →

## ACTIVATION (SWITCH PROG)



Open



**If you do not activate the torque limiter device, serious damages might happen on the motor, the electric control box, the slats, and the guarantee might not be applicable.**

## IMPORTANT

Contact maintained more than 3 secs  
= The next opening will be protected



+ 3 seconds

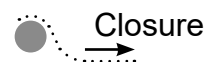

Contact maintained less than 3 seconds  
= The next opening will not be protected



- 3 seconds

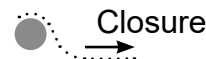

## TESTER

A - Block the cover by hand or with safety kits and open the cover.

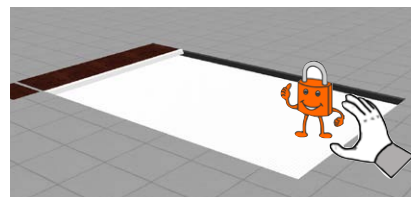

**=> The motor is automatically stopped**  
(If necessary adjust the sensitivity of the switch activation)



*in the event of an unexplained activation, reduce the sensitivity level by selecting the setting for the next width up.*

Activated card	Witness	
	O	F
Opening, control in progress		
Opening without control		
Closing		
Protection ON		

The position of the fastener kits on the cover is indicated on the drawings shipped with the slats.

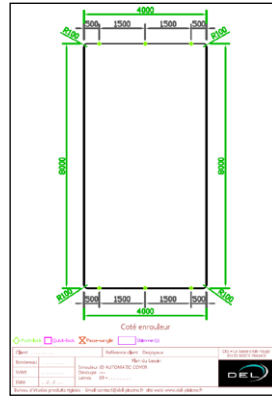

All changes to the positioning of the kits must comply with the rules given below. For other cases please contact us.

### 30 Positioning rules

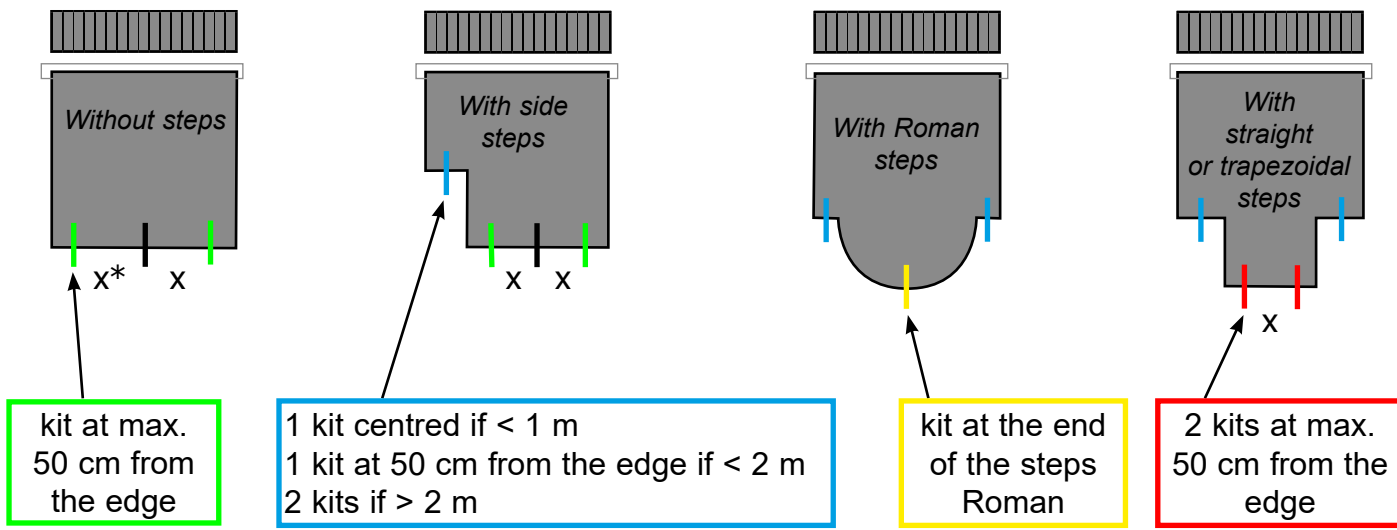

\* X must never exceed 2 m

**The Quick-lock fastener system cannot be used on cut off corners and curves, except at the end of Roman steps.**

**A water level regulator is mandatory**

**Insert mounted model**

For concrete and panel pools

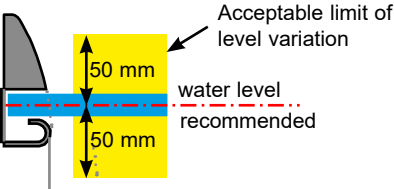
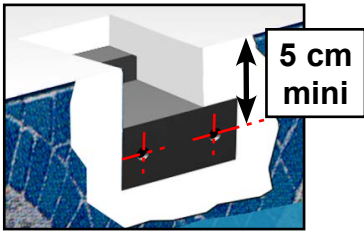

VBA TF Torx stainless steel A4 Ø6 x 50 wood screw

Hollow white Ø16 washer

Inserted part

Screw cap

**Hang mounted version**

For concrete and panel pools

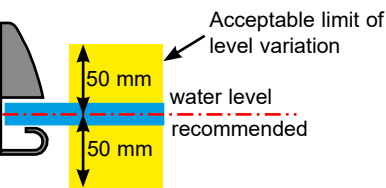
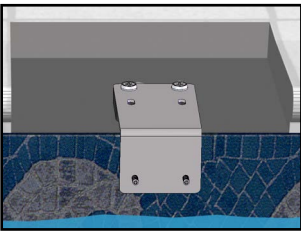

Ø8

VBA TF Torx stainless steel A4 Ø6 x 50 wood screw

Hang mount support

Hollow white Ø16 washer

INOX M6 washer

Cale 13 mm

Stainless steel nut A4 M10

Screw cap

Ø12 Nylon plug

**Surface mounted model**

For concrete and concrete block pools, as well as pools with wall thickness greater than or equal to 8 mm

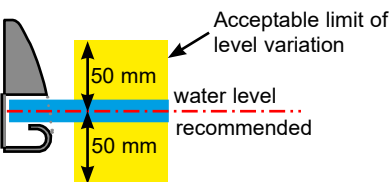
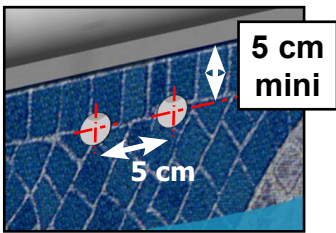

VBA TF Torx stainless steel A4 Ø6 x 50 wood screw

Hollow white Ø16 washer

Universal 8 x 40 plug

Screw cap

**Concrete**

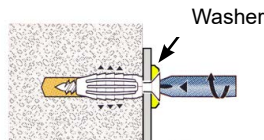

Once the resistance point has been reached stop screwing, this would deteriorate the fixture quality.

**Concrete block**

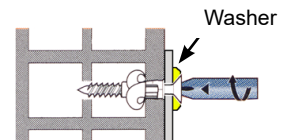

After reaching the resistance point, make 3 more turns of the screwdriver to finish tightening.

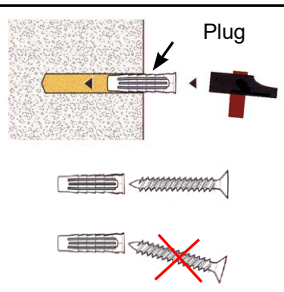

## INSTALLATION QUICK-LOCK

**A water level regulator is mandatory**

### Insert mounted model

For concrete and panel pools

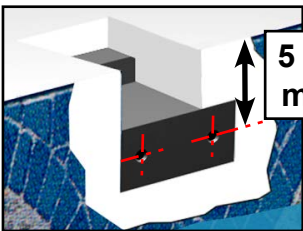

5 cm  
mini

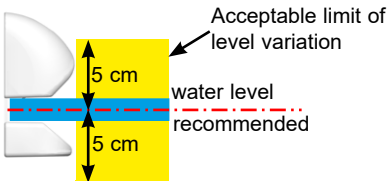

Acceptable limit of level variation

5 cm water level recommended

VBA TF Torx stainless steel A4 Ø6 x 50 wood screw

Hollow white Ø16 washer

Inserted part

adjustment

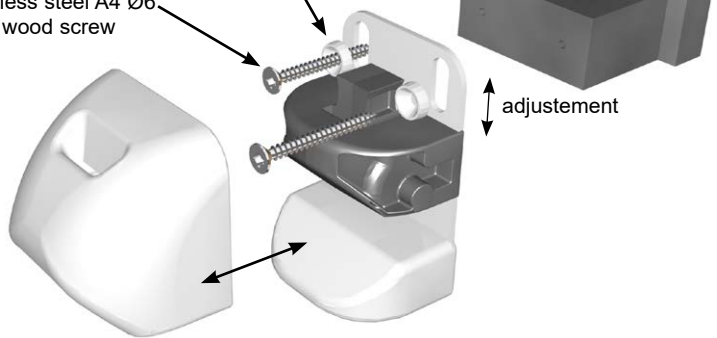

### Hang mounted version

For concrete and panel pools

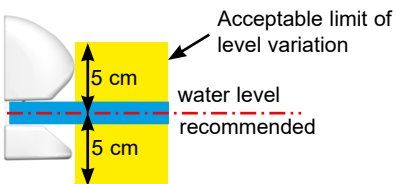
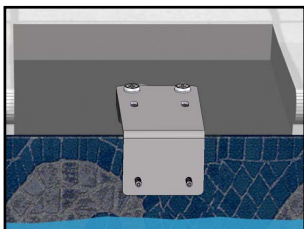

Acceptable limit of level variation

5 cm water level recommended



Ø8

VBA TF Torx stainless steel A4 Ø6 x 50 wood screw

Hollow white Ø16 washer

Hang mount support

Inox M6 washer

Stainless steel nut A4 M10

Cale 13 mm

adjustment

Ø12 Nylon plug

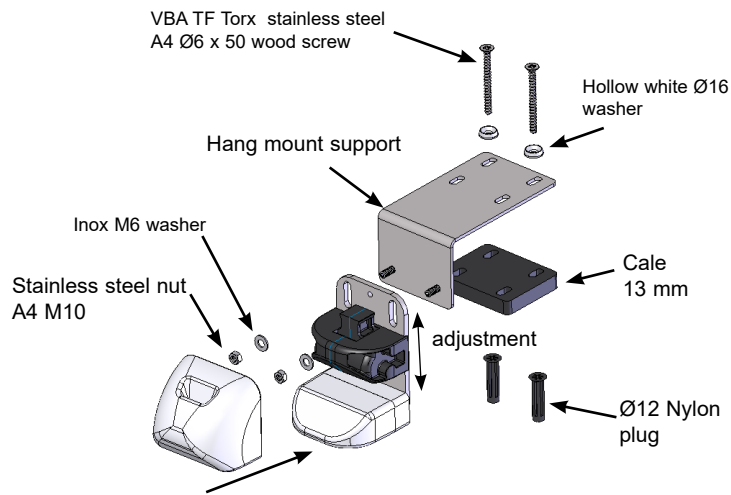

### Surface mounted model

For concrete and concrete block pools, as well as pools with wall thickness greater than or equal to 8 mm

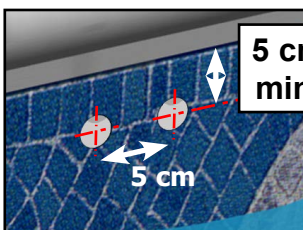

5 cm  
mini

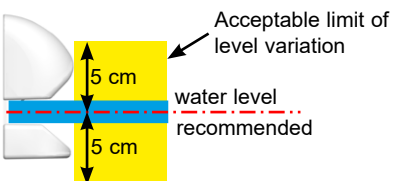

Acceptable limit of level variation

5 cm water level recommended

VBA TF Torx stainless steel A4 Ø6 x 50 wood screw

Hollow white Ø16 washer

Universal 8 x 40 plugs

adjustment

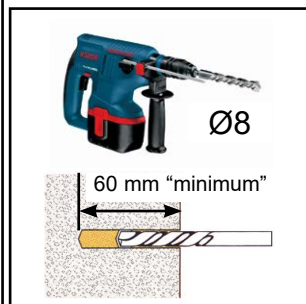
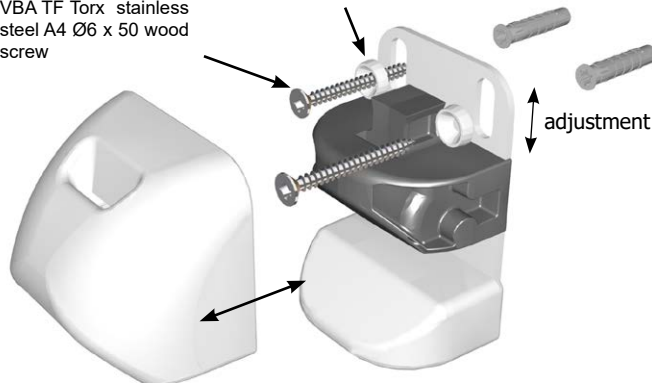

Ø8

60 mm "minimum"

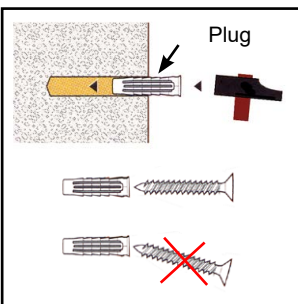

Plug

### Concrete

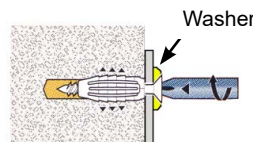

Washer

Once the resistance point has been reached stop screwing, this would deteriorate the fixture quality.

### Concrete block

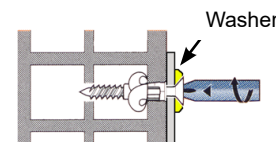

Washer

After reaching the resistance point, make 3 more turns of the screwdriver to finish tightening.



## A water level regulator is mandatory

### Insert mounted model

For concrete and panel pools

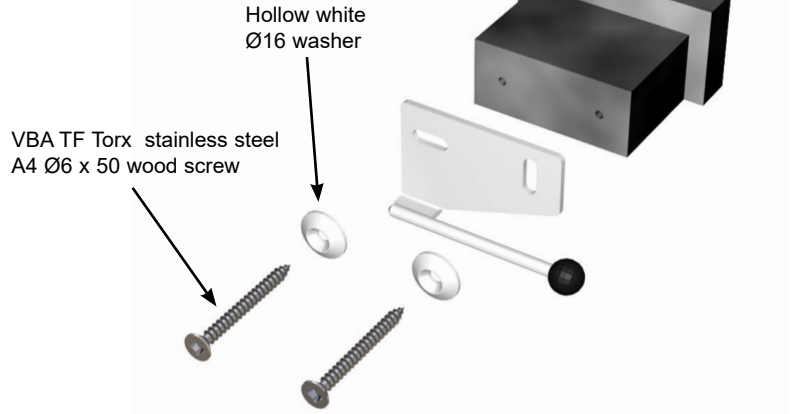
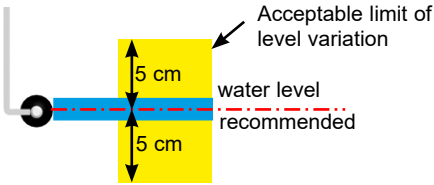
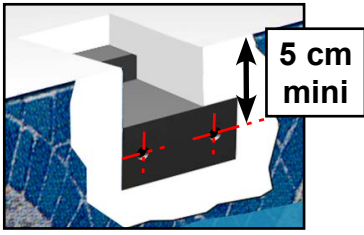

### Hang mounted version

For concrete and panel pools

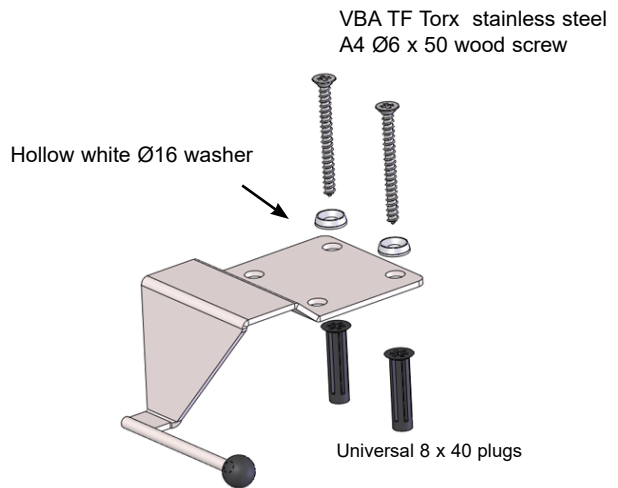
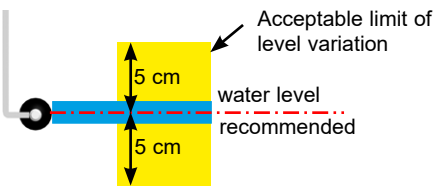
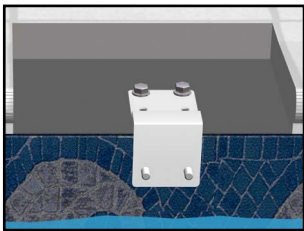

### Surface mounted model

For concrete and concrete block pools, as well as pools with wall thickness greater than or equal to 8 mm

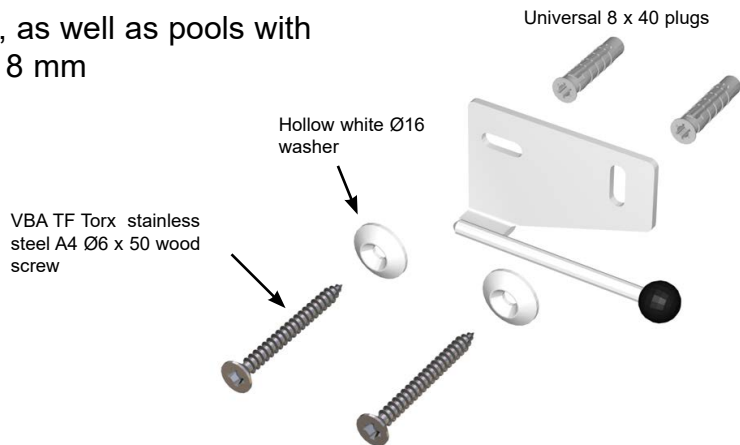
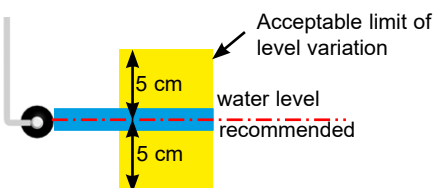
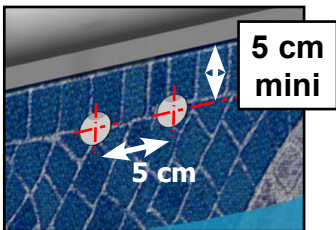

### Concrete

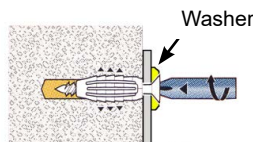

Once the resistance point has been reached stop screwing, this would deteriorate the fixture quality.

### Concrete block

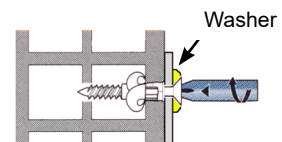

After reaching the resistance point, make 3 more turns of the screwdriver to finish tightening.



60 mm "minimum"

Plug

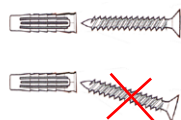

## INSTALLATION OF THE STRAP-HOLDER ANCHOR EYEBOLT

### Eyebolt for concrete beach



The head of the eyebolt must be higher than the beach surface

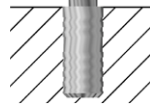

**Do not force the eyebolt into a drill hole of a smaller diameter than this**

### Eyebolt for wooden beach

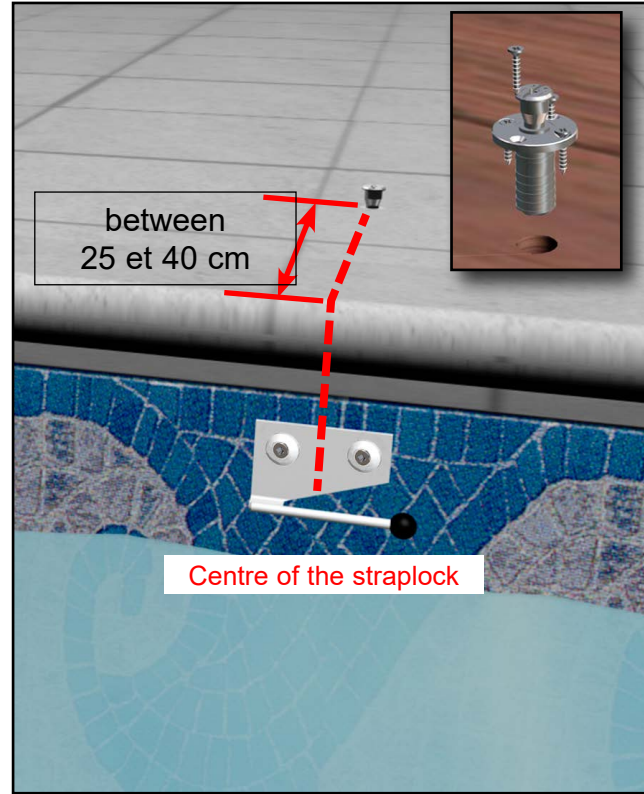
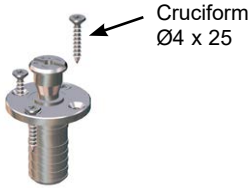

## INSTALLATION OF THE STRAPLOCK STRAP

34

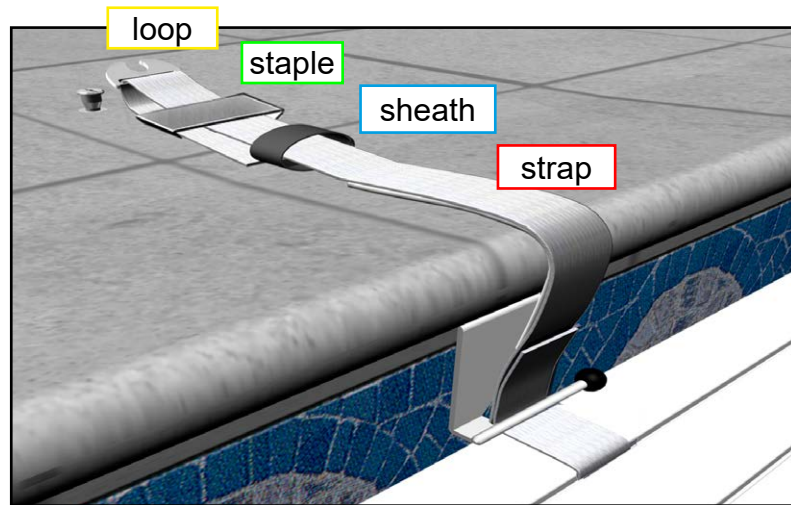
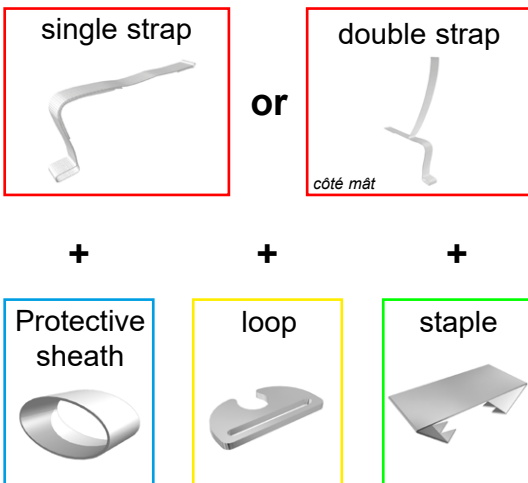

**Stretch the strap**  
*the cover must touch the underside of the straplock*

**Place the strap in position after the loop and crimp**  
*the 2 strap thicknesses pass inside the stable*

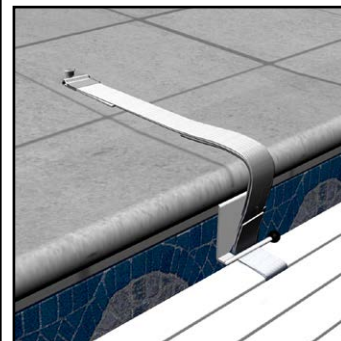
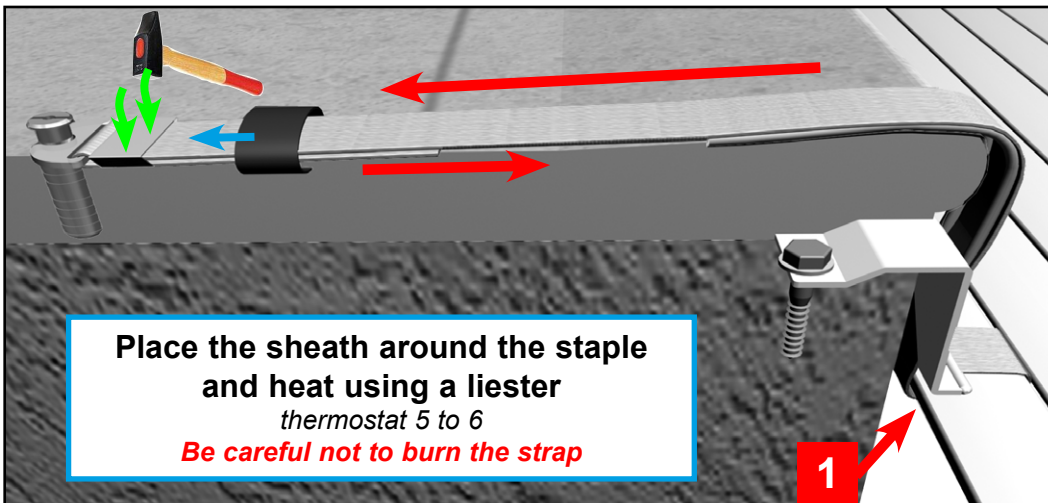



# OPENING/ CLOSURE OF THE POOL

**ALWAYS KEEP AN EYE ON THE POOL DURING OPENING OR CLOSING OPERATIONS.  
ALWAYS CHECK THAT THE POOL WATER LEVEL IS CONSTANT AND COMPLIANT WITH THE  
RECOMMENDATIONS ON THE INSTRUCTIONS**

- It is imperative not to halt the cover in an intermediate position, this can cause the risk of jamming a bather's body under the cover casing, if a bather uses the pool.
- When using an automatic cleaner under the cover, check that the hose does not affect the movement of the slats when opening and closing the cover.
- It is essential to remove floating objects when opening and closing the cover.
- Do not block the cover while extending or retracting.
- Do not activate the automatic cover when it is iced in.
- The opening or closure operation requires about 2 minutes for one person and about 3 minutes to lock or unlock the attachment kits.

## Opening: Always release the cover before starting the motor.

- Unlock all the fastening systems.
- Operate the open control.
- Stow the unlocking tools out of the reach of children.
- Lock the WI-Key command



## Closure:

- Operate the «contact maintained during closure» close control
- Lock all the fastener systems.
- Stow the unlocking tools out of the reach of children.
- Lock the WI-Key command



Never place products that were not designed for the purpose on slat covers, as this may warp the slats. Never leave objects on the cover (towels, buoys, etc.) because, in direct sunlight, the slats would be locally expanded and the warranty would be void. «Solar polycarbonate slats are incompatible with bromine treatments and treatments containing bromine. Do not put undiluted chemical products in direct contact with solar polycarbonate slats (e.g. algae protection products). It is essential to first carry out a test on a small surface area.»

## IMPORTANT

When closing the pool, it is essential to KEEP THE CONTROL PRESSED FOR AT LEAST 3 SECONDS. This is required to guarantee automatic obstacle detection the next time the cover is opened.

### LOCKING THE WI-KEY

- Press on for more than 3 seconds until the pilot flashes

= system locked

### UNLOCKING THE WI-KEY

- Press on and keep it pressed.
- At the same time: successively press the following 3 keys:
- The pilot remains on = emitter unlocked

## LIGHT INDICATORS

When you press a key, the light indicators below provide information on the Wi-key status (locked/unlocked), as well as the battery charge level.

	Green LED	----->	Wi-key unlocked
	Red/green flashing LED	----->	Wi-key locked
	Orange LED	----->	Battery level low
	Red LED	----->	Change the batteries (2 x LR03)

# LOCKING AND RELEASING PUSH-LOCK

## Locking

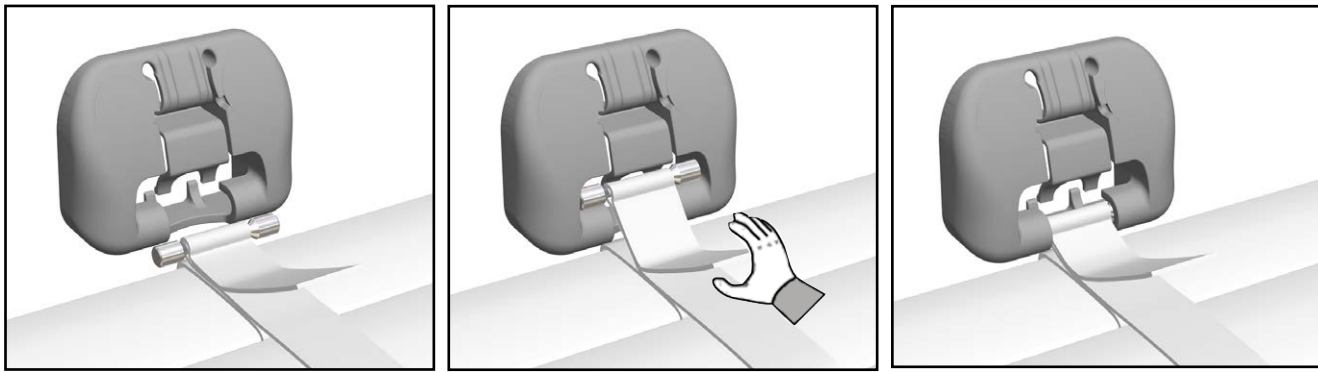

## Releasing

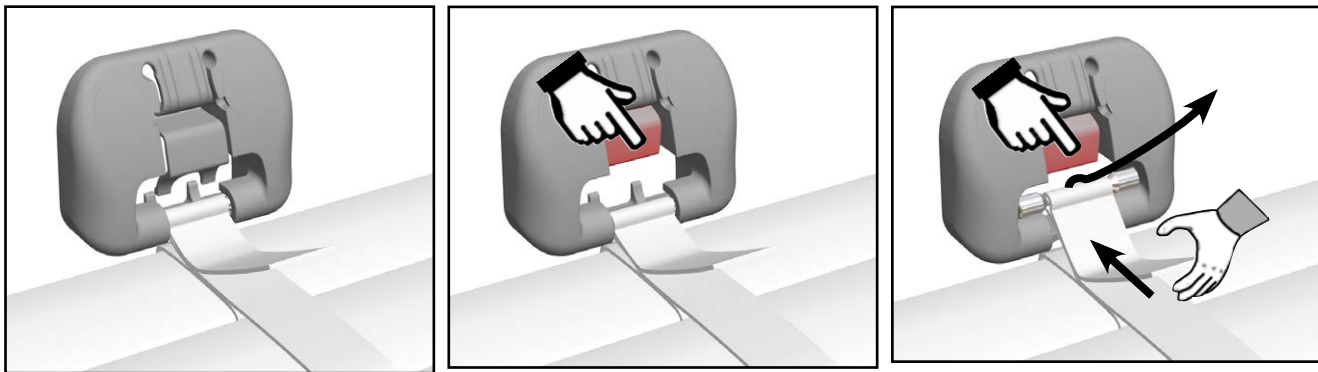

USE

# LOCKING AND RELEASING QUICK-LOCK

## Locking

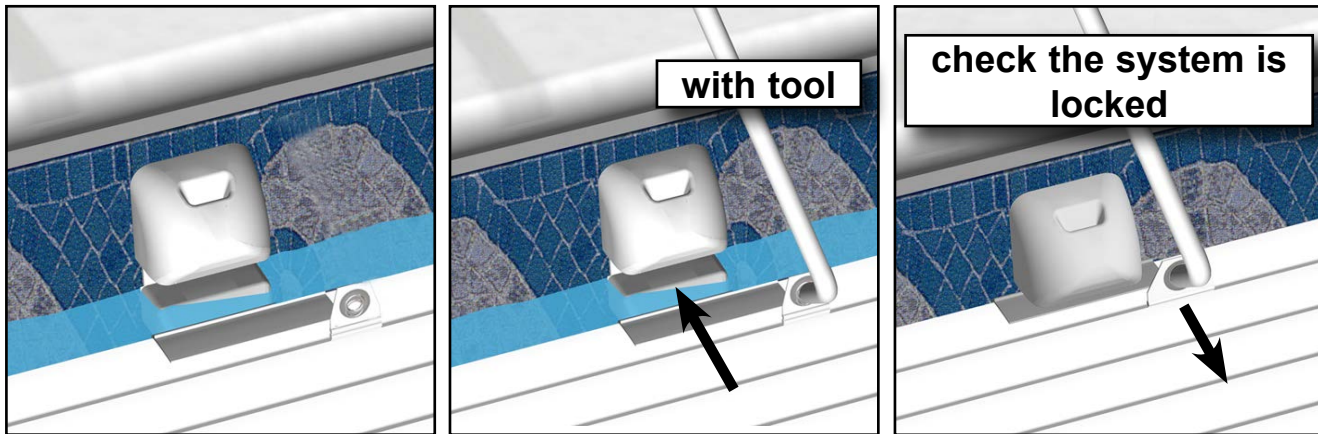

## Releasing

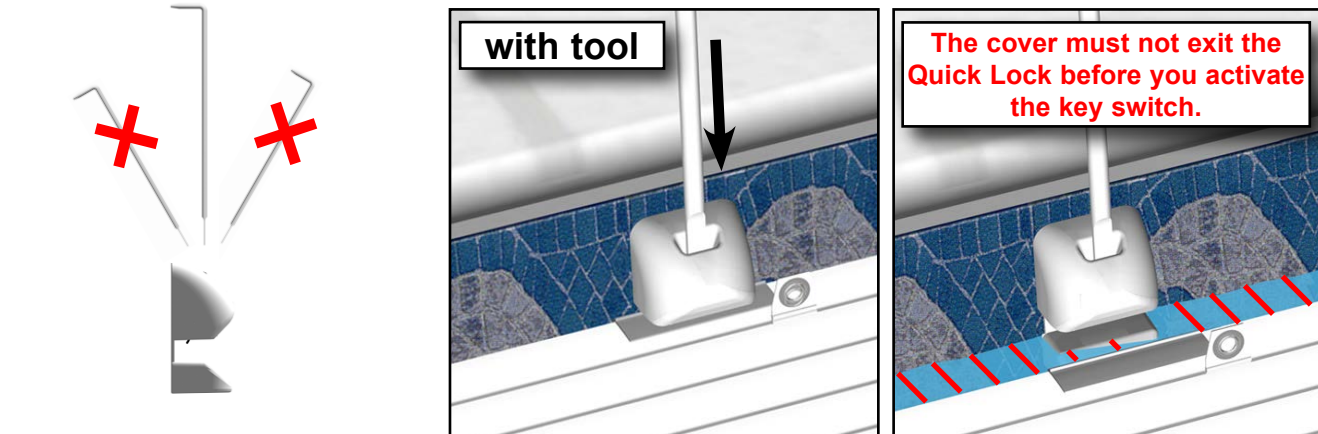

**Locking**

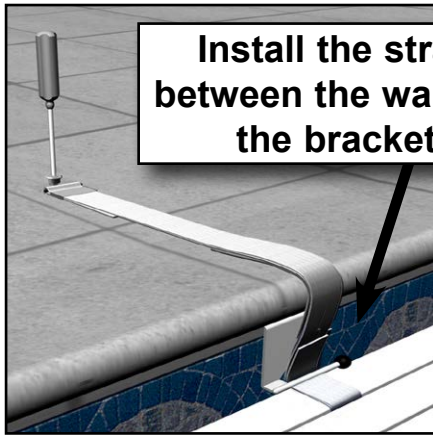

**Install the strap between the wall and the bracket**

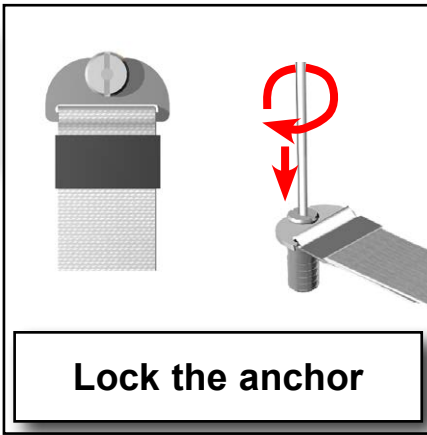

**Lock the anchor**

**The strap must be under tension and must be through the bracket**

**Releasing**

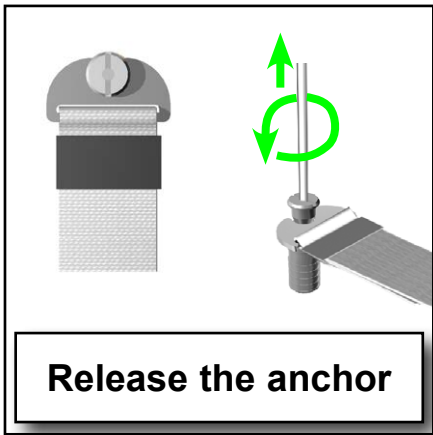

**Release the anchor**

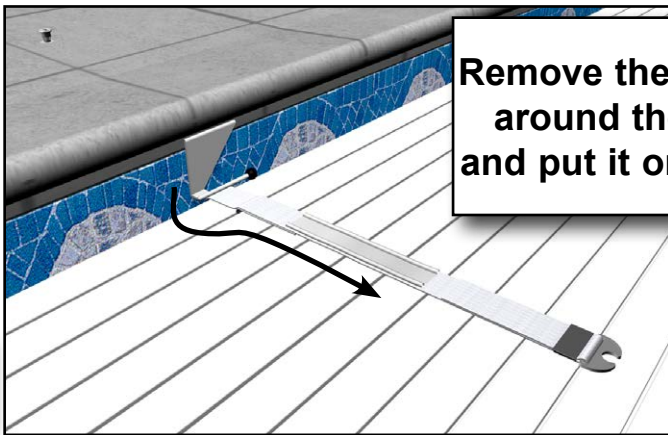

**Remove the strap from around the bracket and put it on the cover**

## WHAT TO DO IF THE SYSTEM STOPS DURING THE OPENING (TORQUE LIMITER ACTIVATED)

**1 - In the event of an explained stoppage during opening : (unreleased locking kits or other...)**

- Closed the cover **for more than 3 seconds**, until the tension of the cover is completely released.  
*(closed the cover for more than 3 seconds until the tension of the cover is completely released)*
- Remove causes of stoppage, e.g. release locking kits and open the pool again.

**2 - In the event of an unexplained stoppage :**

- closer the cover **between 1 and 3 seconds**.  
*(The next opening will not be protected by the system)*
- open the pool again.

*If there are repeated activations, decrease the sensitivity level..*  
- modify the adjustment if the sensitivity.(see page 19)

**If you do not activate the torque limiter device, serious damages might happen on the motor, the electric control box, the slats, and the guarantee might not be applicable.**

### LED MEANING (TORQUE LIMITEUR DEVICE)

Activated card		Temlion			O	F	Flashing LED
		●	○	○			
Activated card	Opening, control in progress	●	○	○	○	○	Flashing LED
	Opening without control	●	○	○	○	○	
	Closing	●	○	○	○	○	Permanent LED
	Protection ON	●	○	○	○	○	

### LED MEANING (CONROL BOX)

	Flashing LED		Permanent LED		Flashing LED		Permanent LED
--	--------------	--	---------------	--	--------------	--	---------------

CAPTEUR	INITIALISATION <i>LED flash alternatively</i>
DEFAULTS	
CAPTEUR	The motor is on <i>Regular slow flashing</i>
DEFAULTS	
CAPTEUR	Captor default (check connections and cables) <i>Permanent LED</i>
DEFAULTS	
CAPTEUR	Electronical default (check connections and cables / back to the factory) <i>Fast flashing</i>
DEFAULTS	
CAPTEUR	Software Default (readjust automatic stop) <i>Permanent LED</i>
DEFAULTS	

## WATER LEVEL OF THE POOL

The water level has to be maintained at the correct level to avoid damage and repeated activation of the torque limiter device. (For more comfort, use a water level regulator).

- If the water level is too high, it might come from leaves in the skimmer.
- If the water level is too low, it might cause malfunction of the cover.
- In case of hand rails, the pool must be equipped with a water level.

## FILTRATION

- The filtration must run continuously as soon as the water reaches 25°C, to avoid excessive heat under the slats.



## UPKEEP

- Clean your cover fully twice a year (start of season and start of winter). This is even more important if you have hard water. If this is the case, use a high pressure cleaner with warm water and a descaling product.
- Take the same care to clean the locking systems regularly. (Where fitted).
- It is advisable to inspect the whole system, in the event of abnormal force on the cover (eg. somebody falling)
- Check the straps connecting the cover to the roller / tube.
- Apply twice a year a «wood saturator or a treatment oil» (see catalogue DEL), on IPE and beech deckings.

## MAINTENANCE

- All work must be carried out by your installer who will contact the manufacturer if necessary.
- All spare parts must be originals.
- Inspect the whole cover for damage/wear and tear.
- It is necessary to check at the start of every season and in the case of possible accidents that the slats have not been visibly damaged in such a way as to affect the cover's operation (slats with cracks, holes, deformations, etc.). Change the slats or the whole cover if necessary.
- In both summer and winter, do not cover the slats with a debris winter cover. There is a risk of damage due to excess heat.
- Check the straps (sewing) and the anti-abrasion sheath. Replace the strap or sheath if necessary.
- Once a year, check the electrical connections.
- The «witness « flashes RED = change the control box battery

## WINTER

Close the cover and prepare the pool for winter, without lowering the water level. If you need to lower the water level, reel-in the cover around the tube and use a winter cover.

## Pairing -- delivered pre-paired

### 1 receiver

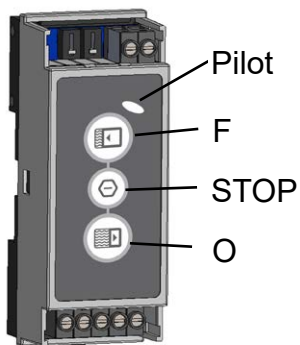

Press «STOP» and, without releasing it, press «O» for more than 3 seconds  
OK when the «pilot» flashes green.

an emitter must be paired within the next 30 seconds.

### 2 emitter

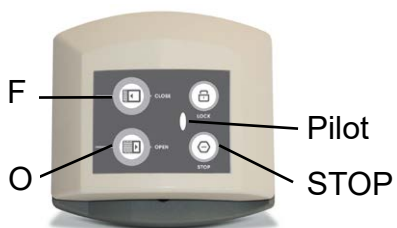



Press «STOP» and, without releasing it, press «O» for more than 3 seconds  
OK when the «pilot» flashes red / green.

another emitter must be paired within the next 30 seconds.

## Replacing the batteries



Be careful of the seal when re-assembling

	 Receiver	 Emitter
Manufacturer	DEL	DEL
Reference	Wikey receiver	Wikey emitter
Category	3 (EN 300220-1)	3 (EN 300220-1)
Range	50m in an obstacle-free zone	50m in a free zone
	25m through a concrete wall	25m through a concrete wall
Power supply	12 to 48 VDC 30mA max	Two 1.5V AAA batteries
Protection index	< IP40	< IP54

# WINTERIZING HANDLE – OPTION

Winterizing of the pool and keeping the pool in safety position.

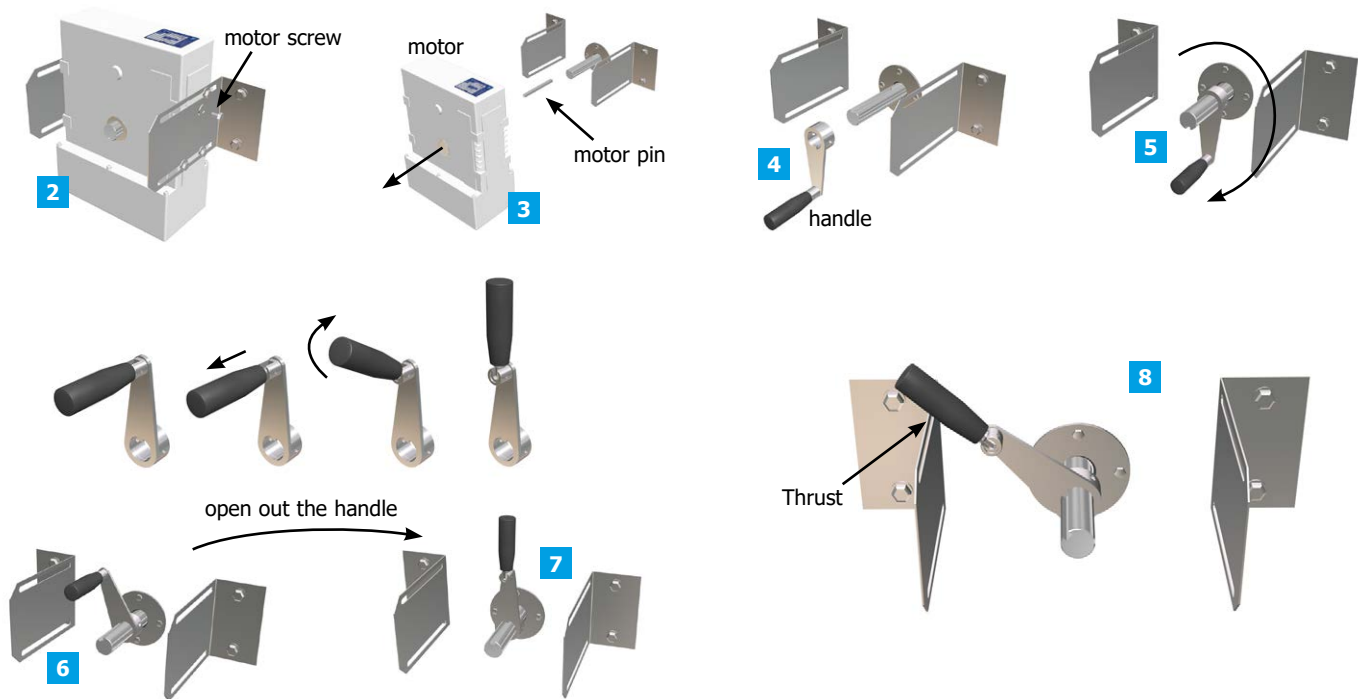

**DEAR CUSTOMERS,  
THANK YOU FOR CHOOSING A DEL AUTOMATIC COVER.  
PLEASE READ THE INSTRUCTIONS BELOW CAREFULLY.**

**·POOLS CAN BE A SERIOUS DANGER FOR CHILDREN. DROWNING CAN HAPPEN QUICKLY.**

## **S A F E T Y A D V I C E**

**WHEN CHILDREN ARE AROUND THE POOL THIS REQUIRES YOUR CONSTANT VIGILANCE AND ACTIVE SUPERVISION, EVEN IF THEY CAN SWIM.**

**THE PHYSICAL PRESENCE OF A RESPONSIBLE ADULT IS ESSENTIAL WHEN THE POOL IS OPEN.**

**LEARN LIFE SAVING TECHNIQUES.**

**REMEMBER AND POST THE EMERGENCY SERVICE NUMBERS CLOSE TO THE SWIMMING POOL.**

- FIRE BRIGADE: 18 (IN FRANCE) OR 112 FROM A CELL PHONE
- AMBULANCE : 15 (IN FRANCE)
- POISON CENTRE:

**·THIS COVER IS NOT A SUBSTITUTE FOR COMMON SENSE NOR FOR PERSONAL LIABILITY. THE PURPOSE OF THIS COVER IS NOT TO REPLACE THE VIGILANCE OF PARENTS AND/OR RESPONSIBLE ADULTS WHICH REMAIN THE ESSENTIAL FACTORS FOR THE SAFETY OF YOUNG CHILDREN.**

**·BE AWARE THAT SAFETY IS ONLY ACHIEVED BY A CLOSED COVER THAT IS LOCKED AND CORRECTLY INSTALLED IN COMPLIANCE WITH THE MANUFACTURER'S INSTRUCTIONS.**

**·COMPLY WITH THE WATER HEIGHTS DEFINED BY THE MANUFACTURER.**

**·THE COVER MUST SYSTEMATICALLY BE CLOSED DURING ALL ABSENCES FROM HOME, HOWEVER SHORT.**

**·MAKE SURE THERE ARE NO BATHERS OR FOREIGN BODIES IN THE POOL BEFORE AND DURING CLOSING.**

**·PLACE THE TOOLS REQUIRED TO OPEN THE COVER OUT OF THE REACH OF CHILDREN (THE KEY FOR EXAMPLE)**

**·THE OPENING ACTION OF THE MECHANISM SHOULD ONLY BE UNDERTAKEN BY A RESPONSIBLE ADULT.**

**·IT IS FORBIDDEN TO CLIMB ON, WALK OR JUMP ON A SAFETY COVER.**

**·IF A MALFUNCTION THAT PREVENTS THE CLOSURE AND SECURING OF THE POOL IS DISCOVERED, OR IF THE EQUIPMENT OR POOL ARE TEMPORARILY UNAVAILABLE, TAKE ALL NECESSARY MEASURES TO PREVENT YOUNG CHILDREN FROM ACCESSING THE POOL UNTIL THE COVER IS COMPLETELY REPAIRED.**

**·A CHILD CAN DROWN IN UNDER 3 MINUTES, NO TYPES OF PROTECTIVE MEASURE CAN REPLACE SUPERVISION AND VIGILANCE BY A RESPONSIBLE ADULT.**

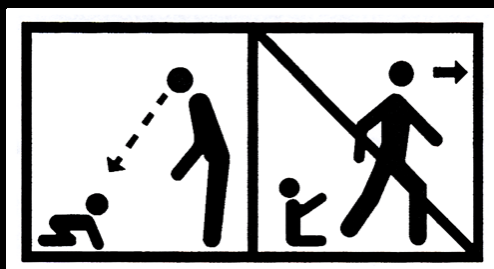

**SWIMMING POOL BUILDER**

**ZA La basse croix rouge 35530 Brécé -FRANCE- tel : + 33 (0)2 99 370 370**