

AUTOMATIC COVER

Rollinside

Roll-inside 1 side

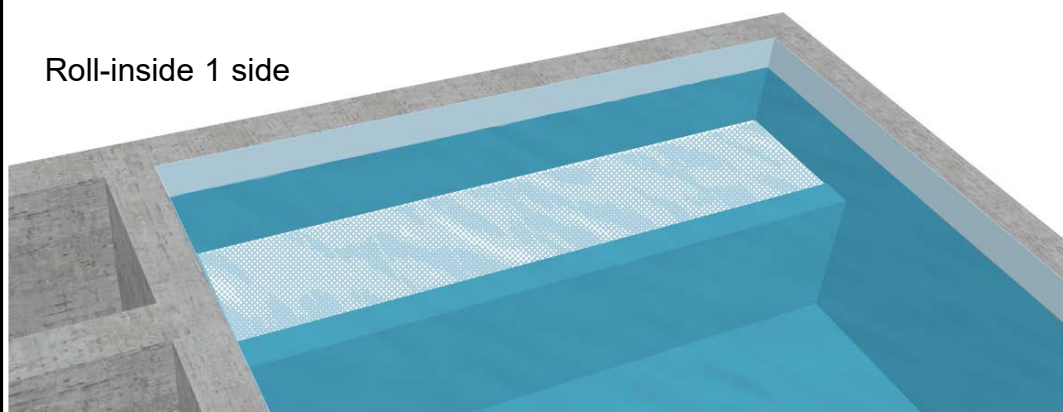

Roll-inside 2 sides

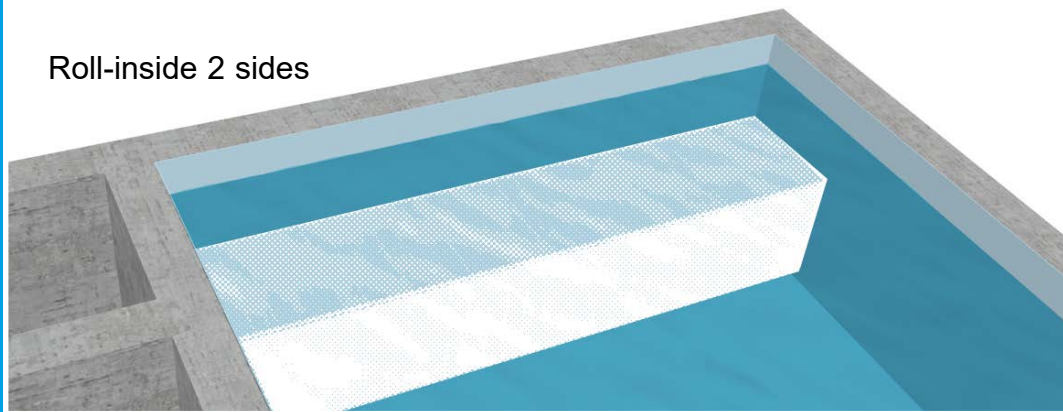

TECHNICAL INSTRUCTIONS

Installation / Use / Cleaning / Maintenance / Safety advice

DEL 
PREMIUM



**NOTICE TO BE GIVEN TO THE USER AFTER INSTALLATION IS COMPLETE
PLEASE READ CAREFULLY AND KEEP IN A SAFE PLACE.**

INFORMATION

For concrete, cellular concrete, full or hollow masonry pools with a reinforced membrane or tile waterproofing.

Roll-inside is an automatic immersed cover composed of mechanical parts and an underwater PVC cover pit.

The Roll-inside is available in several versions:

- Box work 1 side or 2 sides.
- Gear motor in a dry or immersed pit.
- Fixture mode: Using inserted parts or surface mounted on the façade.
- The mains supply comes from the electric control panel in the technical room
(Boxes compliant with electricity standards: C 15-100 / NF EN 60335 / NF EN 61000-6-3 / NF EN 55014-1)
- The automatic stops are adjusted in the motor or in the control panel (depending on the model)
- The key switch is located in a dry location with the pool in view.
- The cover is made of watertight floating cover slats.
- The closed pool can be secured with optional safety locking kits located on the width of the pool.
- The total operating gap between the walls and the slats is 70 mm.
- The vertical and horizontal covering consists of several 1 x 0.75m decking elements fixed on beams.

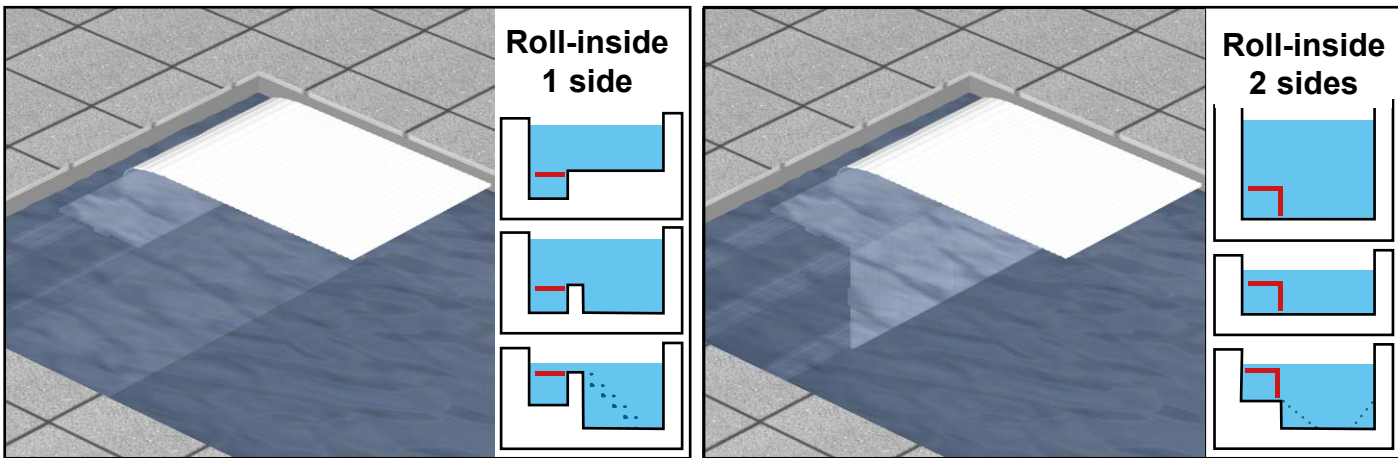

Unless otherwise specified by the manufacturer, immersion alarms are not compatible with DEL automatic covers.

TOOLS REQUIRED FOR ASSEMBLY (INSTALLATION – 2 PERSONS)

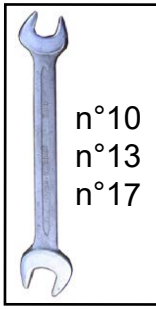

Roll-inside - for insert mounting - motorisation in a dry pit

DELIVERED PARTS

Parts to insert

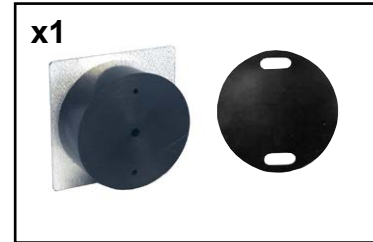
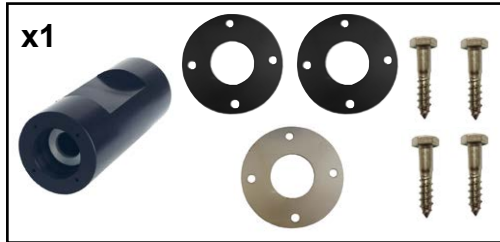
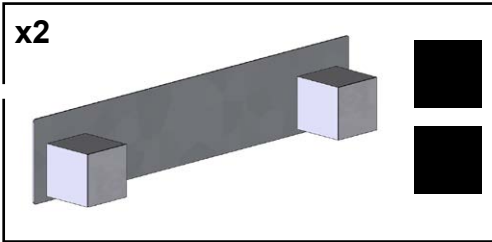

Mechanism

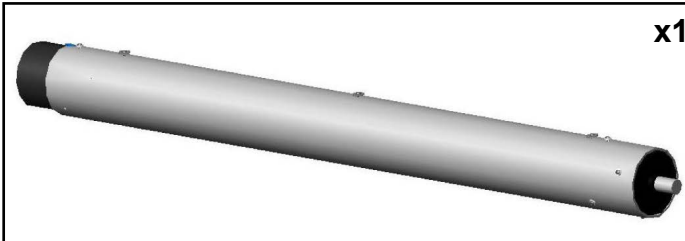

Counter-weight

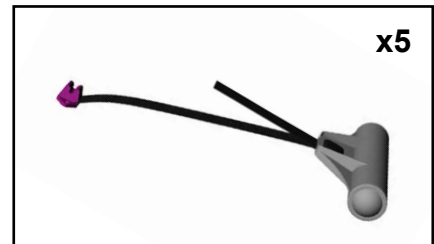

Mechanical fastener bag

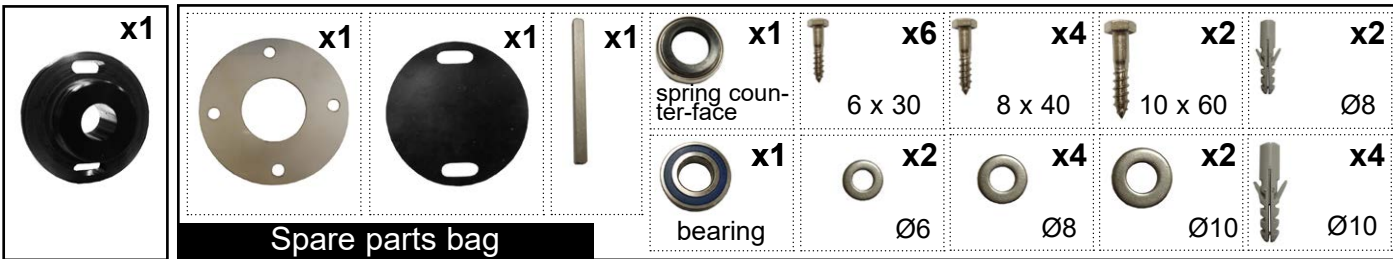

Beam support

For roll-inside 1 side

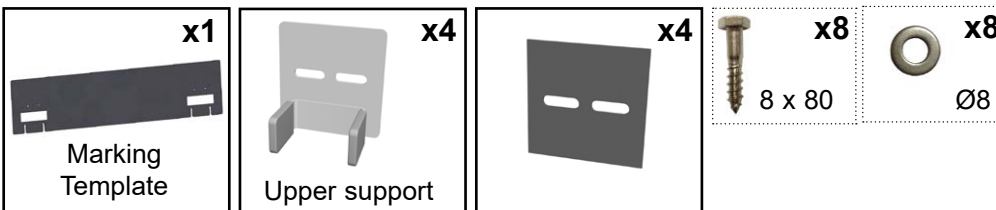

For roll-inside 2 sides

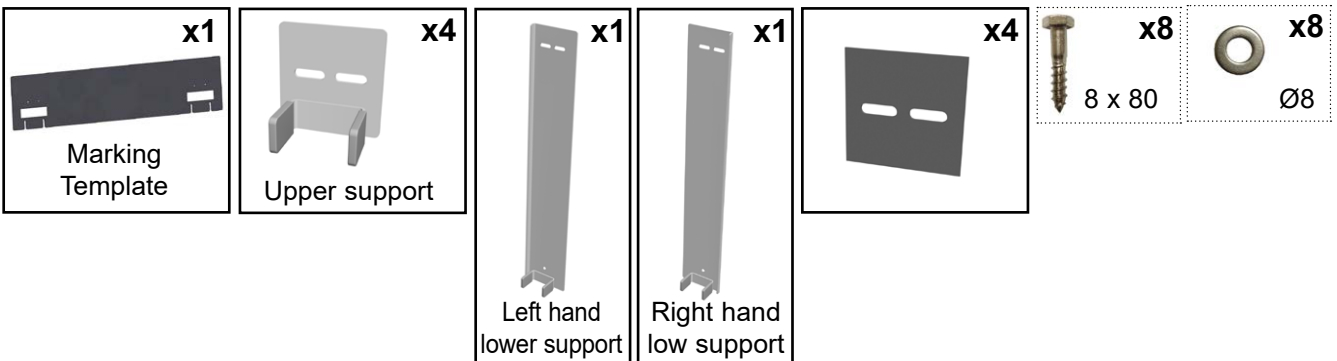

Beam

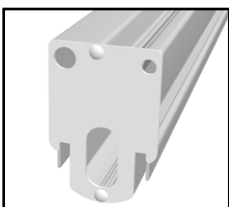

2 beams for roll inside 1 side
3 beams for roll-inside 2 sides

Gear motor with support



or



or



Electric box



Key-operator box



Wi-key



Decking

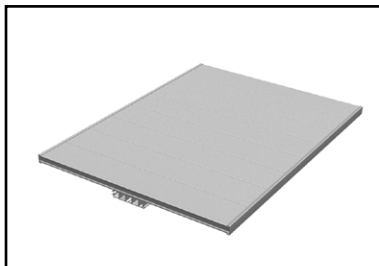

Slats



Fastening kits



PACKING LIST

e.g. for a 5 x 10 m pool with Ø3 m roman steps

Wall units:

For beam support: 1 box of 1 x 0.20 x 0.20 m -- 10 kg

For the mechanism (tube): 1 box of 0.30 x 0.20 x 0.20 -- 5kg

Mechanism (tube) :

1 box of 5 x 0.25m -- 40 kg

Installation kit + motor + control panel + weights + optional safety locking kit

1 box of 0.80 x 0.60 x 0.65 -- 45 kg

Beam support:

1 side : 1 box of 0.75 x 0.25 x 0.15 -- 4kg

2 sides : 1 box of 0.75 x 0.25 x 0.15 -- 10kg

The beams:

1 side : 2 box of 5.1 x 0.17 x 0.12 -- 60 kg

2 sides : 3box of 5.1 x 0.17 x 0.12 -- 90kg

Decking :

1 side : 1 pallet of 1.20 x 1 x 0.40 -- 40kg

2 sides : 1 pallet of 1.20 x 1 x 0.40 -- 70 kg

Slats :

5 box of 5.1 x 0.20 x 0.25 -- 250 kg

Total weight :

Roll-inside 1 side: 454 kg

Roll-inside 2 sides: 520 kg



Roll-inside - for insert mounting - tubular immersed motorisation

DELIVERED PARTS

Parts to insert

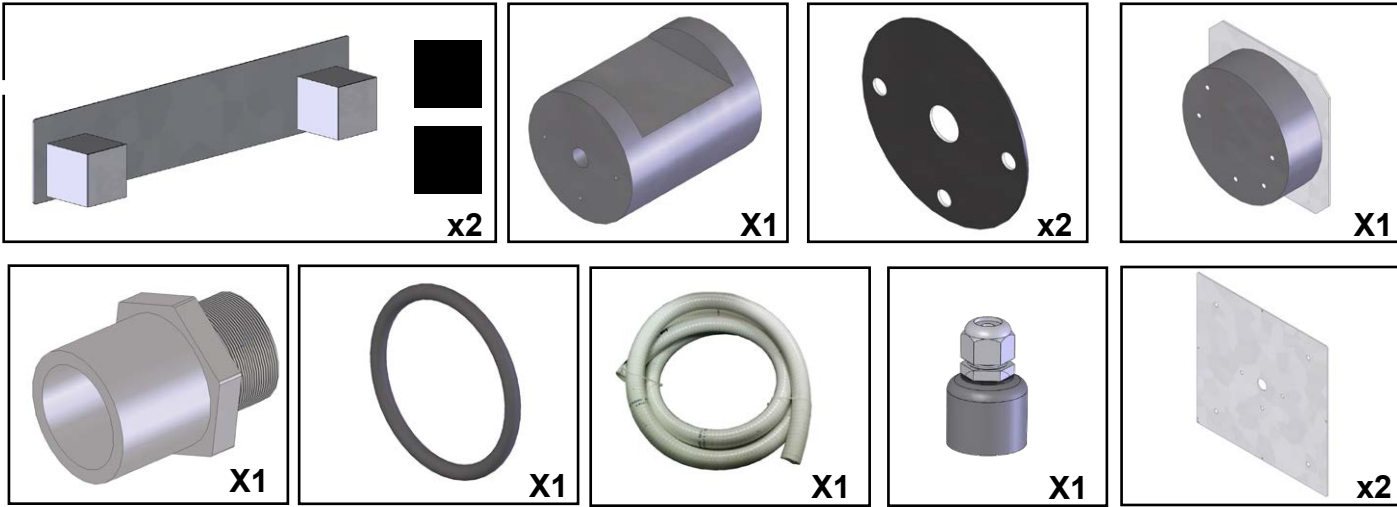

Mechanism

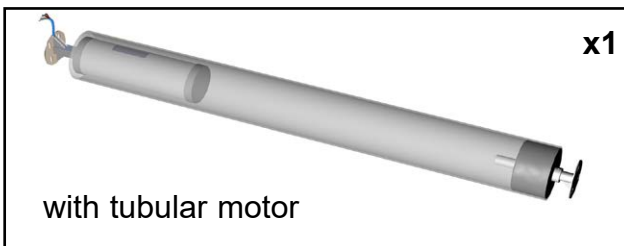

Counter-weight

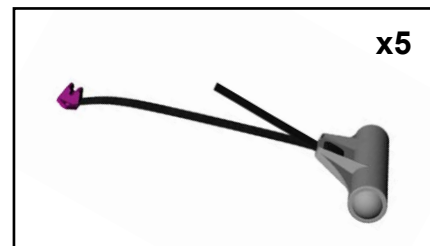

Mechanical fastener bag

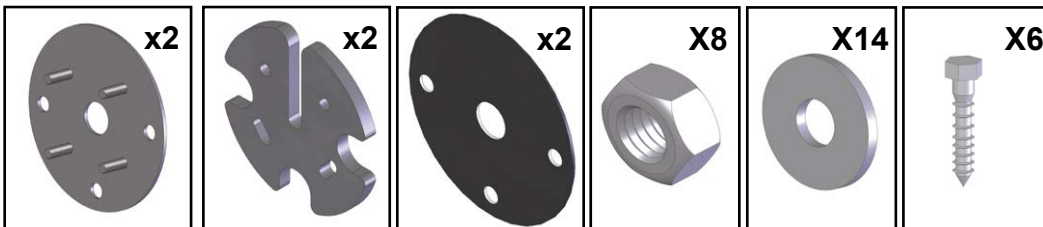

Beam support

For roll-inside 1 side

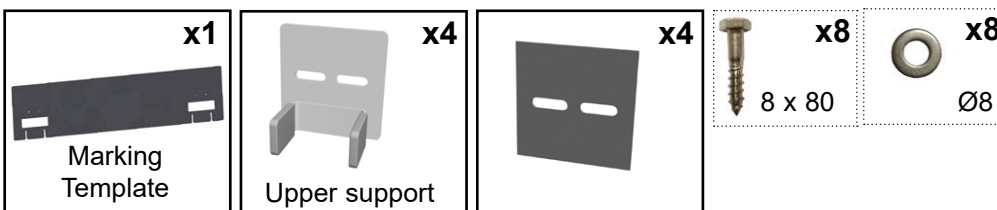

For roll-inside 2 sides

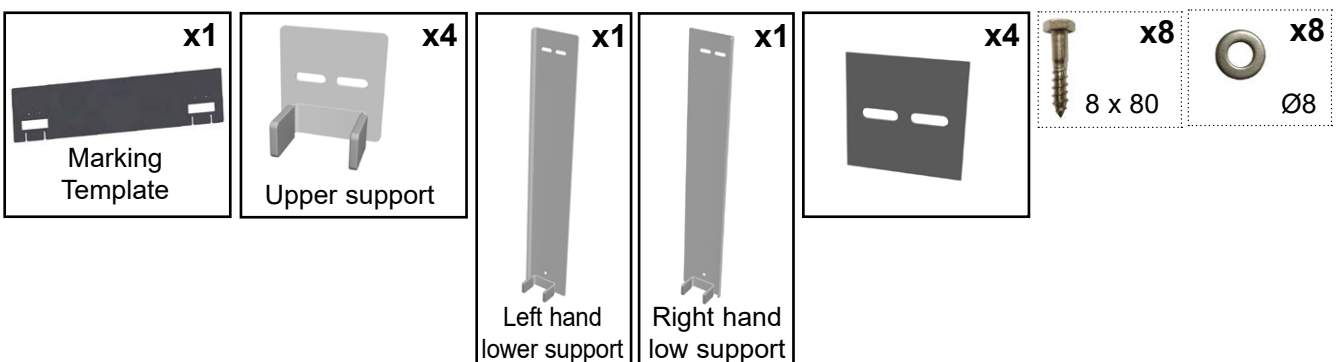

Beam

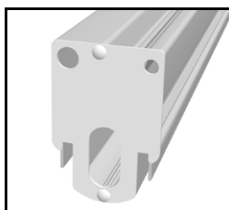

2 beams for roll-inside 1 side
3 beams for roll-inside 2 sides

Electric box



Key switch



Wi-key



or

Decking

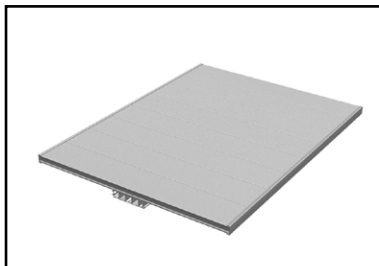

Slats



Fastening kits

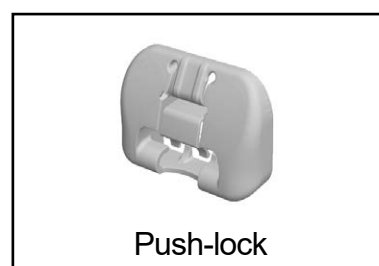

PACKING LIST

e.g. for a 5 x 10 m pool with Ø3 m roman steps

Wall units:

For beam support: 1 box of 1 x 0.20 x 0.20 m -- 10 kg

For tube: 1 box of 0.30 x 0.20 x 0.20 -- 5kg

The mechanism (tube) with the gear motor:

1 pack containing 5 x Ø0.25 m -- 50 Kg

The installation kit + control box + counter-weights + fastener kits:

1 pack containing 0.80 x 0.60 x 0.65 -- 45 kg

Beam support:

1 side : 1 box of 0.75 x 0.25 x 0.15 -- 4kg

2 sides : 1 box of 0.75 x 0.25 x 0.15 -- 10kg

The beams:

1 side : 2 box of 5.1 x 0.17 x 0.12 -- 60 kg

2 sides : 3box of 5.1 x 0.17 x 0.12 -- 90kg

Decking :

1 side : 1 pallet of 1.20 x 1 x 0.40 -- 40kg

2 sides : 1 pallet of 1.20 x 1 x 0.40 -- 70 kg

Slats :

5 box of 5.1 x 0.20 x 0.25 -- 250 kg

Total weight :

Roll-inside 1 side: 454 kg

Roll-inside 2 sides: 520 kg



Roll-inside - surface mounted - tubular immersed motorisation

DELIVERED PARTS

Parts to insert (inserting kit)

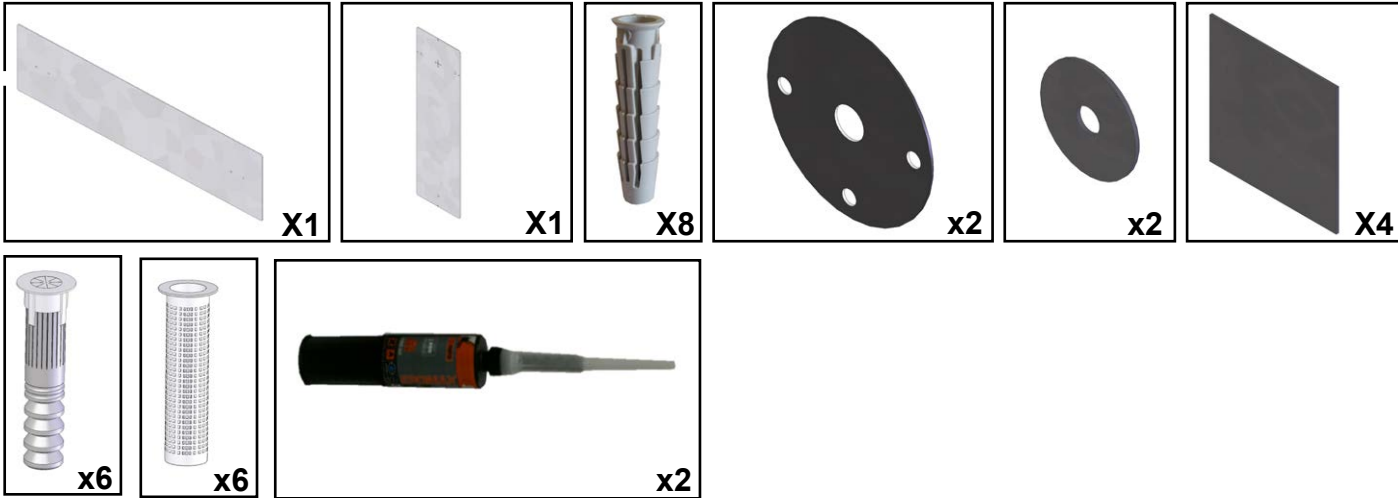

Mechanism

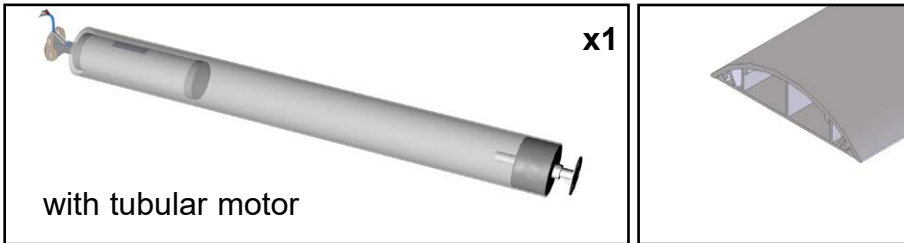

Counter-weight

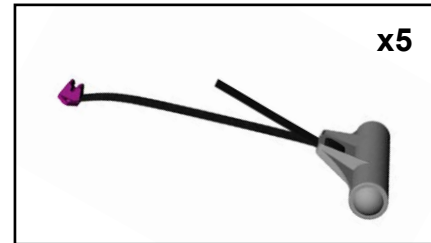

Mechanical fastener bag

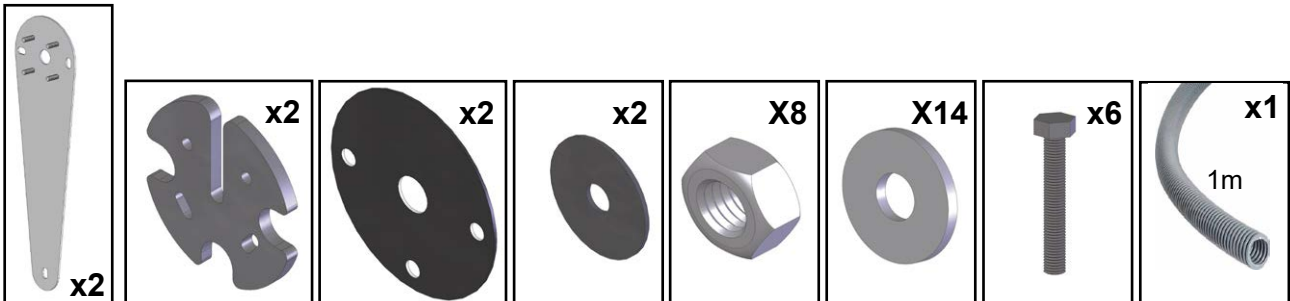

Beam support

For roll-inside 1 side

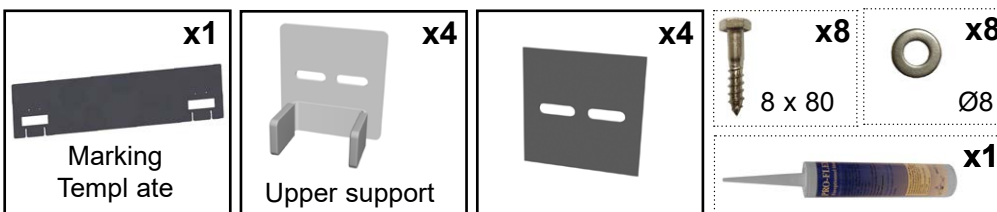

For roll-inside 2 sides

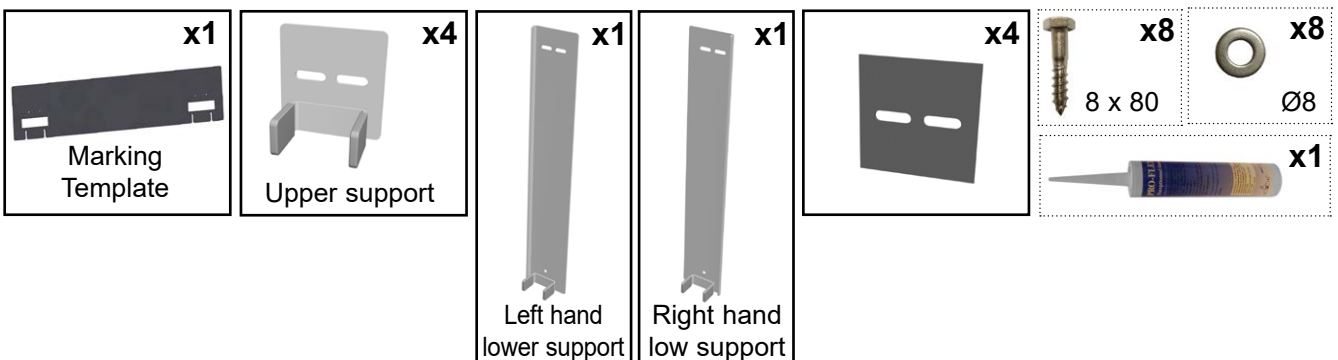

Beam

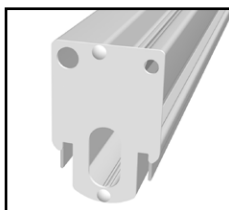

2 beams for roll-inside 1 side
3 beams for roll-inside 2 sides

Electric box



x1

Key switch



x1

Wi-key



x1

or

Decking



Slats



Fastening kits

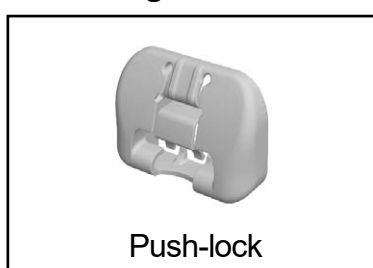

Push-lock

PACKING LIST

e.g. for a 5 x 10 m pool with Ø3 m roman steps

Wall units:

For beam support: 1 box of 1 x 0.20 x 0.20 m -- 10 kg

For the mechanism (tube): 1 box of 0.30 x 0.20 x 0.20 -- 5kg

The mechanism (tube) with the gear motor:

1 pack containing 5 x Ø0.25 m -- 50 Kg

The installation kit + control box + counter-weights + fastener kits:

1 pack containing 0.80 x 0.60 x 0.65 -- 45 kg

Beam support:

1 side : 1 box of 0.75 x 0.25 x 0.15 -- 4kg

2 sides : 1 box of 0.75 x 0.25 x 0.15 -- 10kg

The beams:

Roll-inside 1 side: 2 box of 5.1 x 0.17 x 0.12 -- 60 kg

Roll-inside 2 sides: 3 box of 5.1 x 0.17 x 0.12 -- 90kg

Decking :

Roll-inside 1 side: 1 pallet of 1.20 x 1 x 0.40 -- 40kg

Roll-inside 2 sides: 1 pallet of 1.20 x 1 x 0.40 -- 70 kg

Slats :

5 box of 5.1 x 0.20 x 0.25 -- 250 kg

Total weight :

Roll-inside 1 side: 454 kg

Roll-inside 2 sides: 520 kg



Roll-inside - insert mounting - motorisation in a dry pit

INSTALLATION OF THE INSERTED PARTS

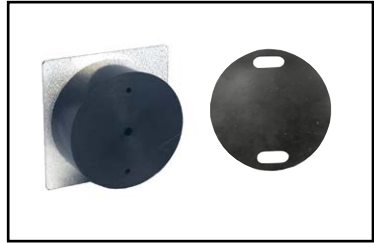
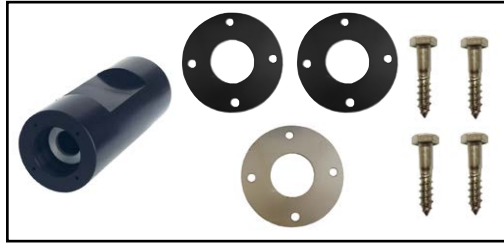
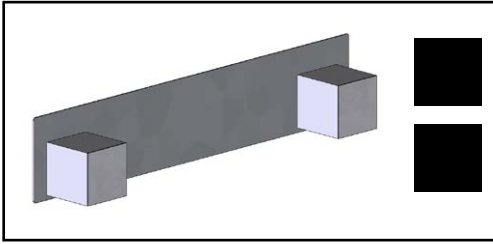

positioning



L (m)	11	12	13	14	15	16	17	18	19	20
*B (cm)	45	46	47	48	48.5	49	50	51	52	53
*C (cm) mini	76	78	80	81	83	85	87	88	90	91

1 side

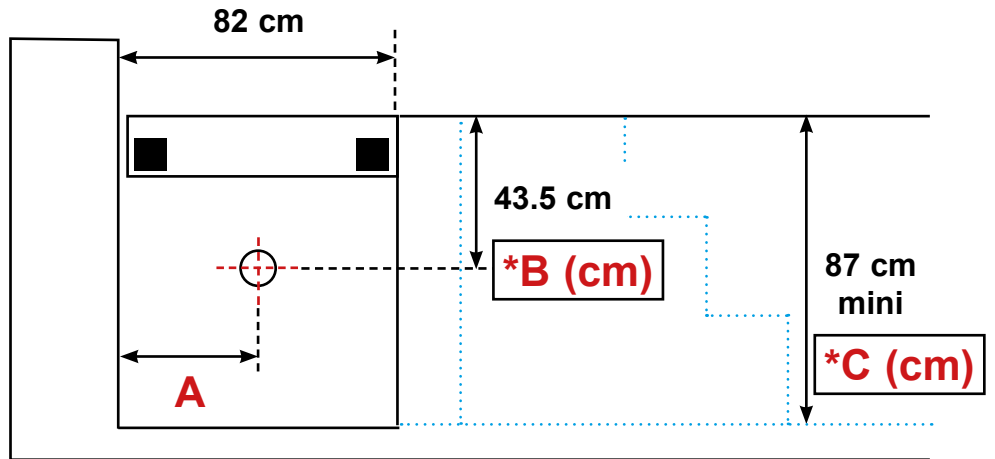
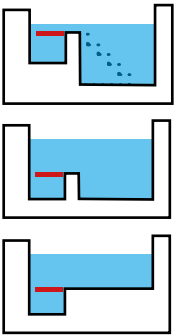

2 sides

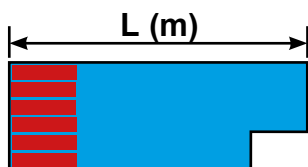
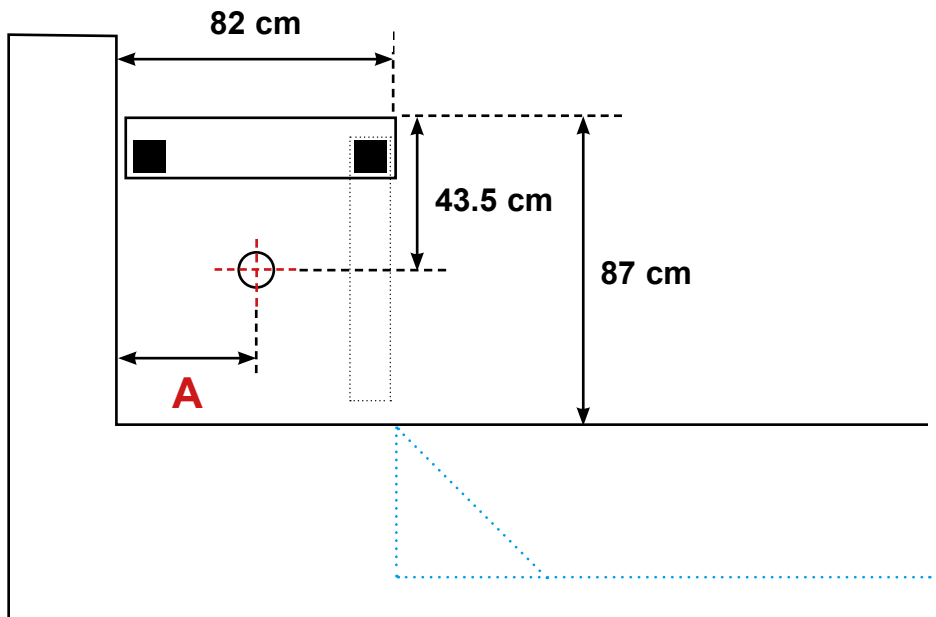
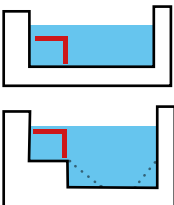

L	6	7	8	9	10	11	12	13	14	15	16	17	18	19	20
A (cm)	26	27	28	29	31	32	33	34	35	35	36	37	38	39	40

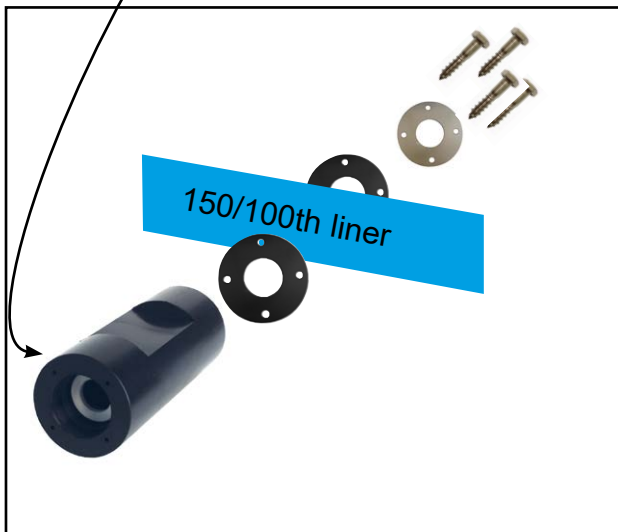
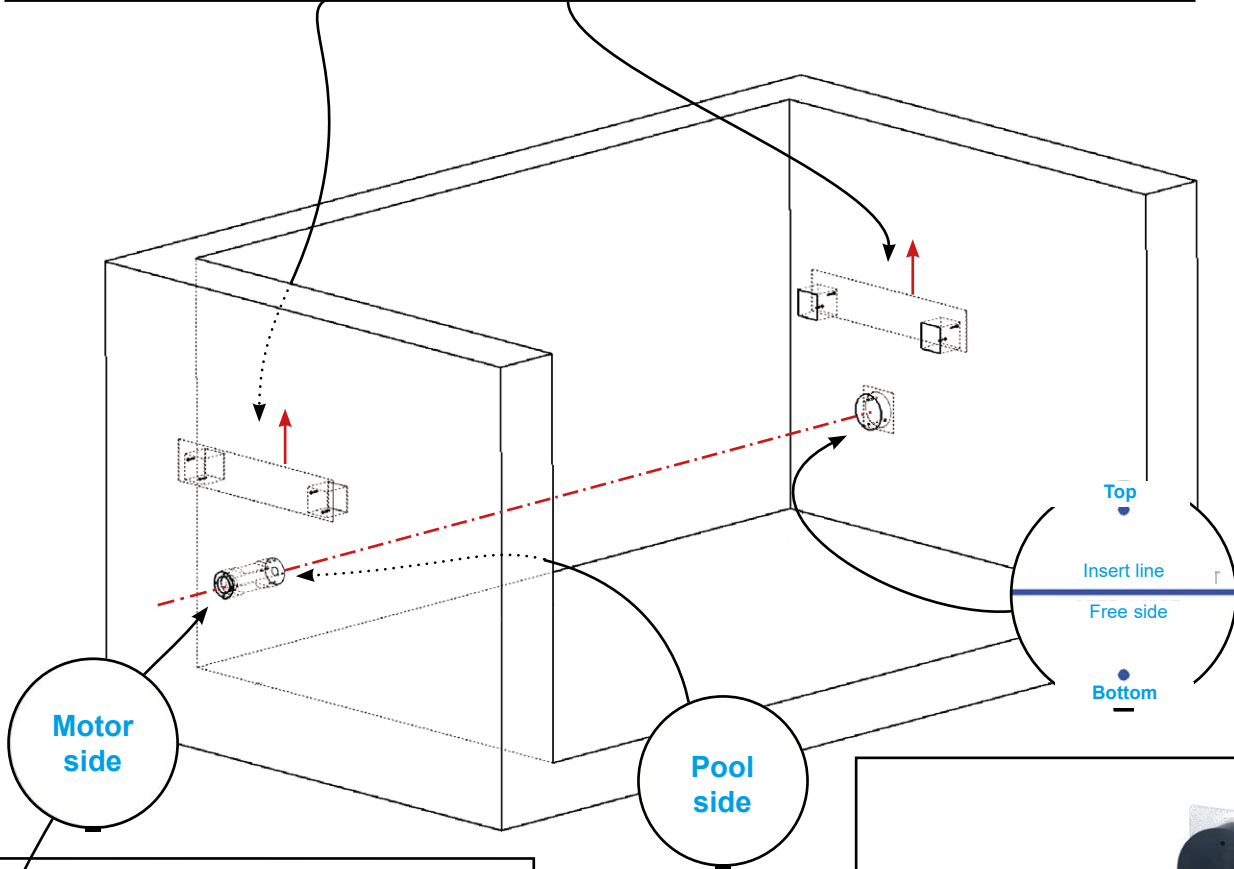
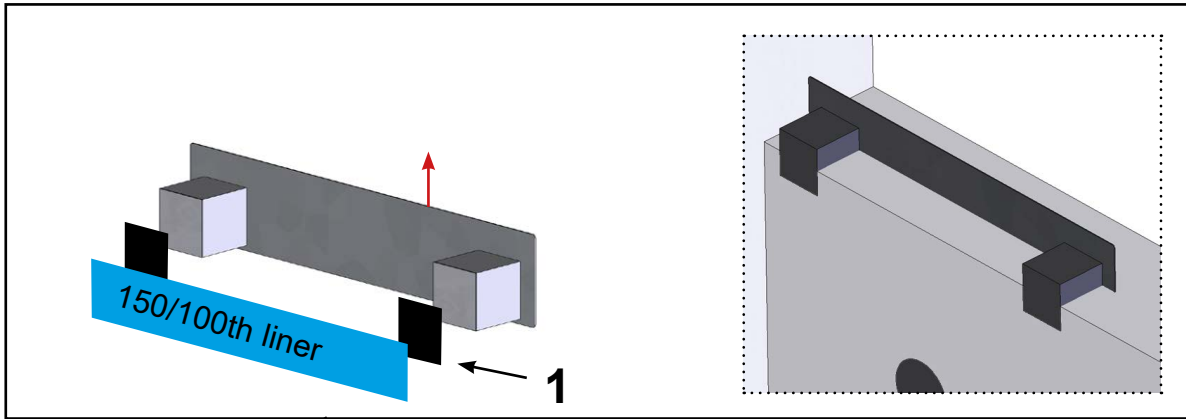

Roll-inside - insert mounting - motorisation in a dry pit

INSTALLATION OF THE INSERTED PARTS

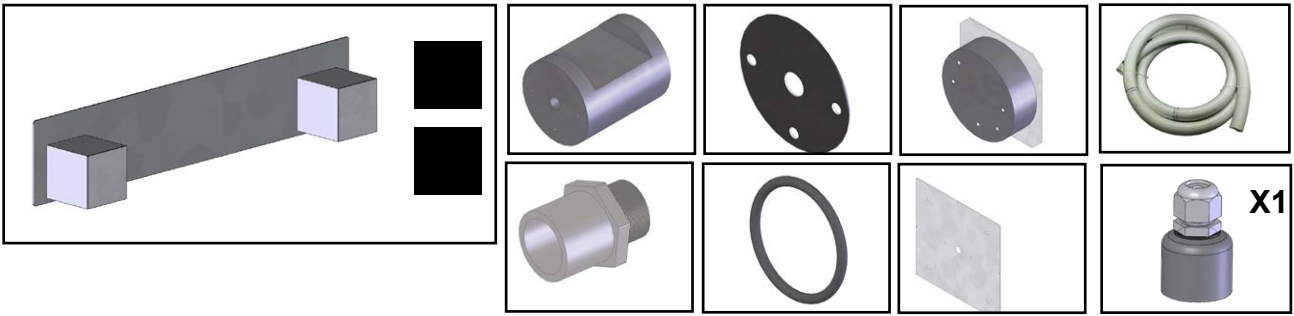

positioning

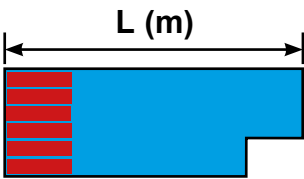

for pools of more than 7 m wide

L (m)	11	12	13	14	15	16	17	18	19	20
*B (cm)	45	46	47	48	48.5	49	50	51	52	53
*C (cm) mini	76	78	80	81	83	85	87	88	90	91

1 side

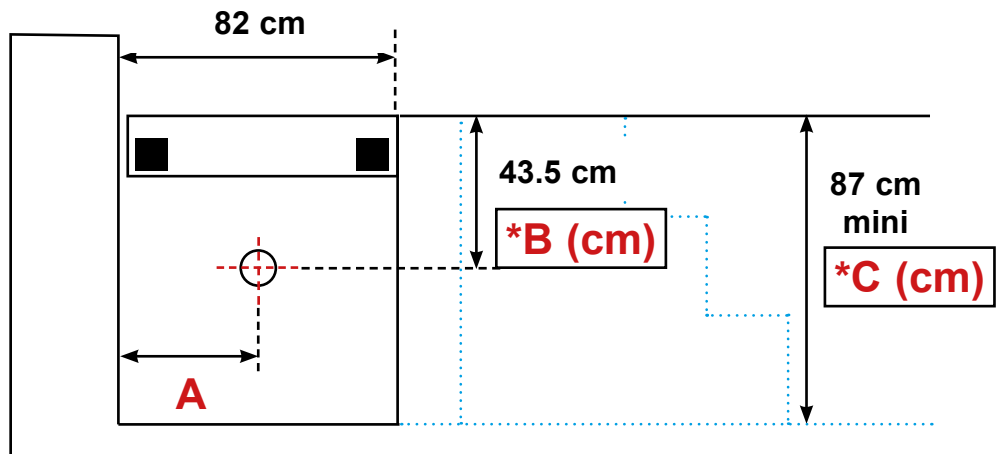
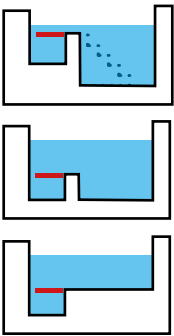

2 sides

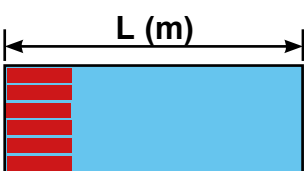
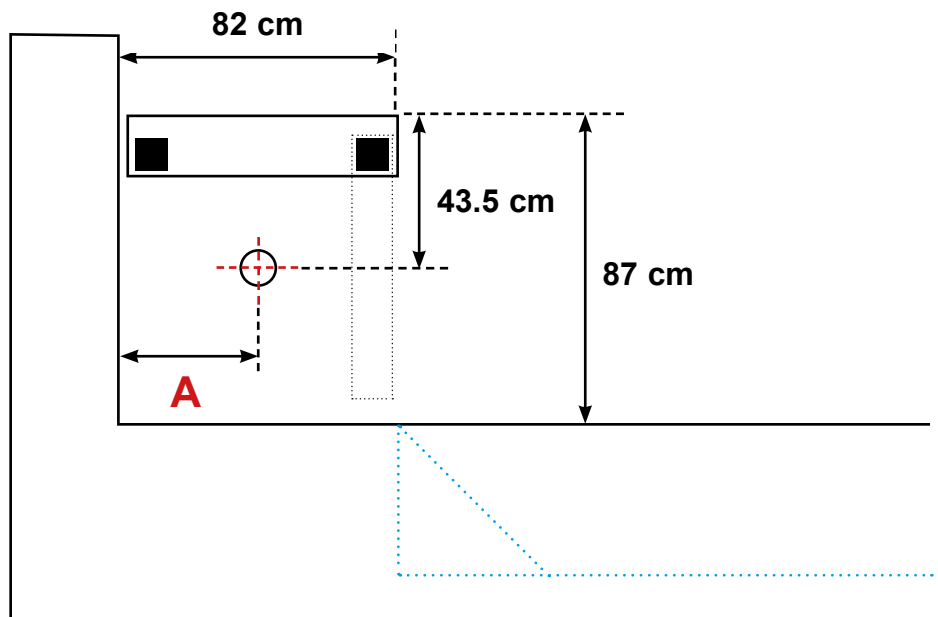
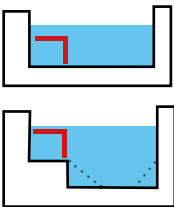

L	6	7	8	9	10	11	12	13	14	15	16	17	18	19	20
	26	27	28	29	31	32	33	34	35	35	36	37	38	39	40

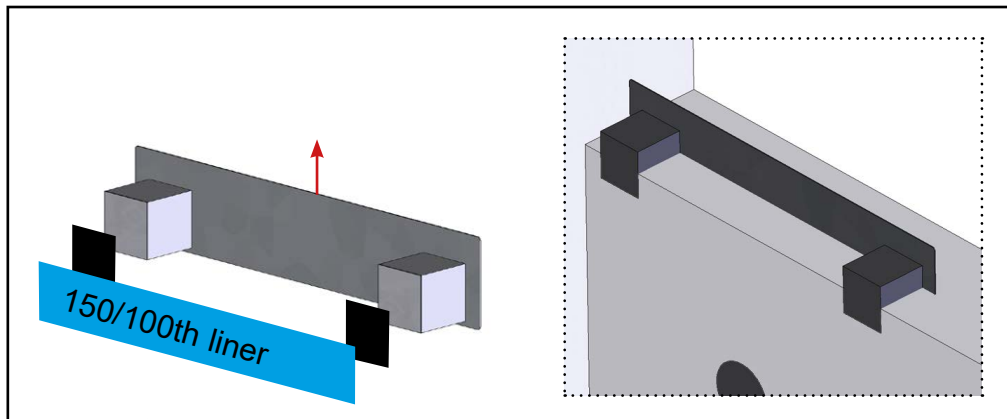

Connection box "Option"

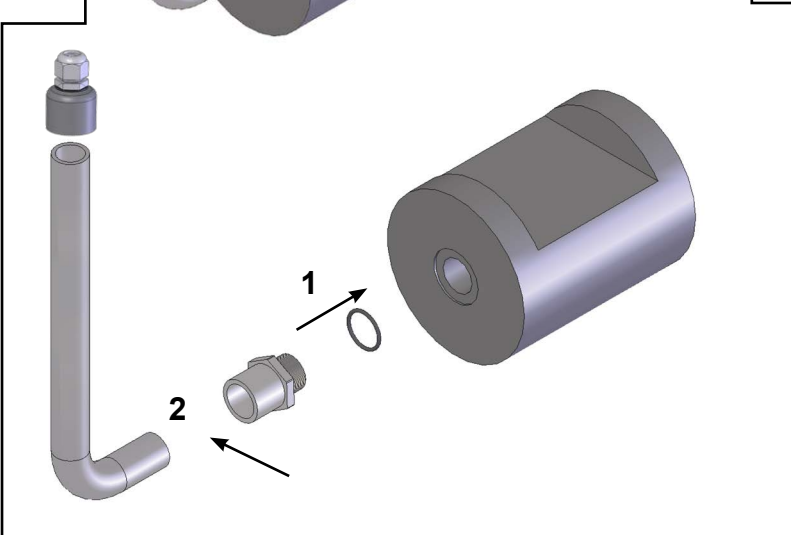
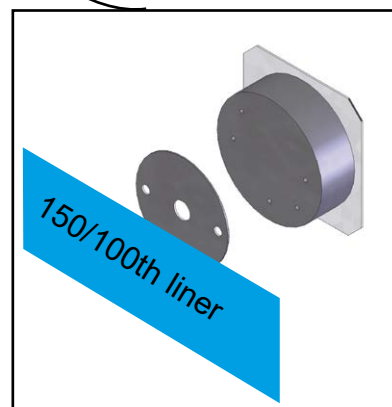
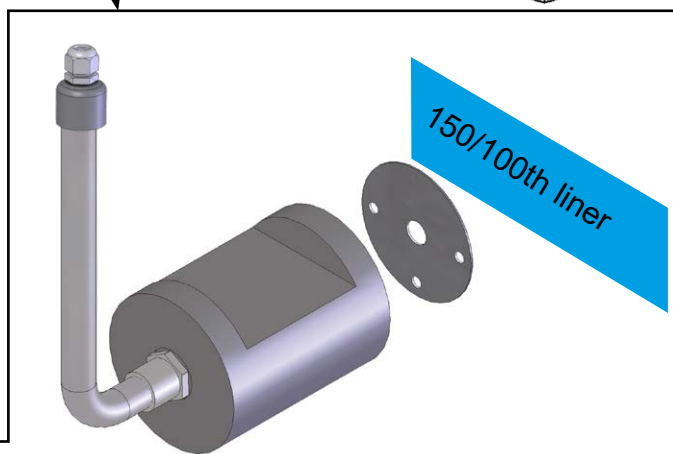
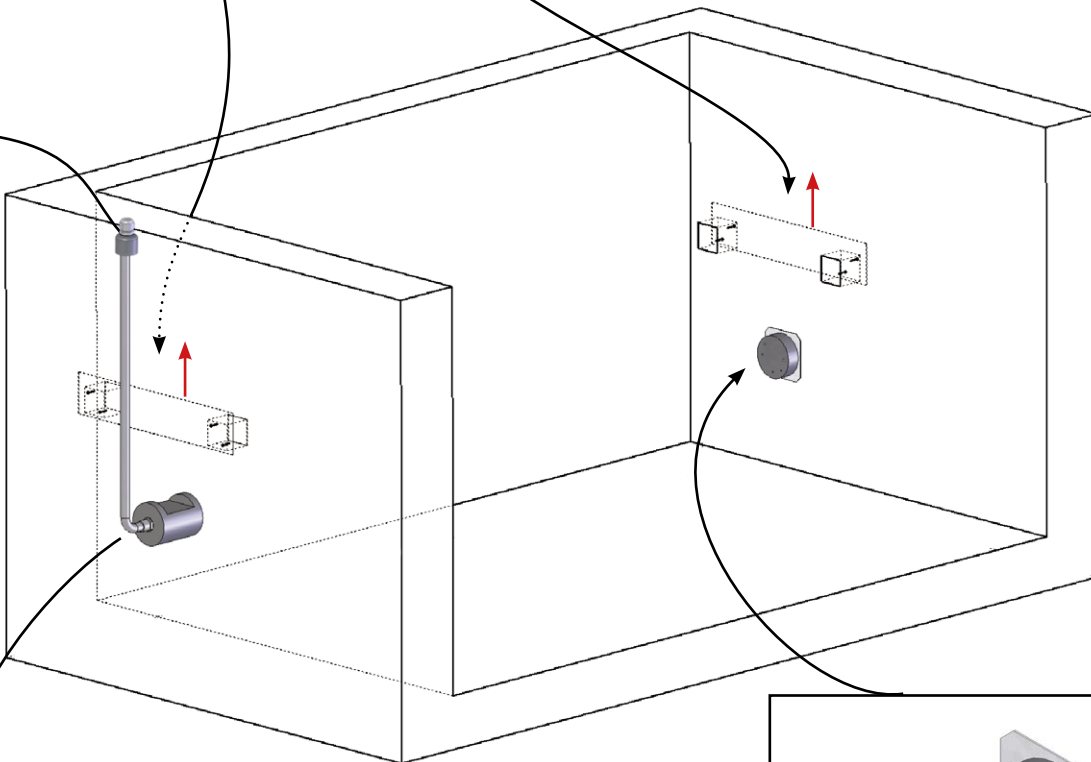

Box template

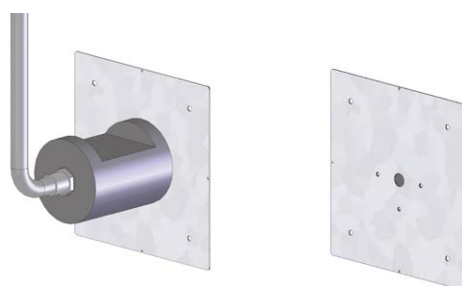

Roll-inside - surface mounted - tubular immersed motorisation

INSTALLATION OF THE INSERTED PARTS

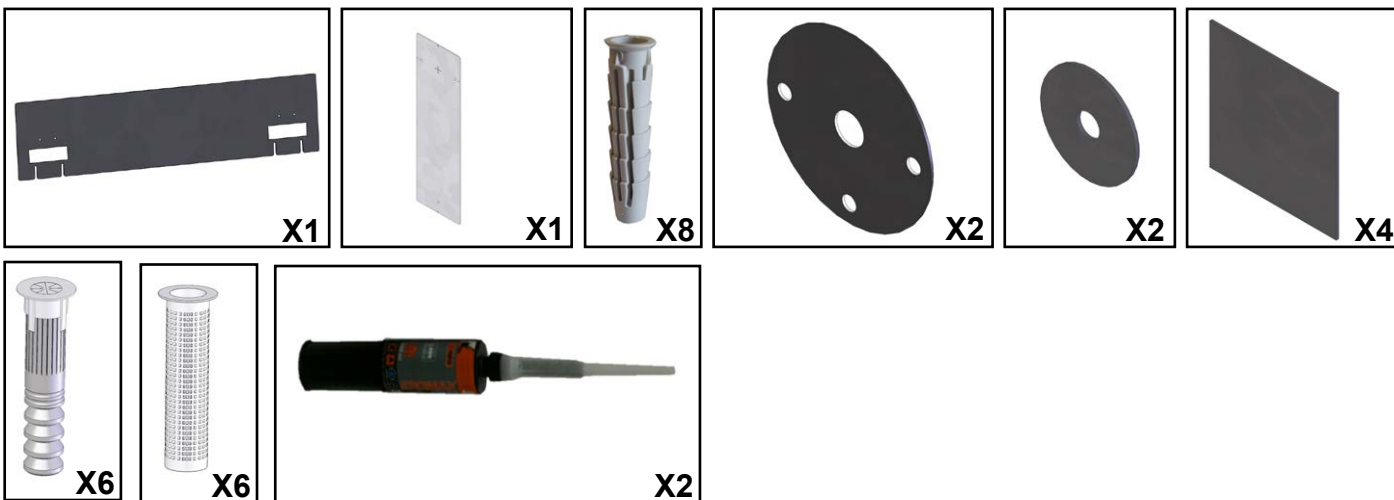

Positioning

1 side

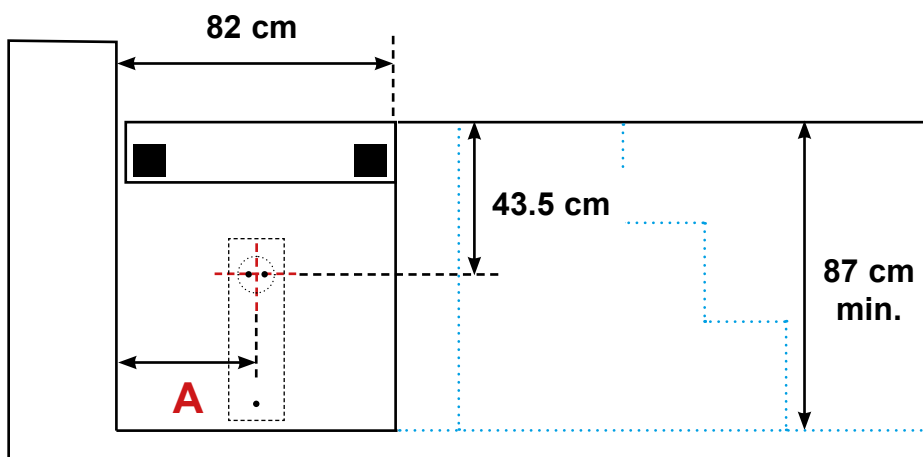
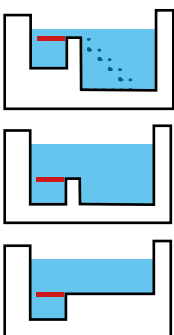

2 sides

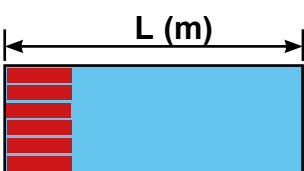
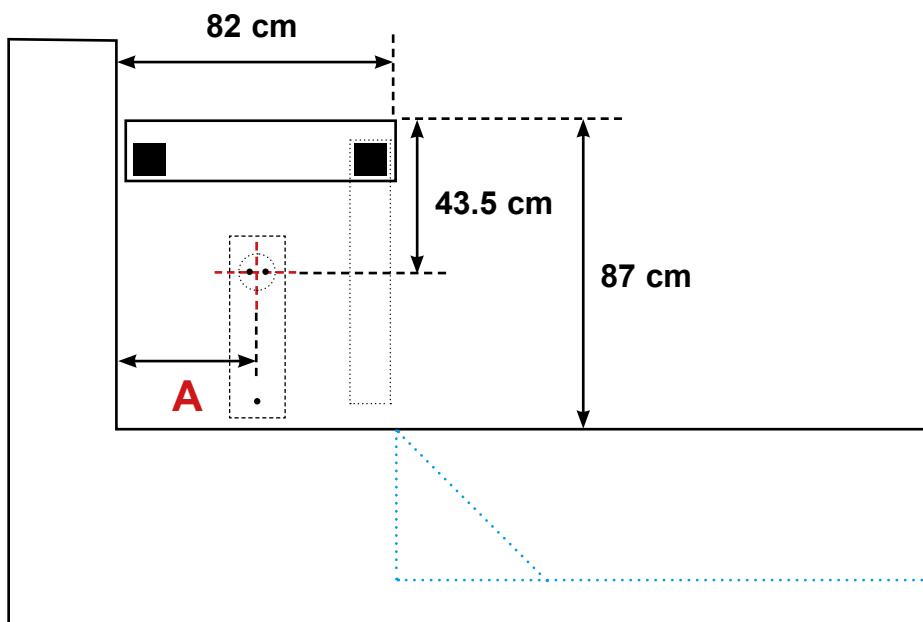
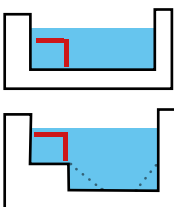

L	6	7	8	9	10	11	12	13	14	15	16	17	18	19	20
A (cm)	26	27	28	29	31	32	33	34	35	35	36	37	38	39	40

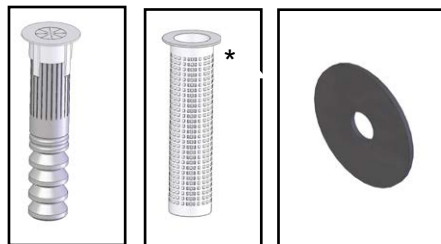
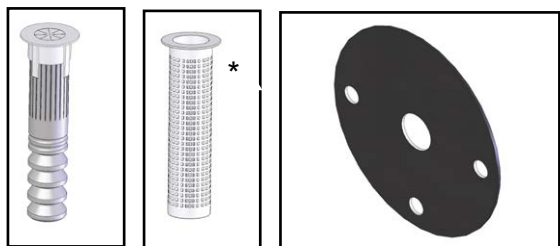
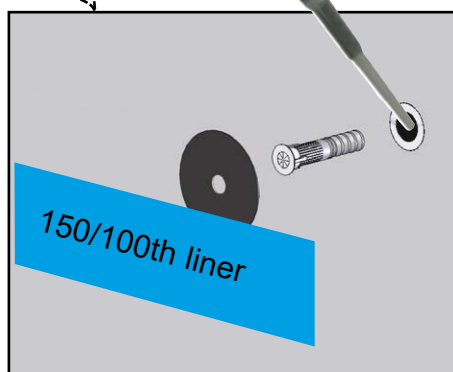
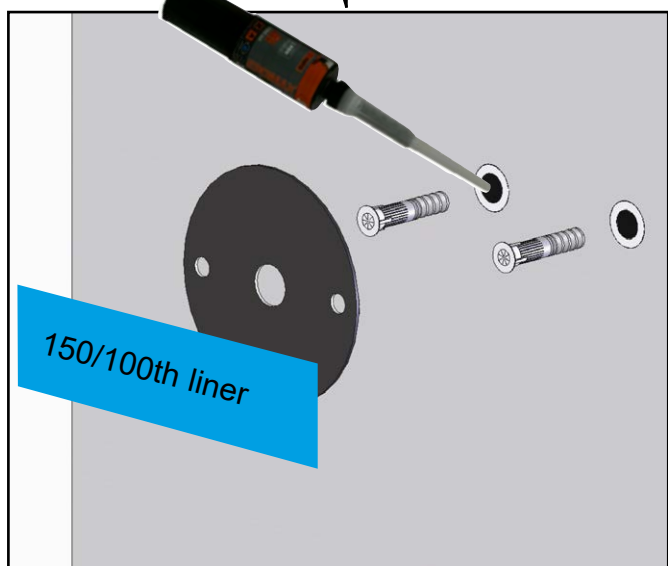
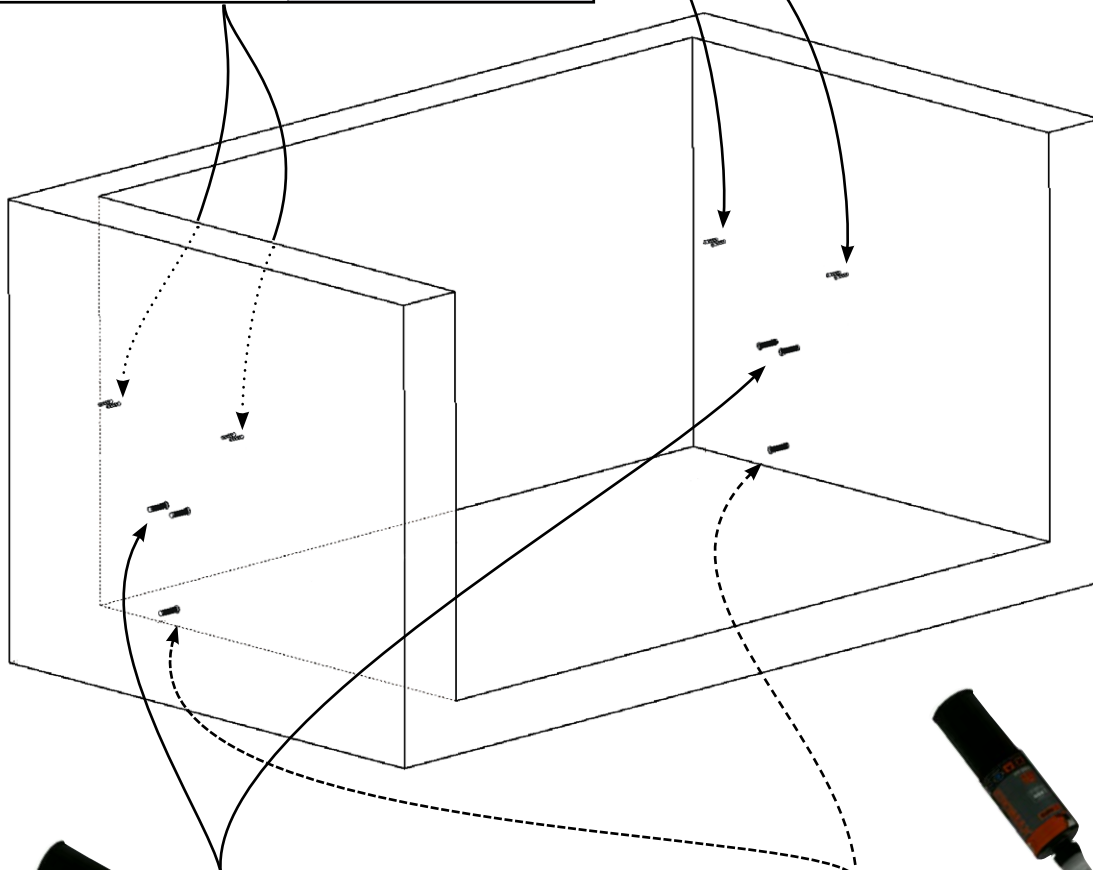
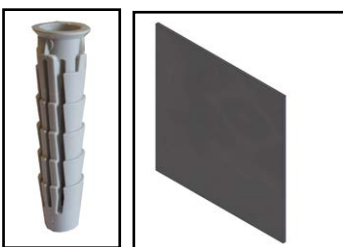
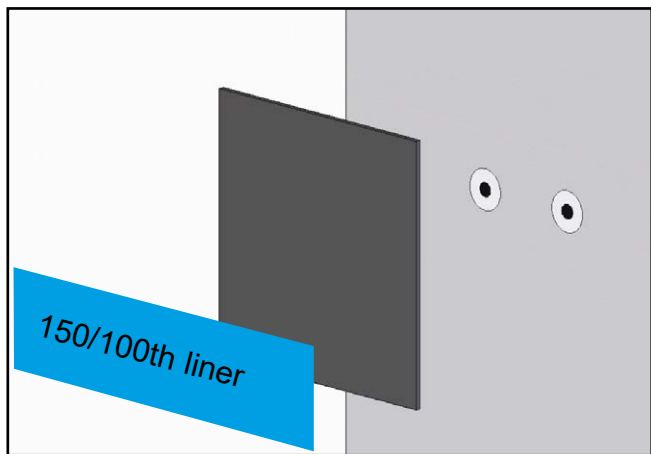

* Only for hollow sides

Roll-inside - for insert mounting - motorisation in a dry pit

INSTALLATION OF THE FLANGE MOTOR SIDE

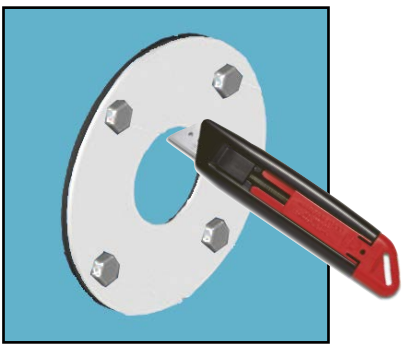
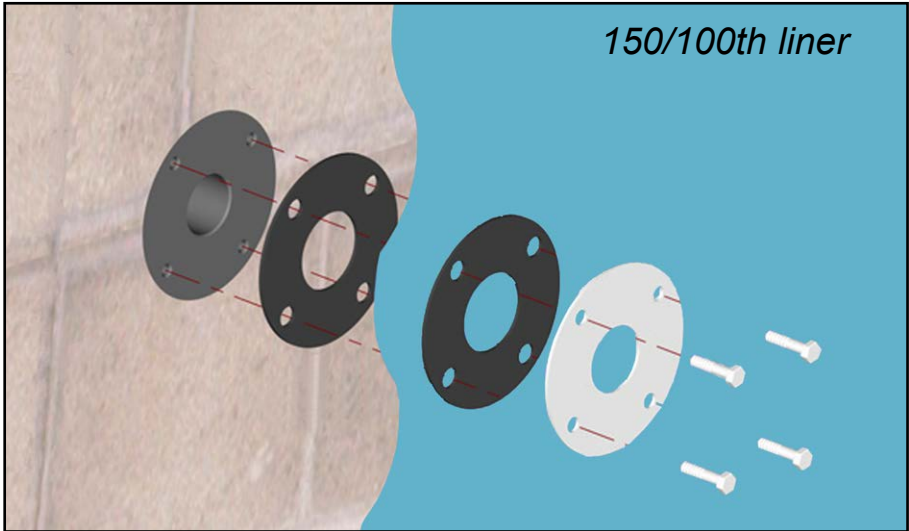
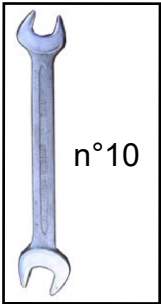
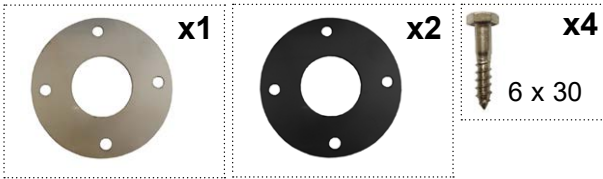

- Fill with water (approximately 20cm) before fixing the flange
- Cut the liner in the middle of the flange with a punch

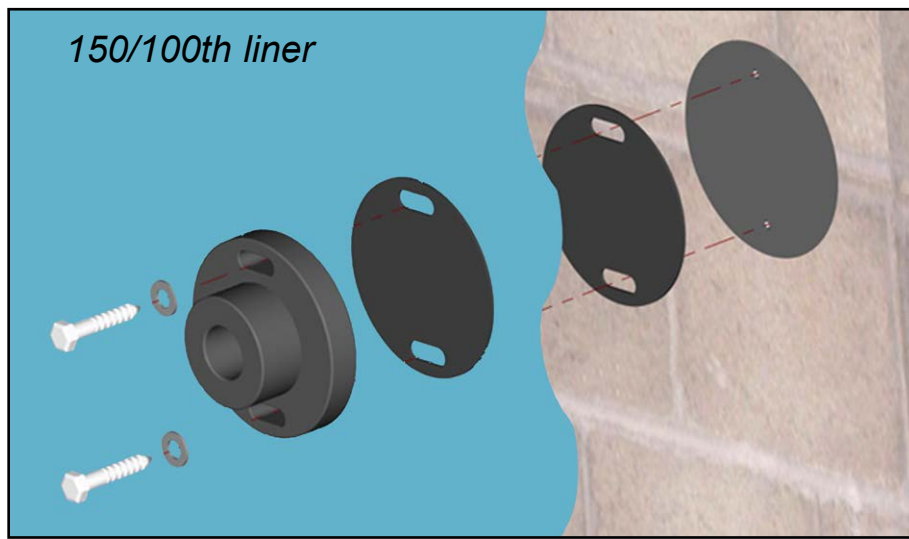
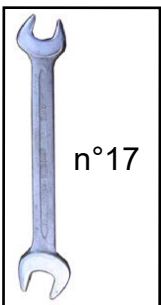
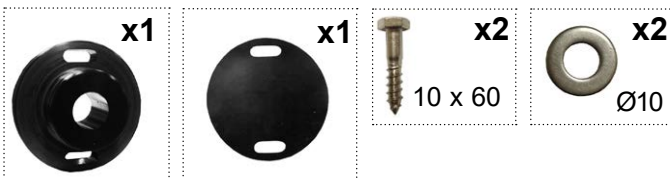

INSTALLATION OF THE BEARING ON THE FREE SIDE



- Fill with water (approximately 20cm) before fixing the bearing
- Cut the liner in the middle of the flange with a punch

INSTALLING THE MECHANISM

Reverse the tube on the motor side

 x1 6 sides male n°4	 x5 6x30	 x5 PVC Ø6
--	--	--

Bag

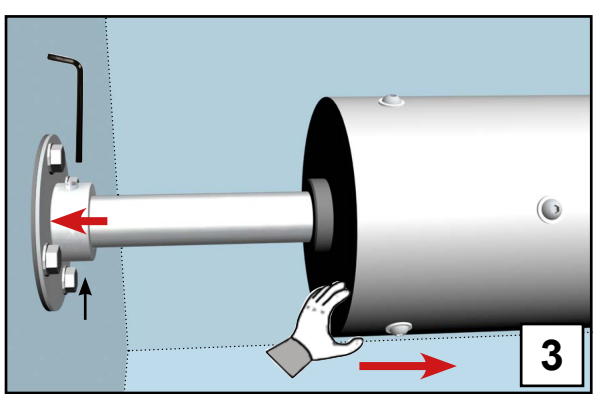
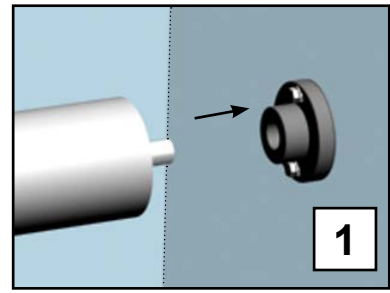
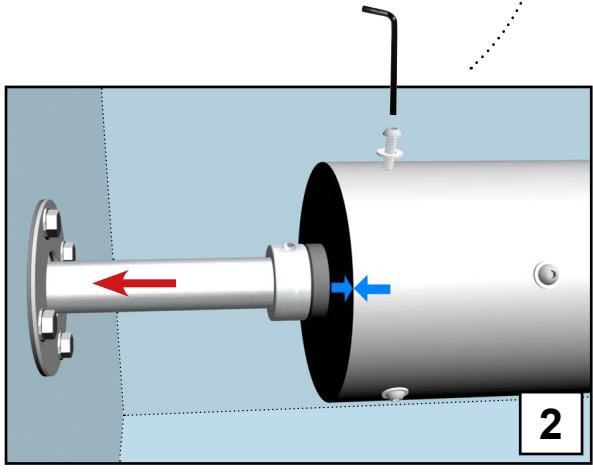
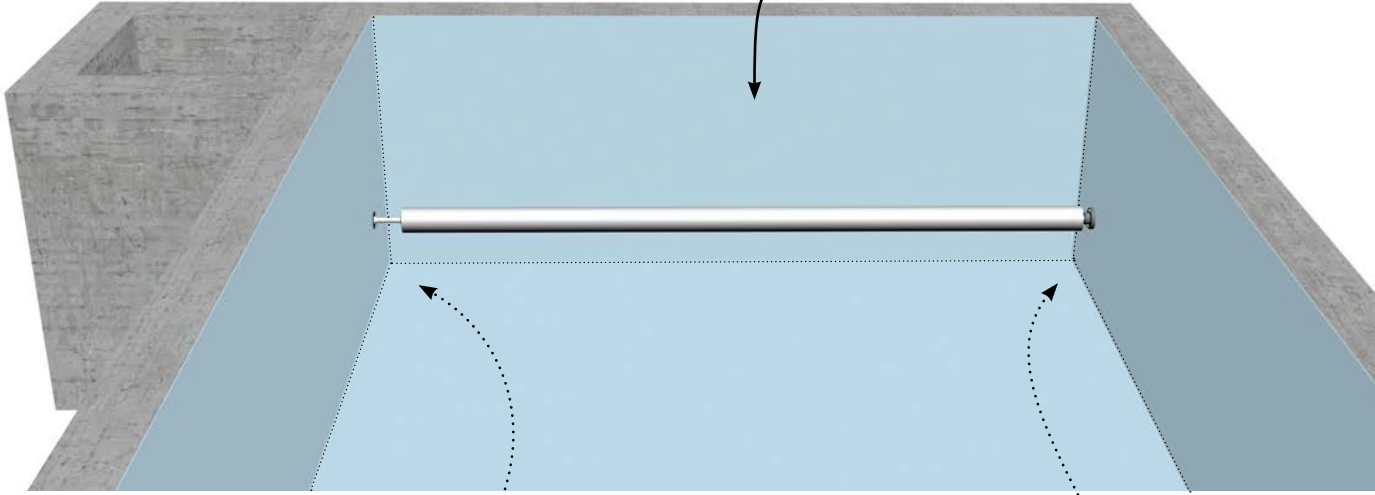

MAKING THE BOX WATERTIGHT ON THE MOTOR SIDE



GEAR MOTOR INSTALLATION

Turn the supports

MCA 120

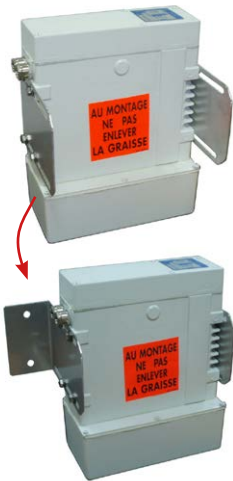

MCA 250



DL6010/7710



Install the gear motor on the tube

MCA 120



MCA 250



DL6010/7710



Fixture



MCA 120

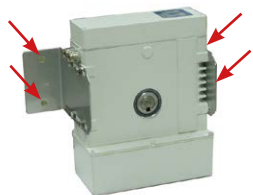

MCA 250



DL6010/7710

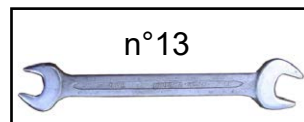
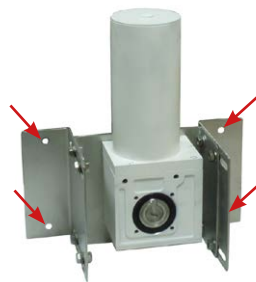

Fit the key

MCA 120



MCA 250



DL6010/*7710



Install the motor protection cap



MCA 120



MCA 250



DL6010/7710

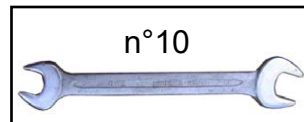

Option: 6 pin electric plug

Roll-inside - for insert mounting - tubular immersed motorisation

INSTALLING THE MECHANICAL FIXTURE

Motor side

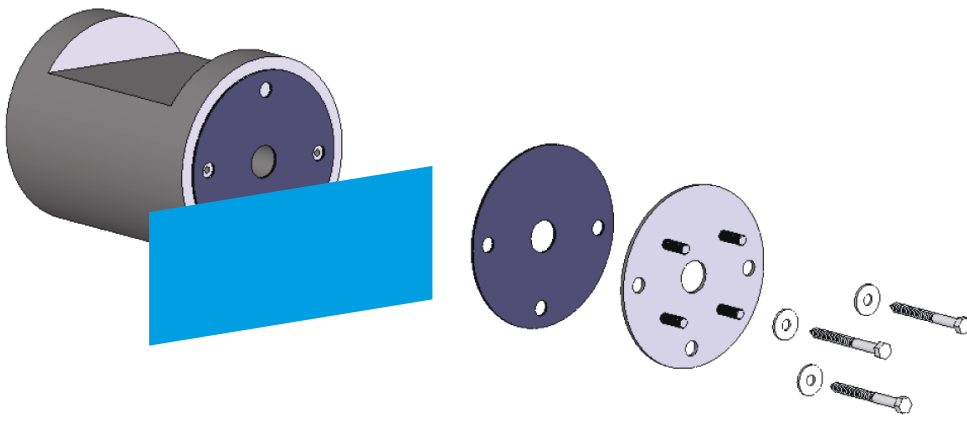
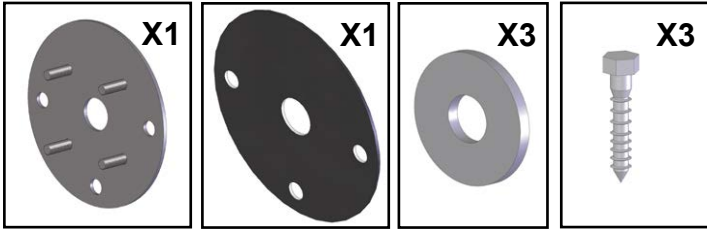

Free side

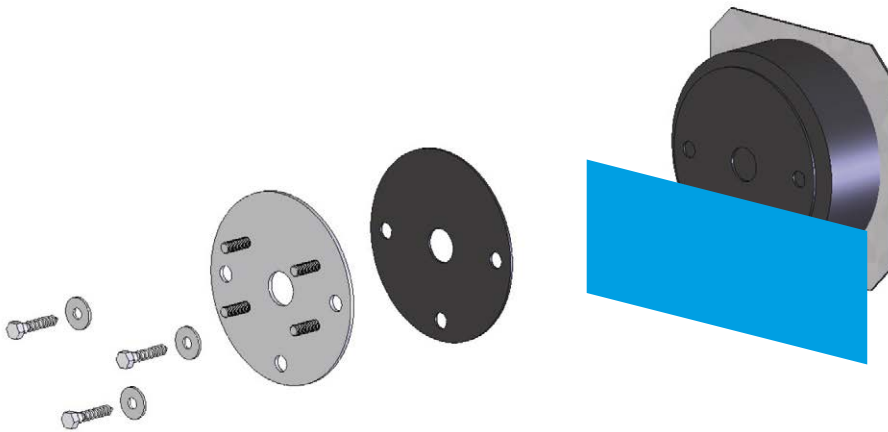
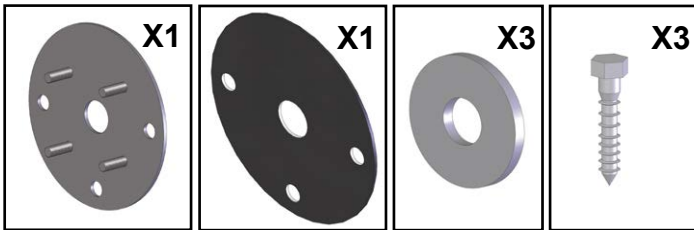

INSTALLING THE MECHANISM

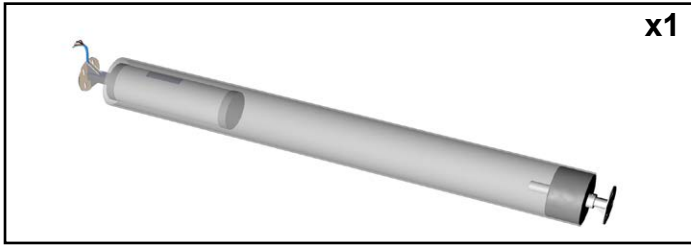

Motor side

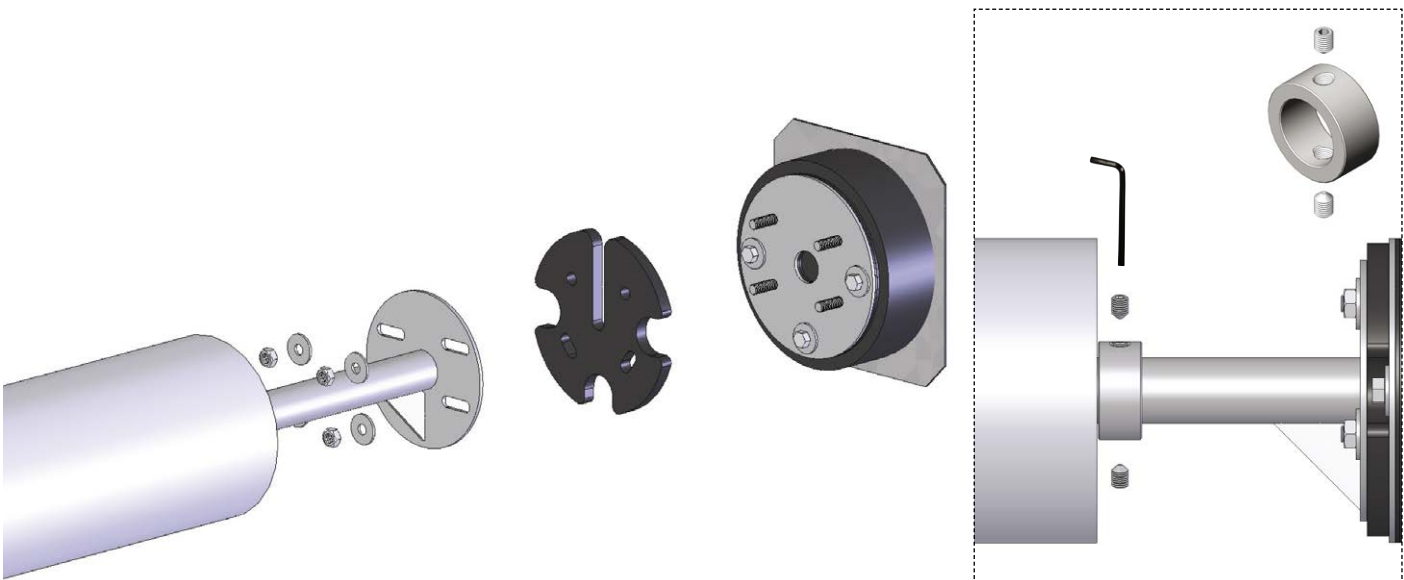
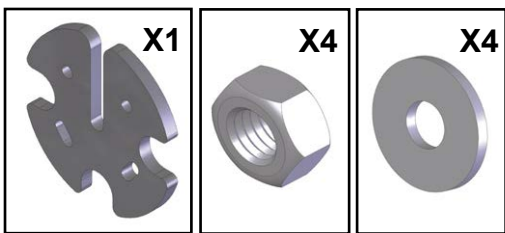
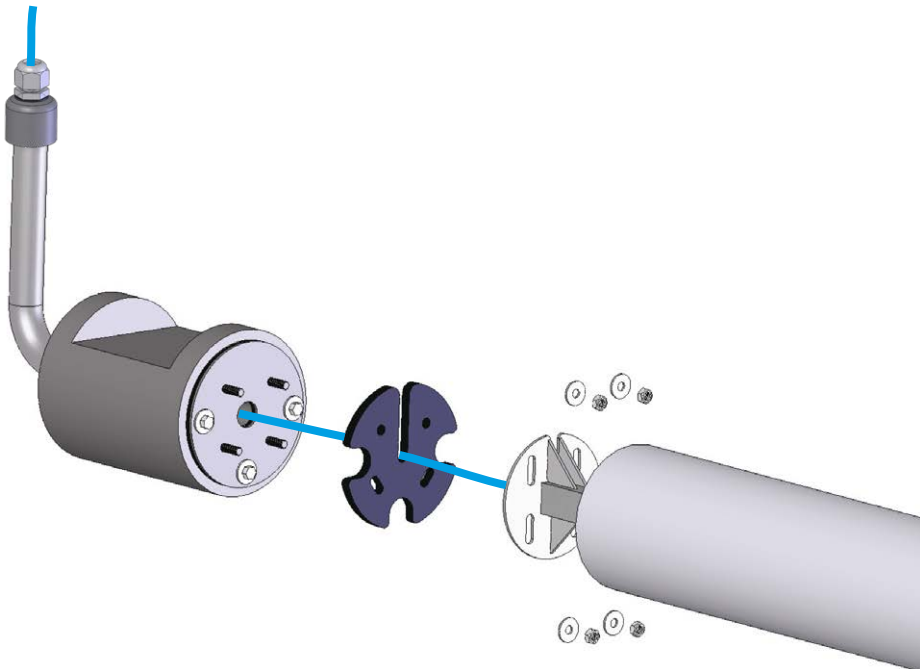
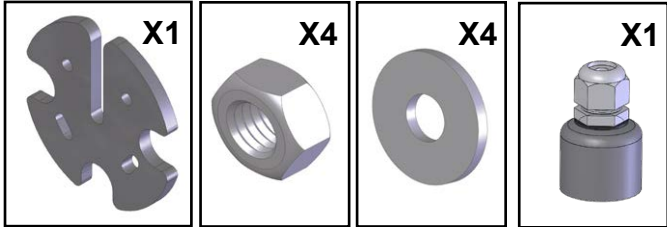

Roll-inside - surface mounted -
tubular immersed motorisation

INSTALLING THE MECHANICAL FIXTURE

Motor side

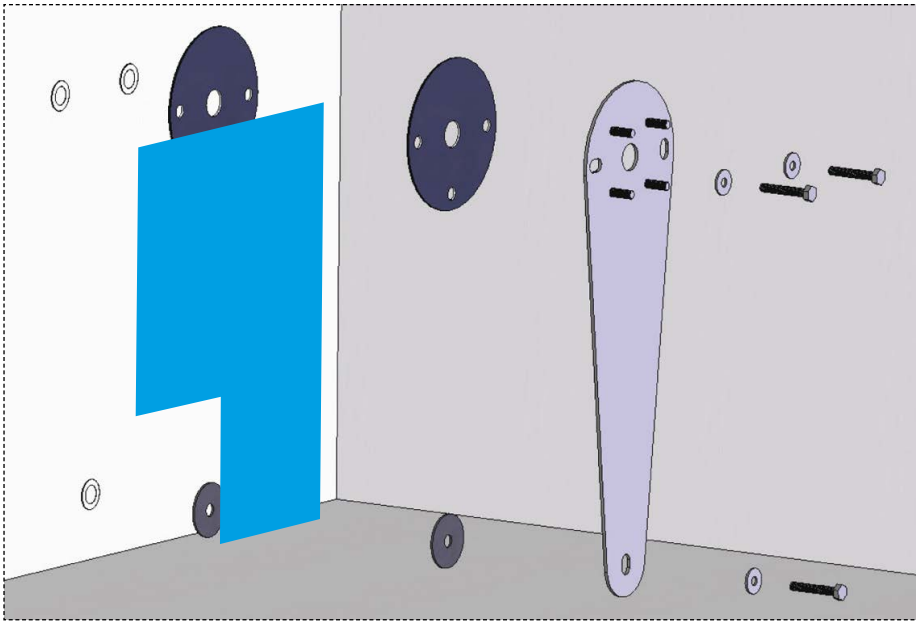
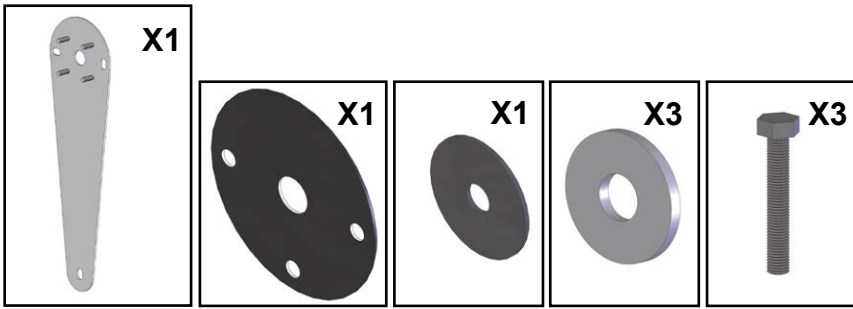

Free side

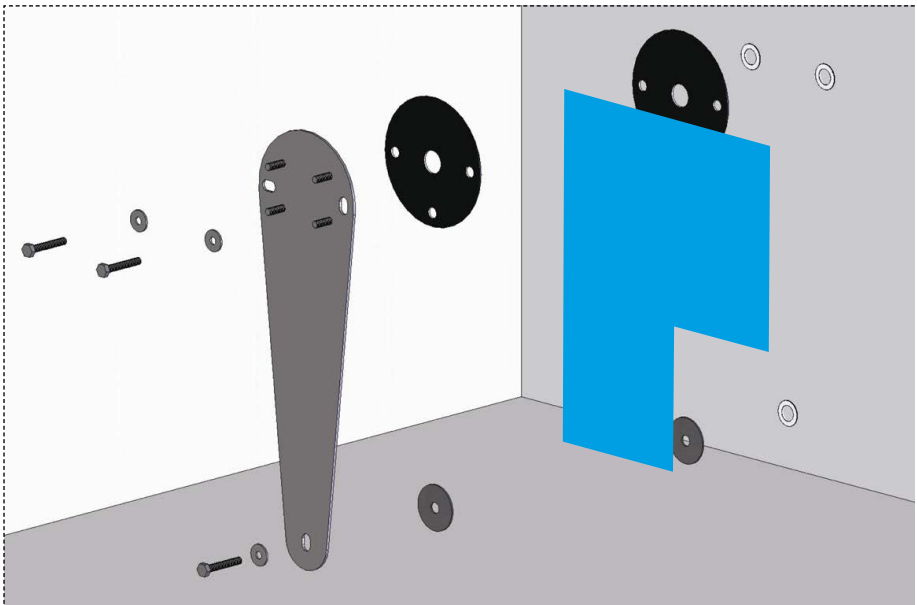
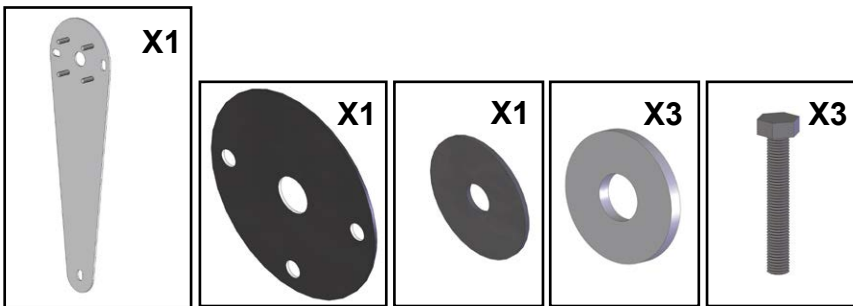

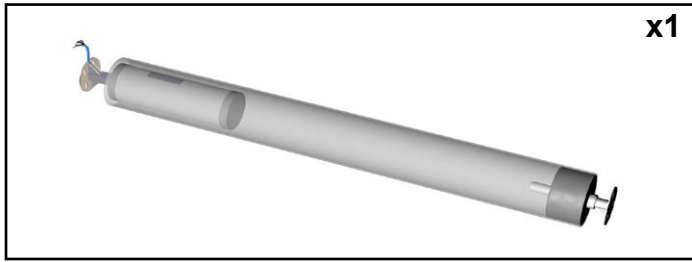

Motor side

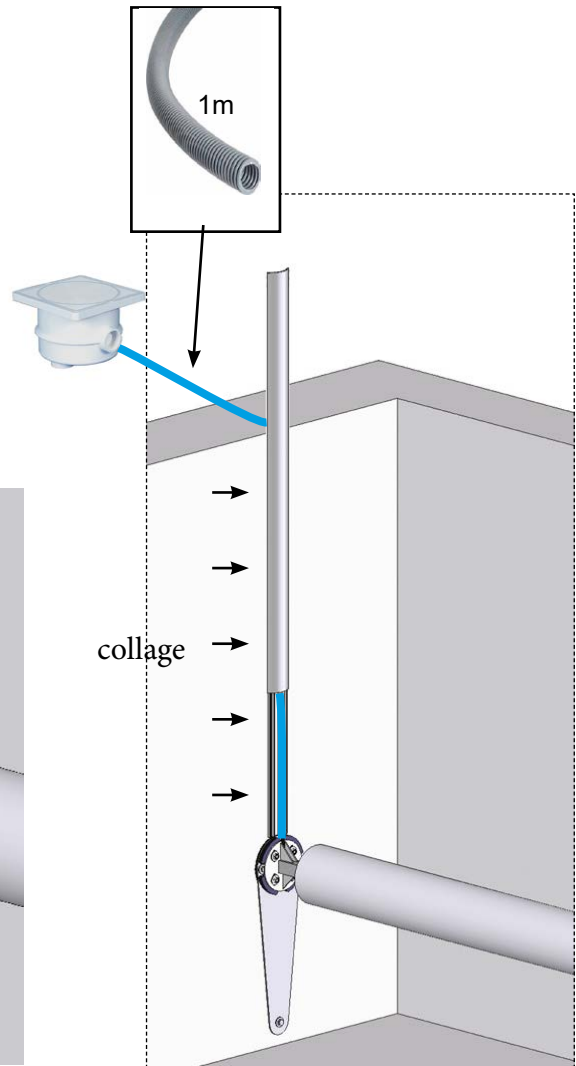
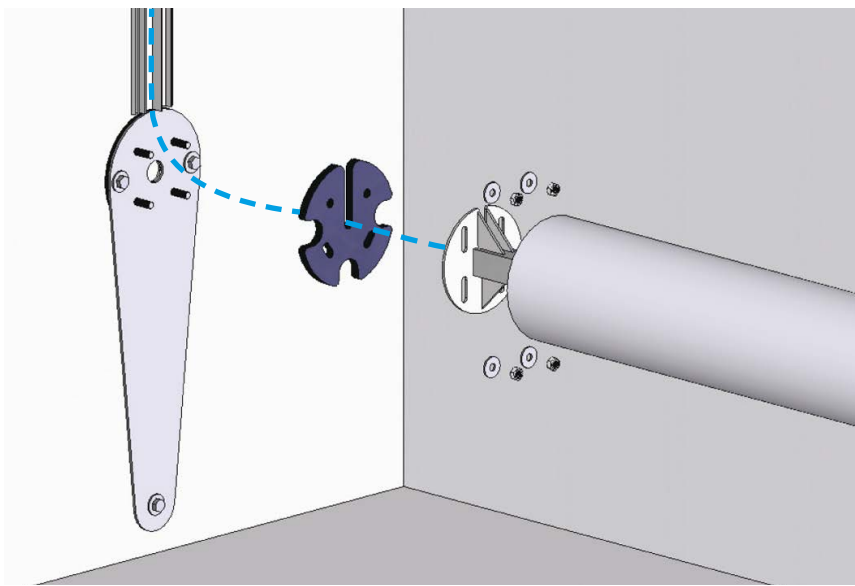
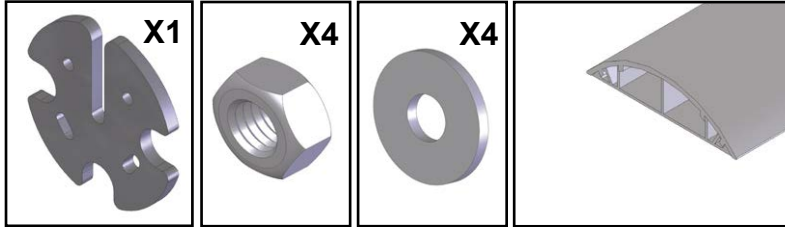

Free side

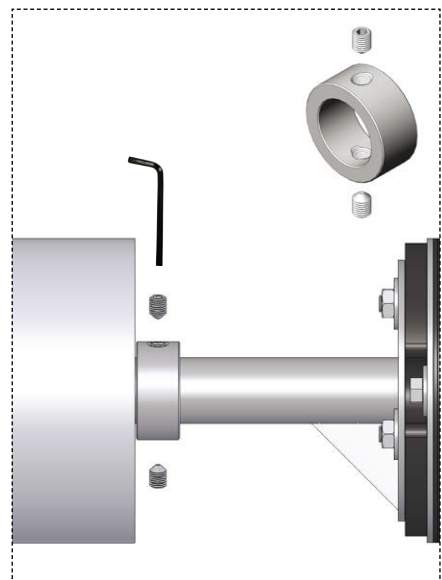
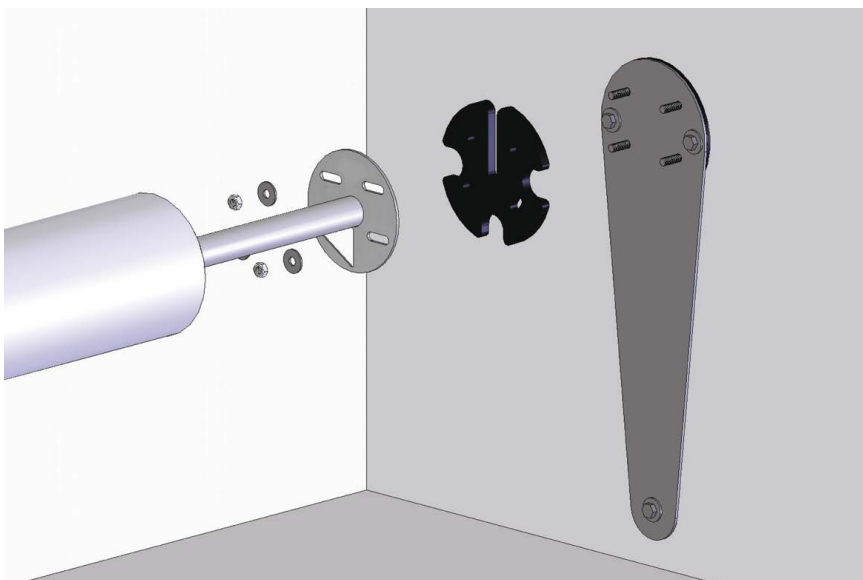
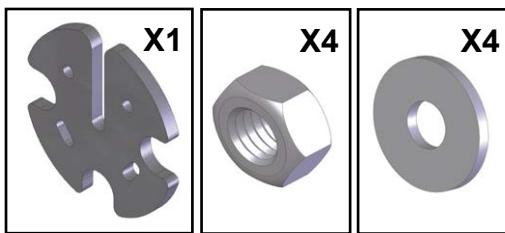

INSTALLING THE BEAM SUPPORTS

Tracing

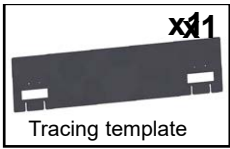

For the surface mounted version, the template can help to find the position of the previously installed anchor plugs.

Roll-inside 1 side

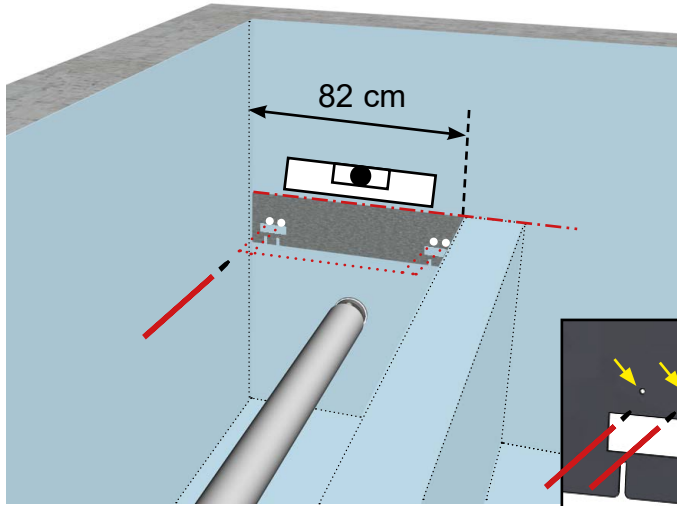

Roll-inside 2 sides

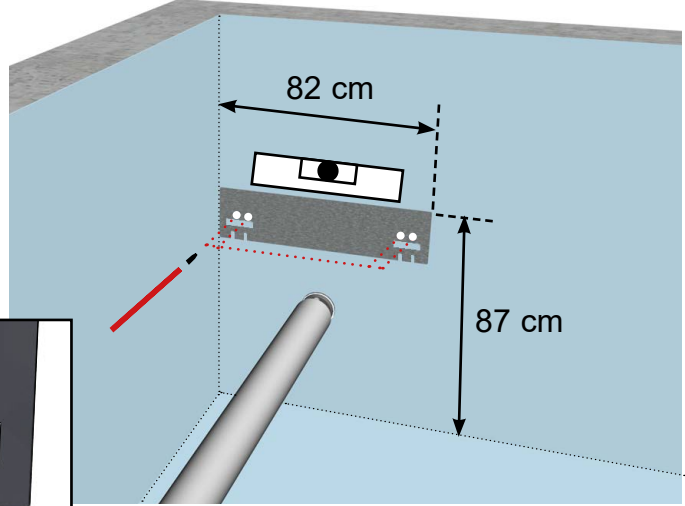

Fixture

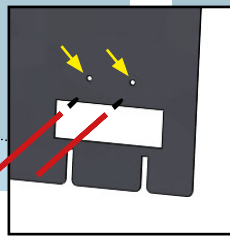

Roll-inside 1 side

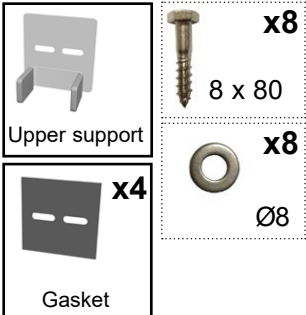

Fill the anchor plug with proflex

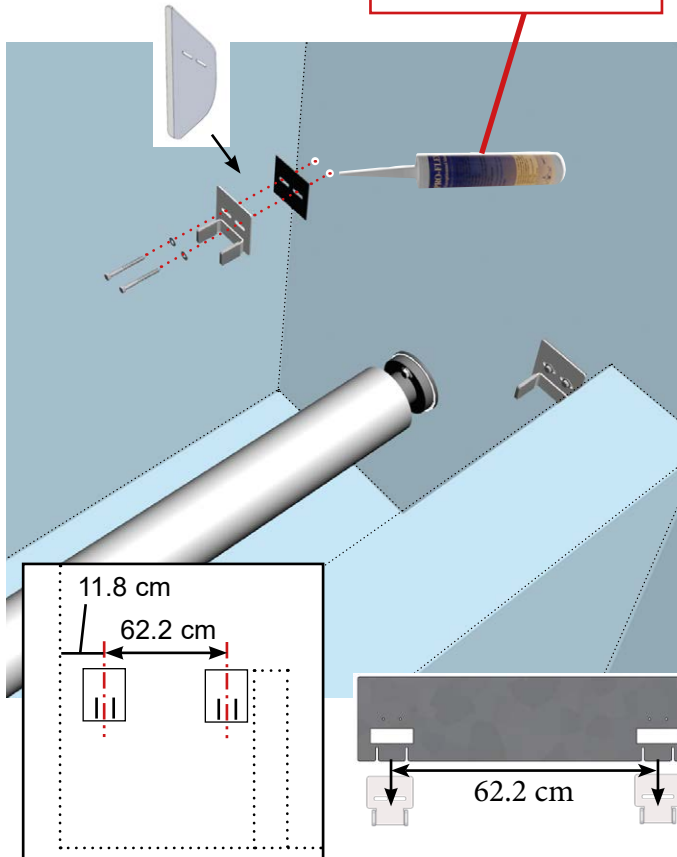

Roll-inside 2 sides

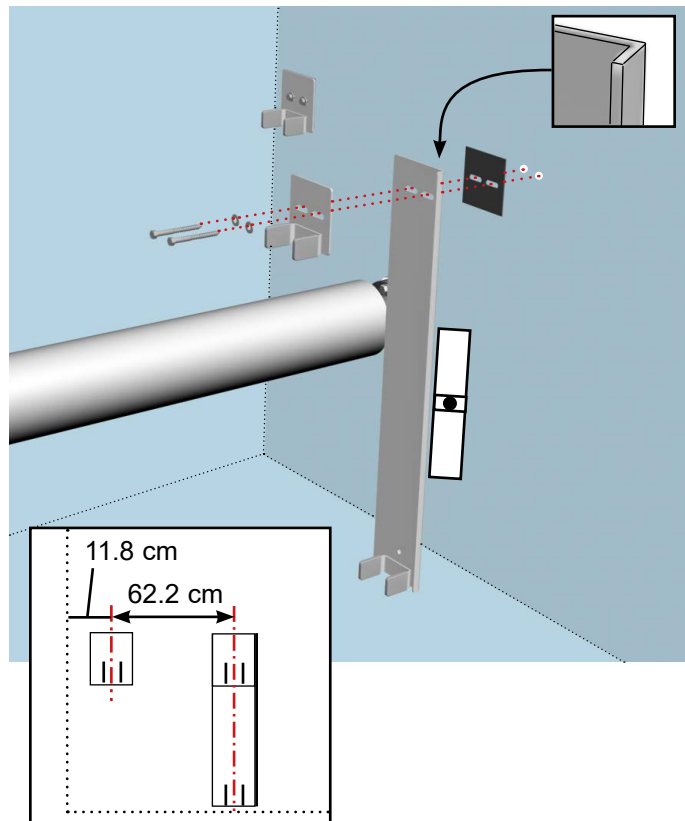
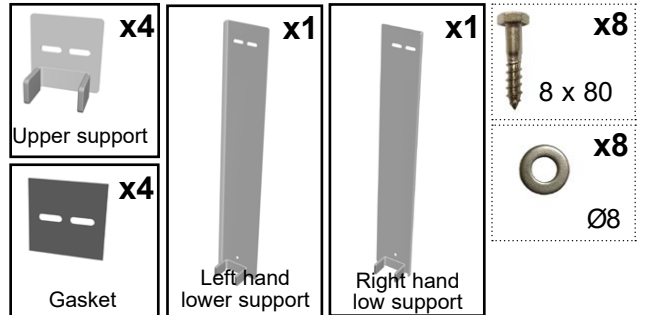

BEAM INSTALLATION

Roll-inside 1 side

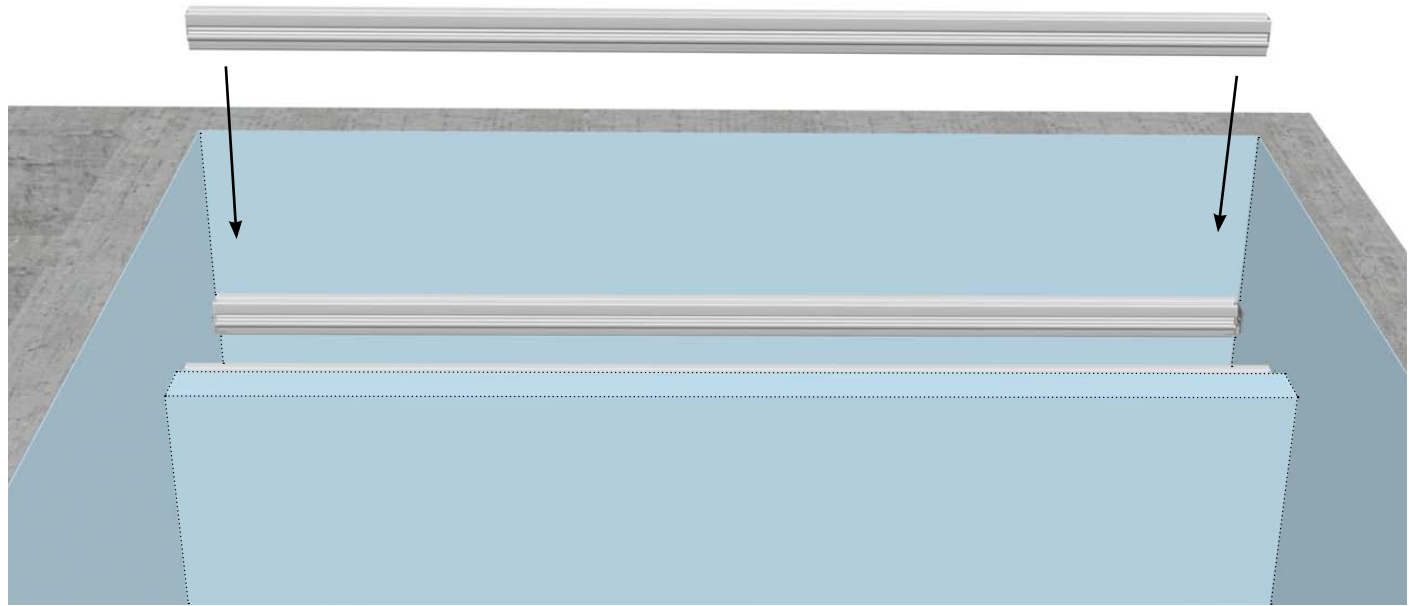
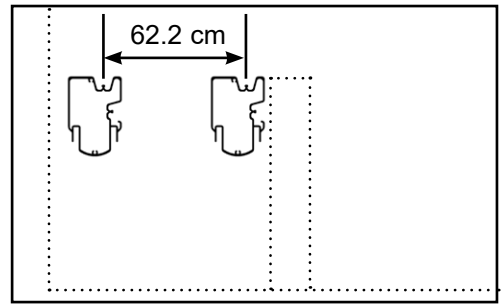
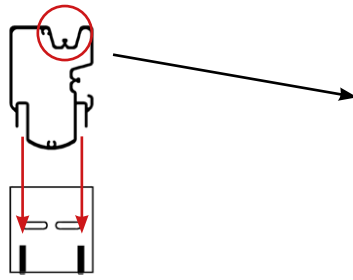
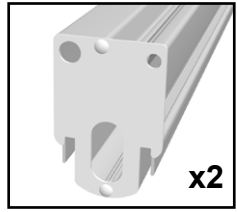

Roll-inside 2 sides

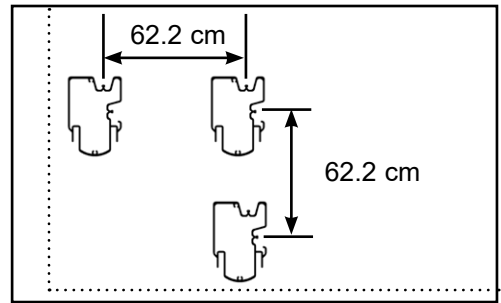
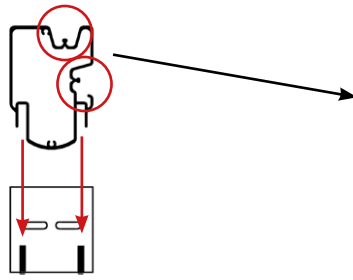
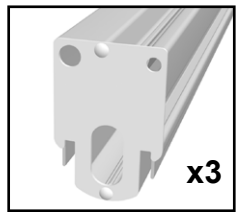

INSTALLING THE COUNTER WEIGHTS



Installation

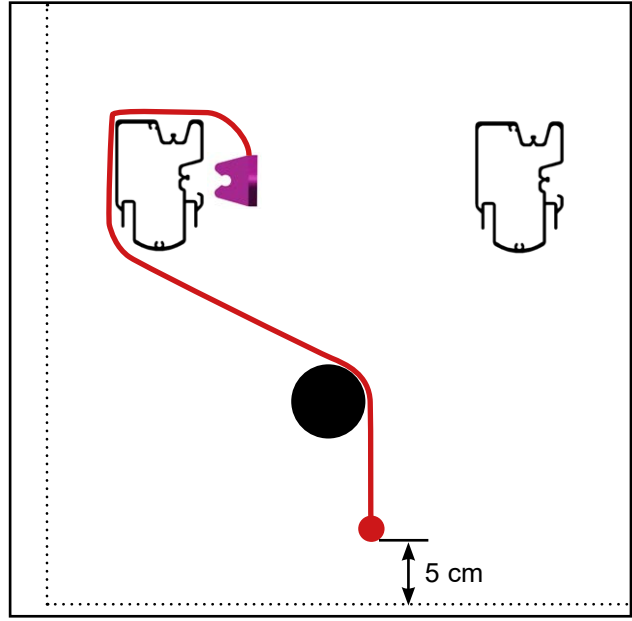
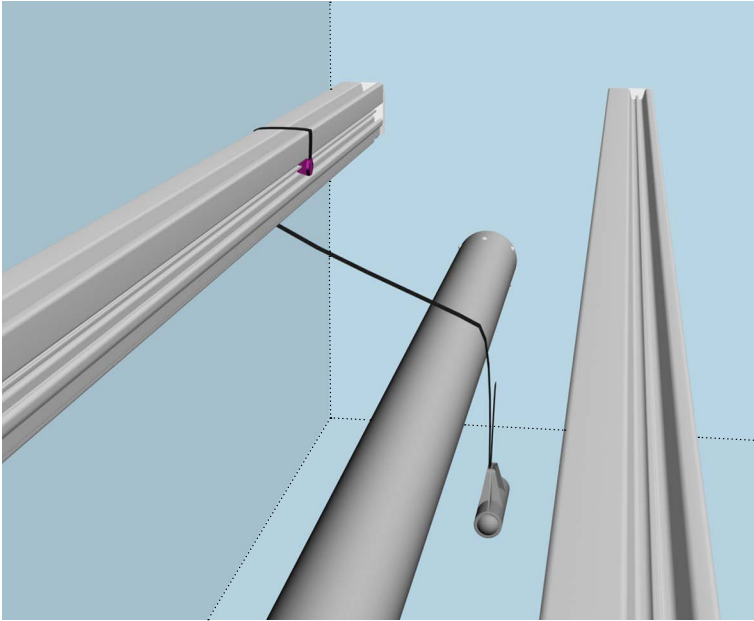

Strap adjustment

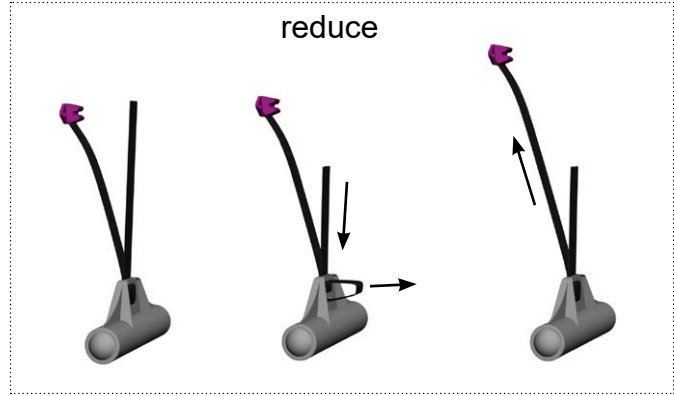
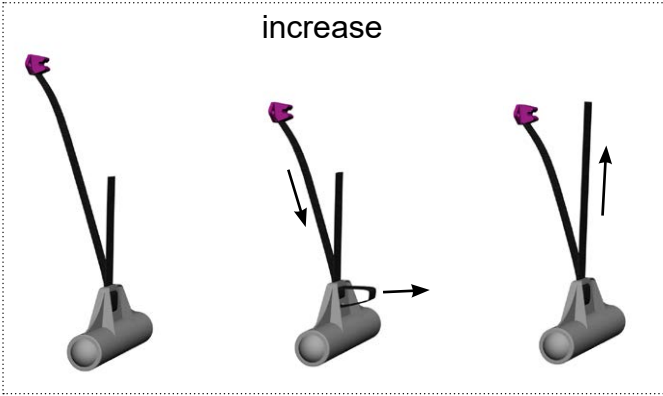

Counter-weight distribution

Pools without steps

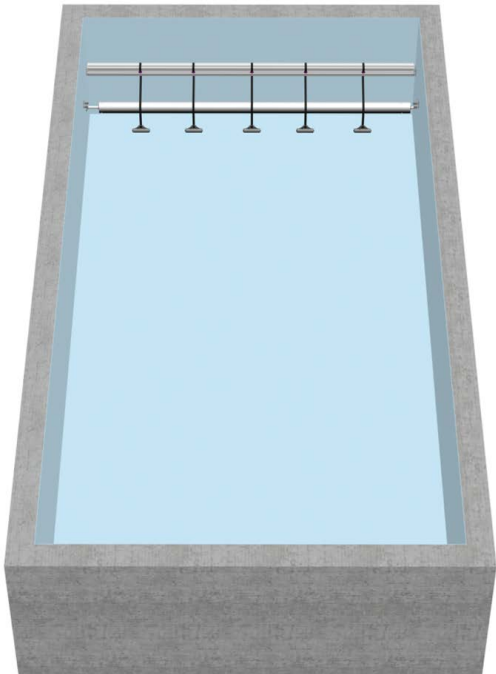

Pools with steps

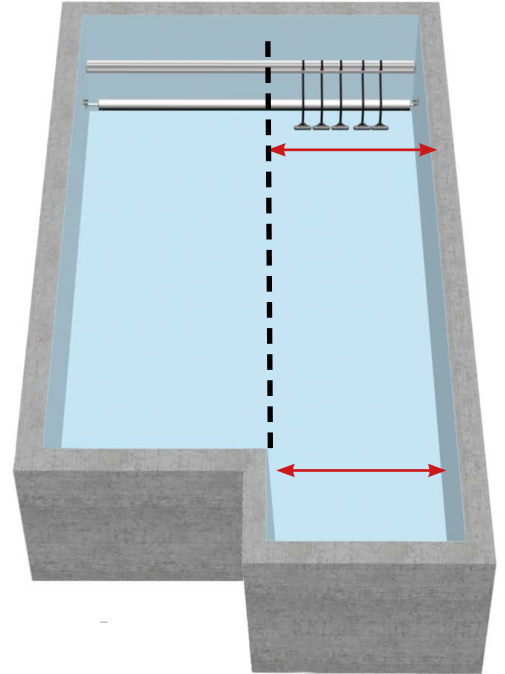

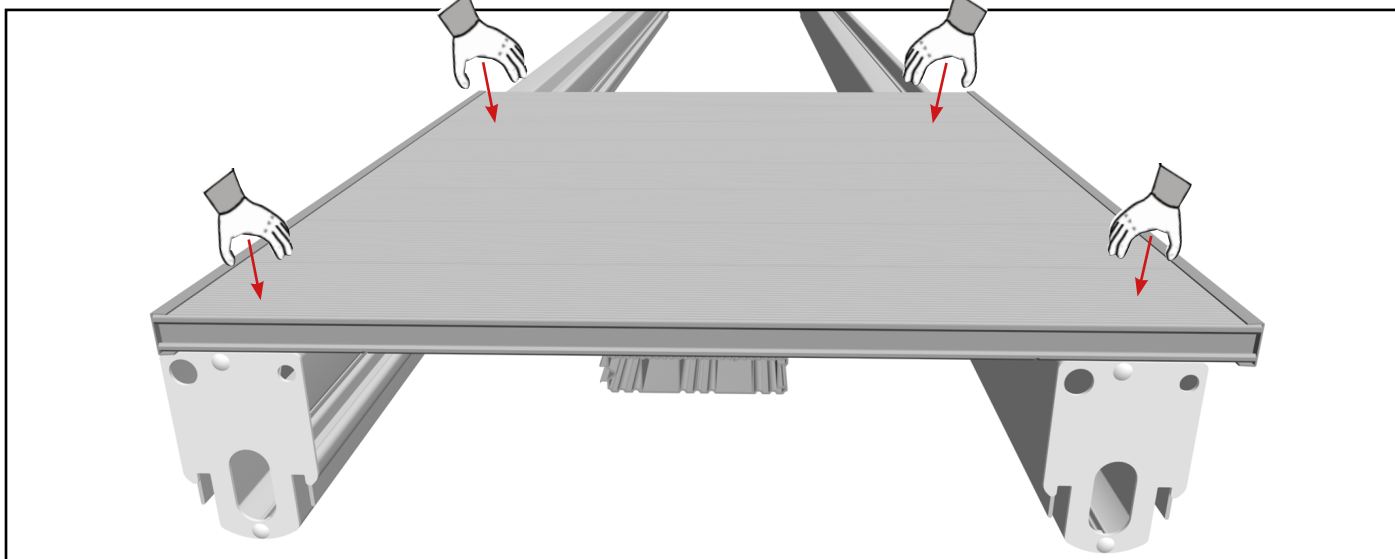
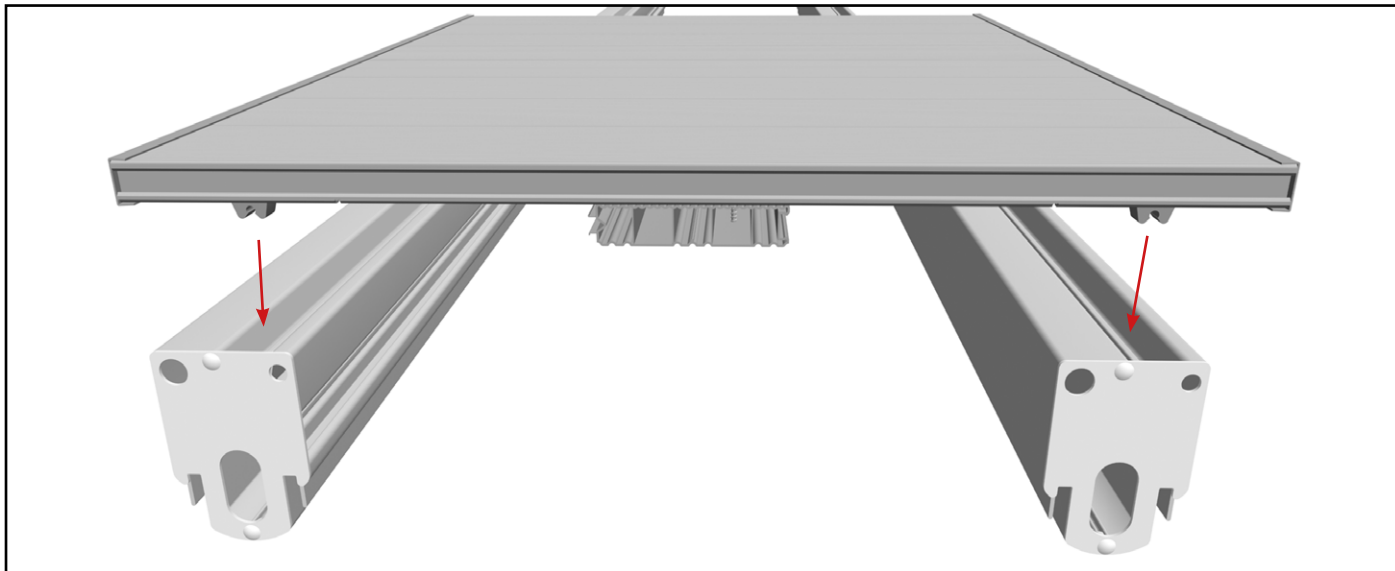

Roll-inside 1 side

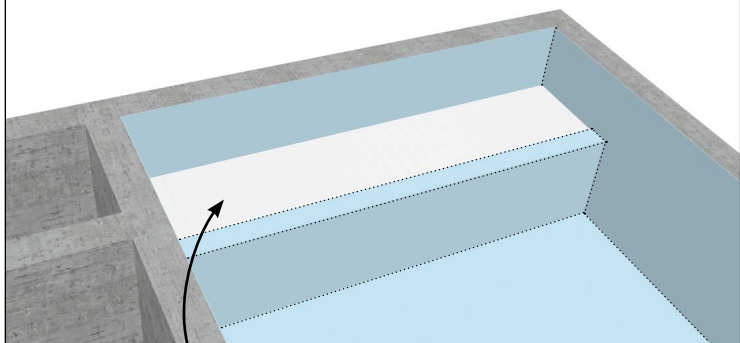

Install horizontal decking after adjusting the automatic stops on the cover

Roll-inside 2 sides

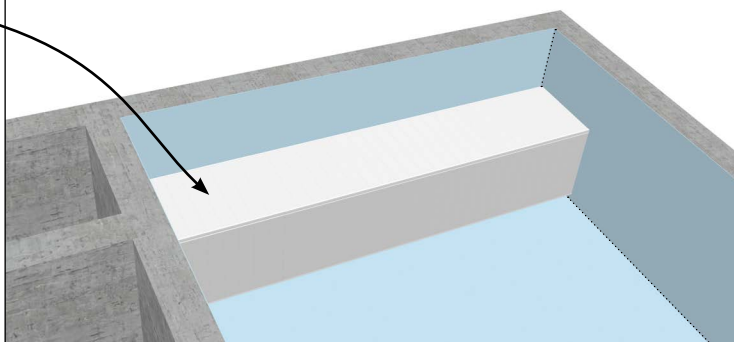

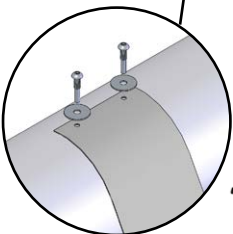
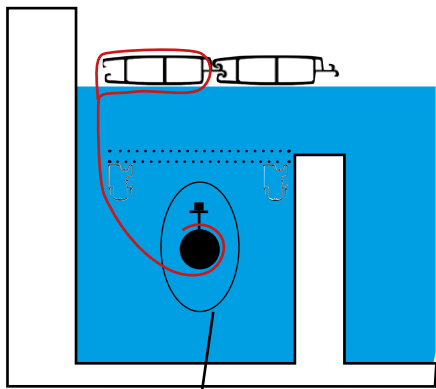

Allen Key mâle n°4

Box stickered «Début de volet»

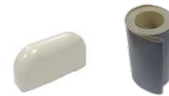

Install the slats on the water and clip them together.
Take care with the direction of the cover over the pool

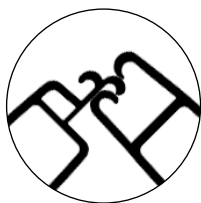
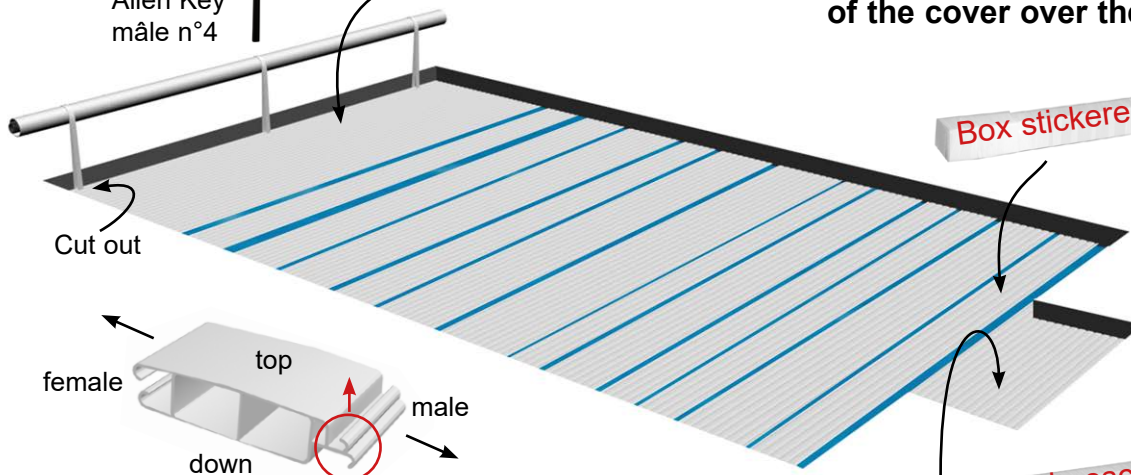

i Fit the slats along the whole length

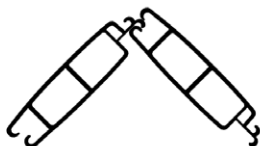
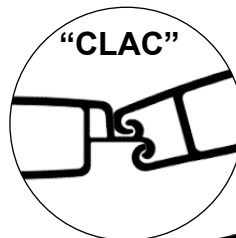

Repeated wiggling/handling of the slats may be needed..

HOW TO TAKE OFF A SLAT AND END CAPS ?

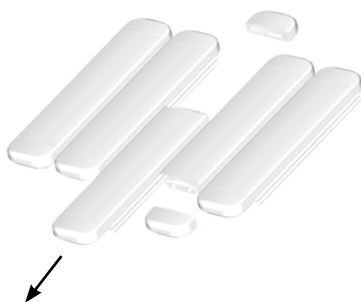
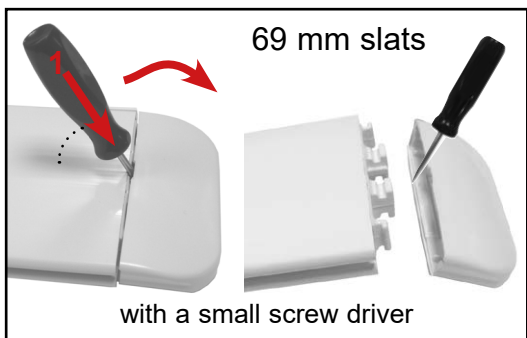

INTRODUCTION OF THE ROD

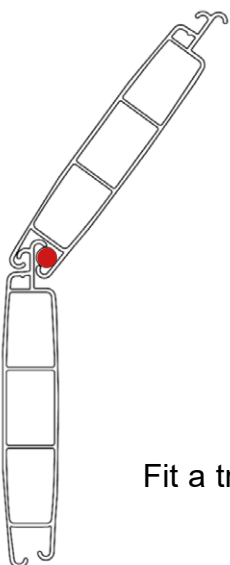
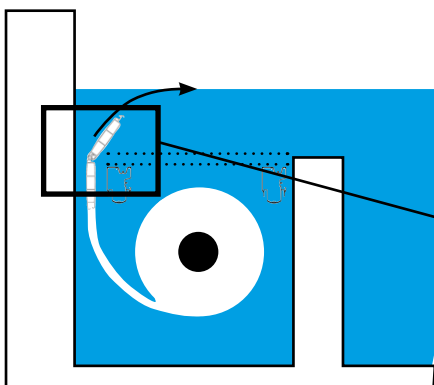

Fit a trim on each side of the first slat

ELECTRICAL DRAWING CONTROL BOX - MOTOR MCA120 / MCA250 / WI-KEY

The electric control box must be fitted in a dry room.
 The installation must comply with the NF C15-100 standard, et CEI 60364 (Last applicable version) ask your electrician for advice or contact your electricity provider.
 All our control boxes use a 230 Volt single phase (50Hz) power supply.
 The required power at the input terminals is 0.15 Kw.
 Upstream from the control box a suitably sized circuit breaker with a 30 mA ground fault device must be provided.
 For additional information, see the instructions supplied with the electrical box.

* Bornier « 15-16-17 » Pilotage de la pompe de filtration.
 Lorsque la couverture est en mouvement : Contact C-NO ouvert (stop flow) et contact C-NC fermé (go flow)
 Lorsque la couverture est à l'arrêt : Contact C-NO fermé et contact C-NC ouvert
 ** Bornier « 12-13-14 » Gestion de l'électrolyseur.
 Tableau fermé :
 Contact C-NO fermé et contact C-NC ouvert
 Tableau ouvert :
 Contact C-NO ouvert et contact C-NC fermé

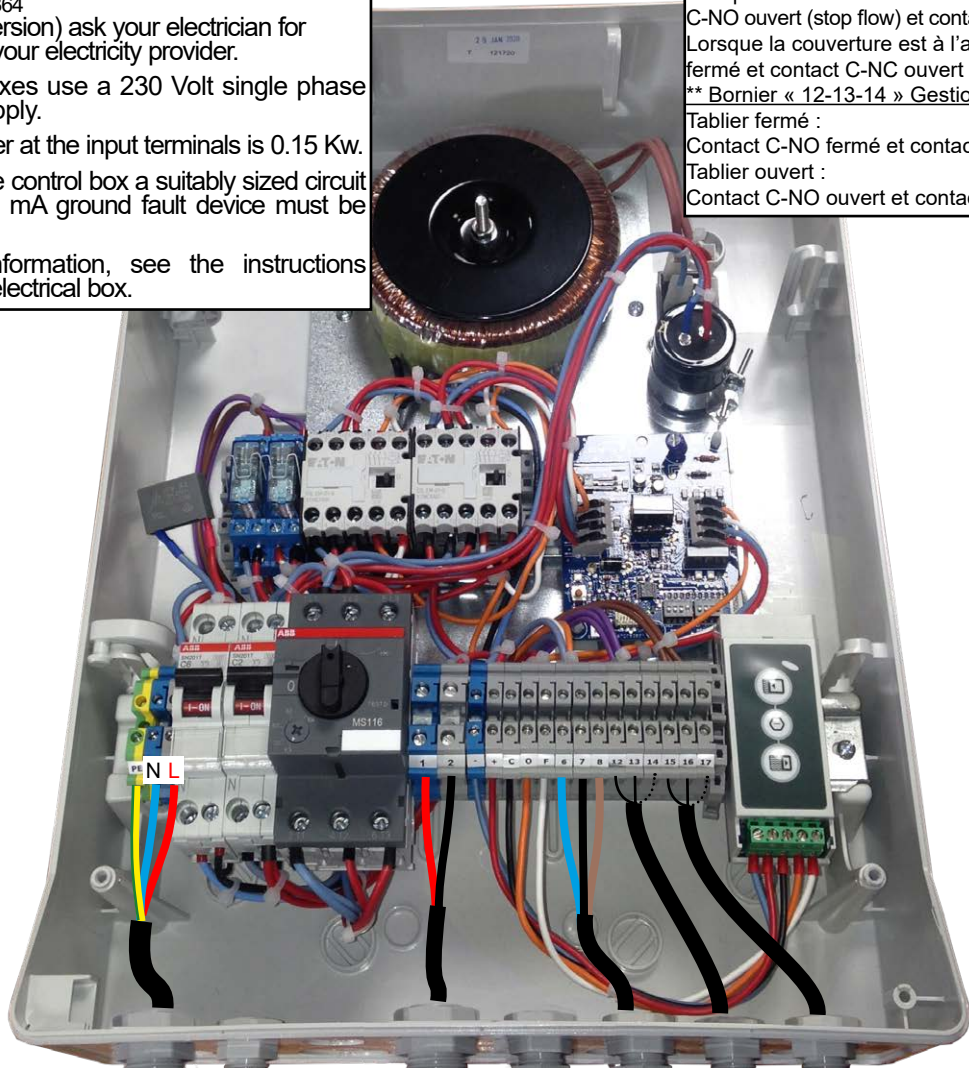

30

Circuit breaker with a 30 mA protection.



Connection
 Plug **N** and **L**
 230 VDC
 monophased 50 Hz

STOP FLOW

Salt electrolysis system

3 x 1,5 mm²

OPTION
 Connector
 see page 36



(U1000RO2V in a sheath)

- 2 x 4 mm² - until 16 m
- 2 x 6 mm² - from 16 until 25 m
- 2 x 6 mm² - from 56 until 50 m

The electric control box must be fitted in a dry room.
 The installation must comply with the NF C15-100 standard, et CEI 60364 (Last applicable version) ask your electrician for advice or contact your electricity provider.
 All our control boxes use a 230 Volt single phase (50Hz) power supply.
 The required power at the input terminals is 0.15 Kw.
 Upstream from the control box a suitably sized circuit breaker with a 30 mA ground fault device must be provided.
 For additional information, see the instructions supplied with the electrical box.

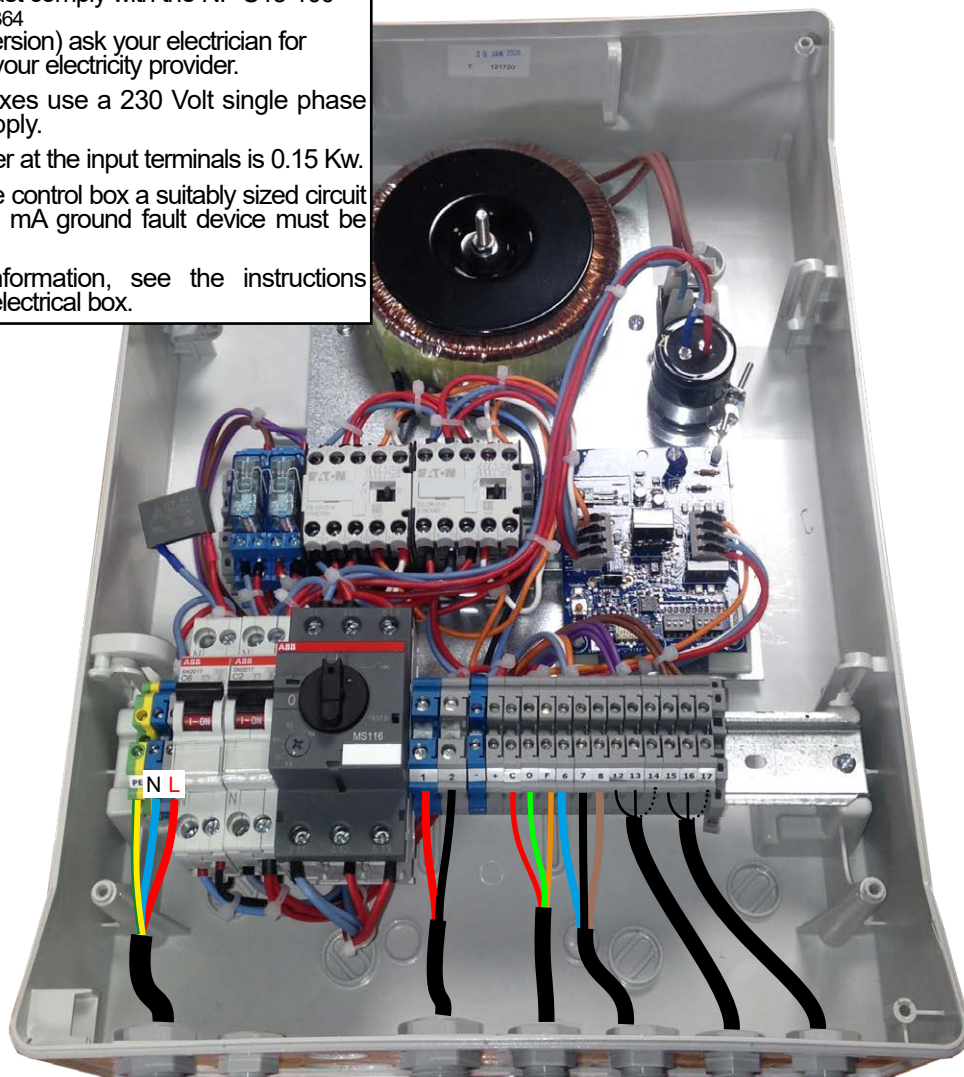

STOP FLOW

Circuit breaker with a 30 mA protection.



Connection

Plug **N** and **L**
 230 VDC
 monophased 50 Hz

Salt electrolysis system

3 x 1,5 mm²

OPTION
 Connector
 see page 36

3 x 1,5 mm²

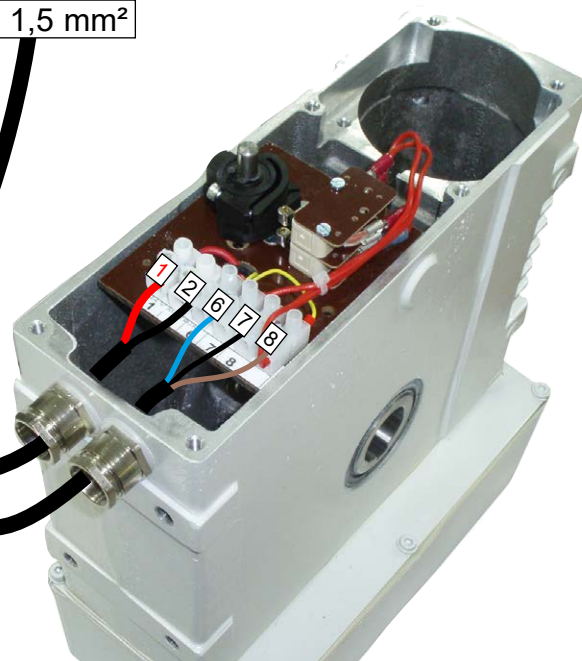

(U1000RO2V in a sheath)

- 2 x 4 mm² - until 16 m
- 2 x 6 mm² - from 16 until 25 m
- 2 x 6 mm² - from 56 until 50 m

key switch

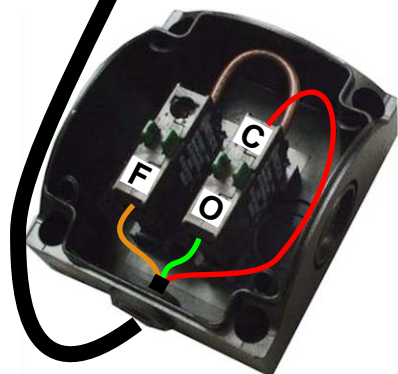

The electric control box must be fitted in a dry room.
The installation must comply with the NF C15-100 standard, et CEI 60364 (Last applicable version) ask your electrician for advice or contact your electricity provider.
All our control boxes use a 230 Volt single phase (50Hz) power supply.
The required power at the input terminals is 0.15 Kw.
Upstream from the control box a suitably sized circuit breaker with a 30 mA ground fault device must be provided.
For additional information, see the instructions supplied with the electrical box.

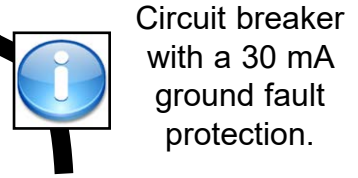
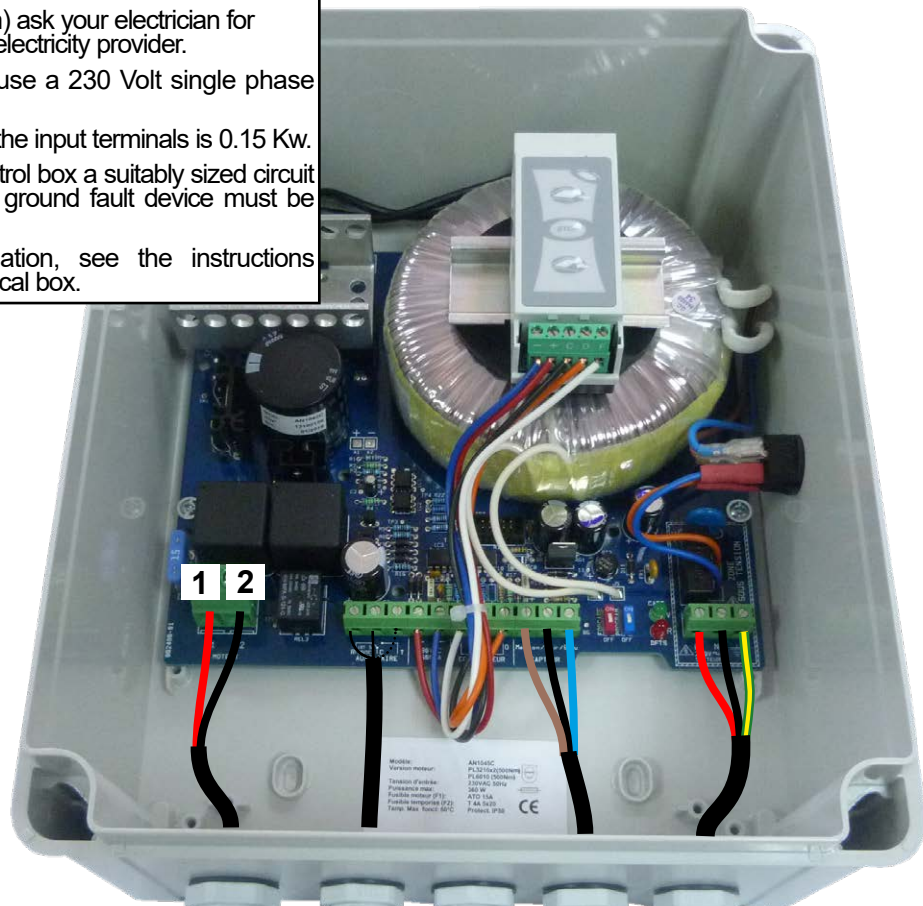

Connection
N and L plug
230 Volts
single
phased 50 Hz

3 x 1,5 mm²

OPTION
Connector
see page 36



(U1000RO2V in a sheath)

- 2 x 4 mm² - until 16 m
- 2 x 6 mm² - from 16 until 25 m
- 2 x 6 mm² - from 56 until 50 m

The electric control box must be fitted in a dry room.
 The installation must comply with the NF C15-100 standard, et CEI 60364 (Last applicable version) ask your electrician for advice or contact your electricity provider.
 All our control boxes use a 230 Volt single phase (50Hz) power supply.
 The required power at the input terminals is 0.15 Kw.
 Upstream from the control box a suitably sized circuit breaker with a 30 mA ground fault device must be provided.
 For additional information, see the instructions supplied with the electrical box.

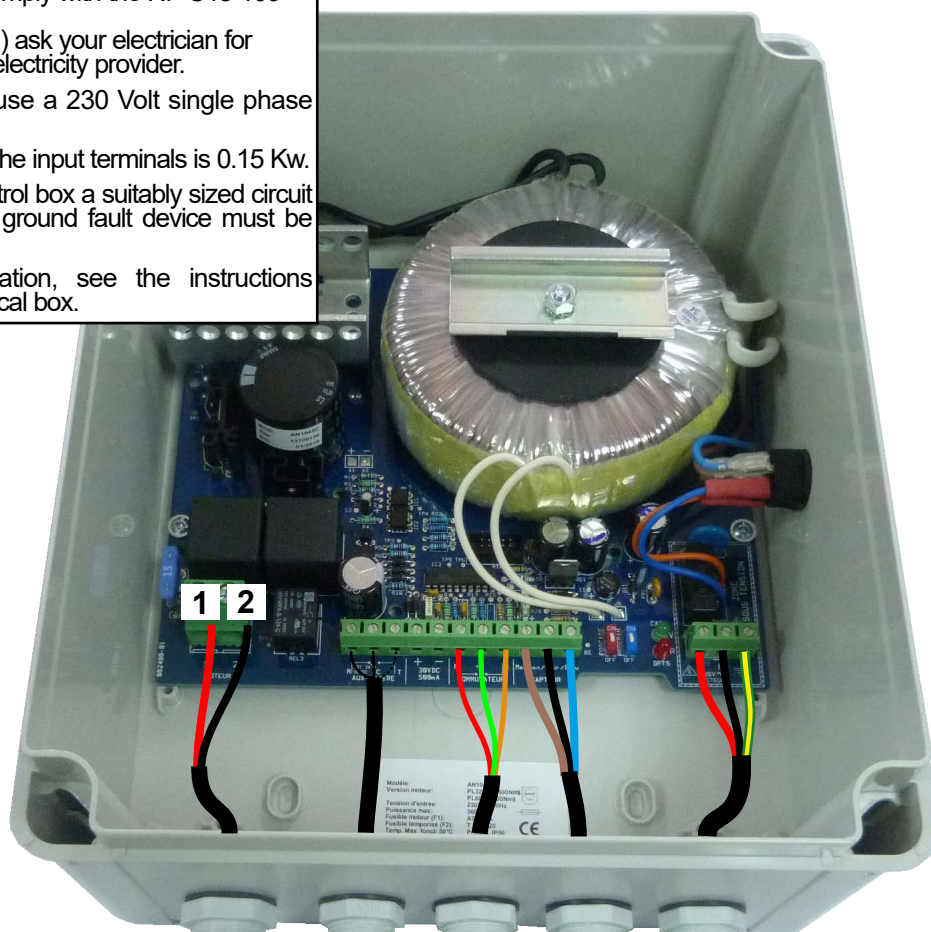

Connection
N and L plug
230 Volts
single
phased 50 Hz

3 x 1,5 mm²

Key Switch



Its location must be in a place from which it is possible to check that no one enters the pool during the manoeuvre.

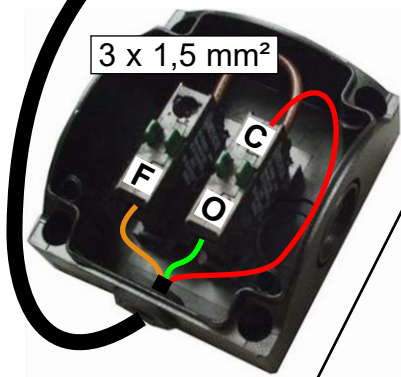

*OPTION
 Connector
 see page 36*



(U1000RO2V in a sheath)

- 2 x 4 mm² - until 16 m
- 2 x 6 mm² - from 16 until 25 m
- 2 x 6 mm² - from 56 until 50 m

ELECTRICAL WIRING WITH KEY OPERATED BOX

The electric control box must be fitted in a dry room.
 The installation must comply with the NF C15-100 standard, et CEI 60364 (Last applicable version) ask your electrician for advice or contact your electricity provider.
 All our control boxes use a 230 Volt single phase (50Hz) power supply.
 The required power at the input terminals is 0.15 Kw.
 Upstream from the control box a suitably sized circuit breaker with a 30 mA ground fault device must be provided.
 For additional information, see the instructions supplied with the electrical box.

Relay «PUMP» Pilots the filtration pump.
 When operating the AutoCover: C-NO contact open (stop filtration) and closed C-NC contact (filtration)
 Relay «SALT» Electrolysis Management.
 AutoCover closes the Pool: C-NO contact closed and C-NC contact open
 AutoCover opens Pool: C-NO contact open and C-NC contact closed
 The dry contact is memorized when the cabinet is switched off.

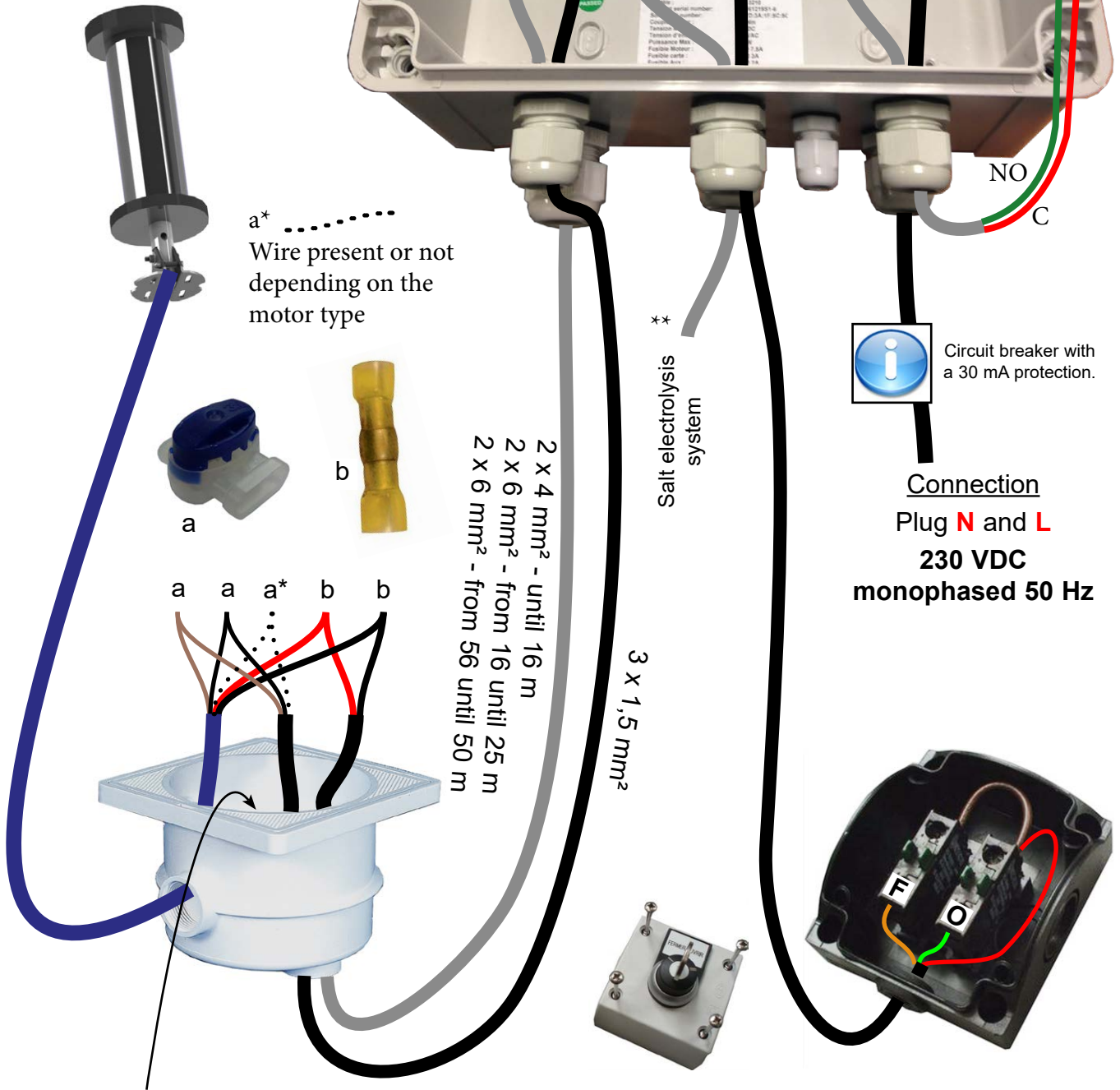
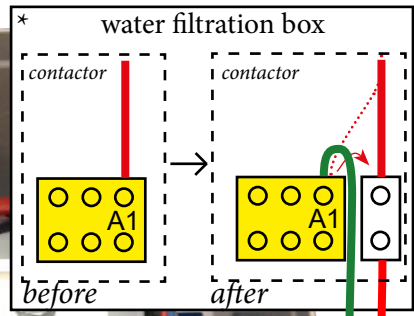
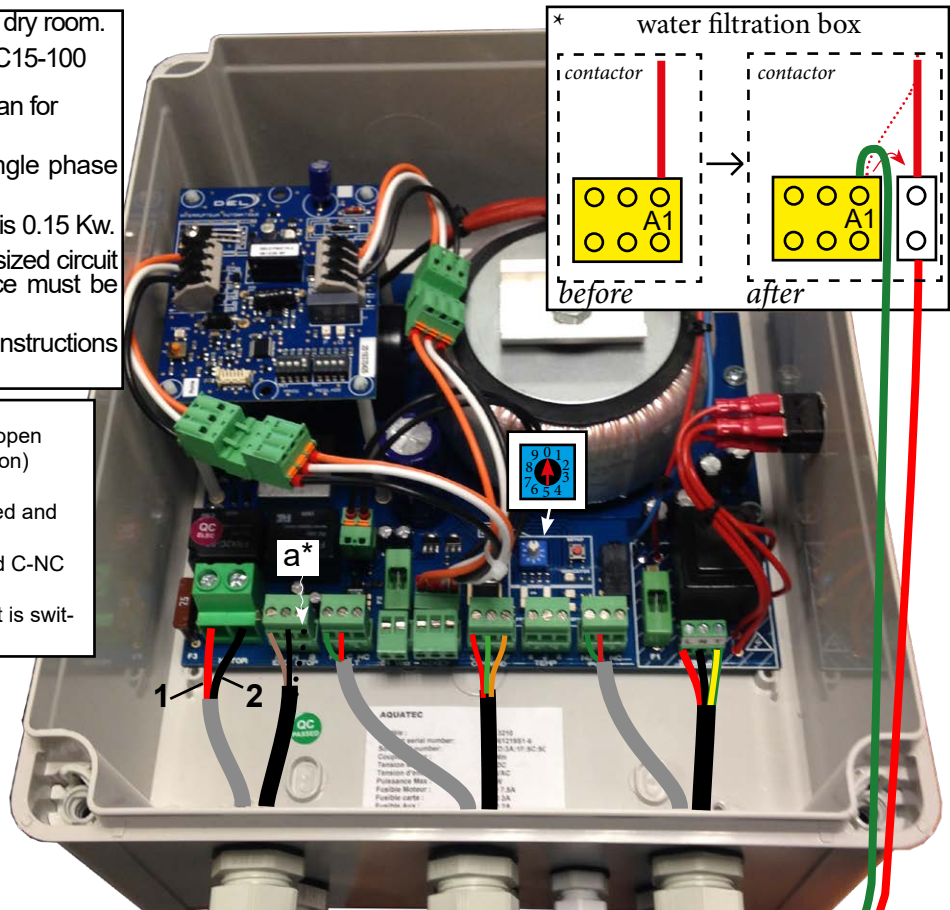

We recommend applying sealing gel in the connection box after having completed the wiring.

ELECTRICAL WIRING / WI-KEY

The electric control box must be fitted in a dry room.

The installation must comply with the NF C15-100 standard. et CEI 60364

(Last applicable version) ask your electrician for advice or contact your electricity provider.

All our control boxes use a 230 Volt single phase (50Hz) power supply.

The required power at the input terminals is 0.15 Kw.

Upstream from the control box a suitably sized circuit breaker with a 30 mA ground fault device must be provided.

For additional information, see the instructions supplied with the electrical box.

Relay «PUMP» Pilots the filtration pump.

When operating the AutoCover: C-NO contact open (stop filtration) and closed C-NC contact (filtration)

Relay «SALT» Electrolysis Management.

AutoCover closes the Pool: C-NO contact closed and C-NC contact open

AutoCover opens Pool: C-NO contact open and C-NC contact closed

The dry contact is memorized when the cabinet is switched off.

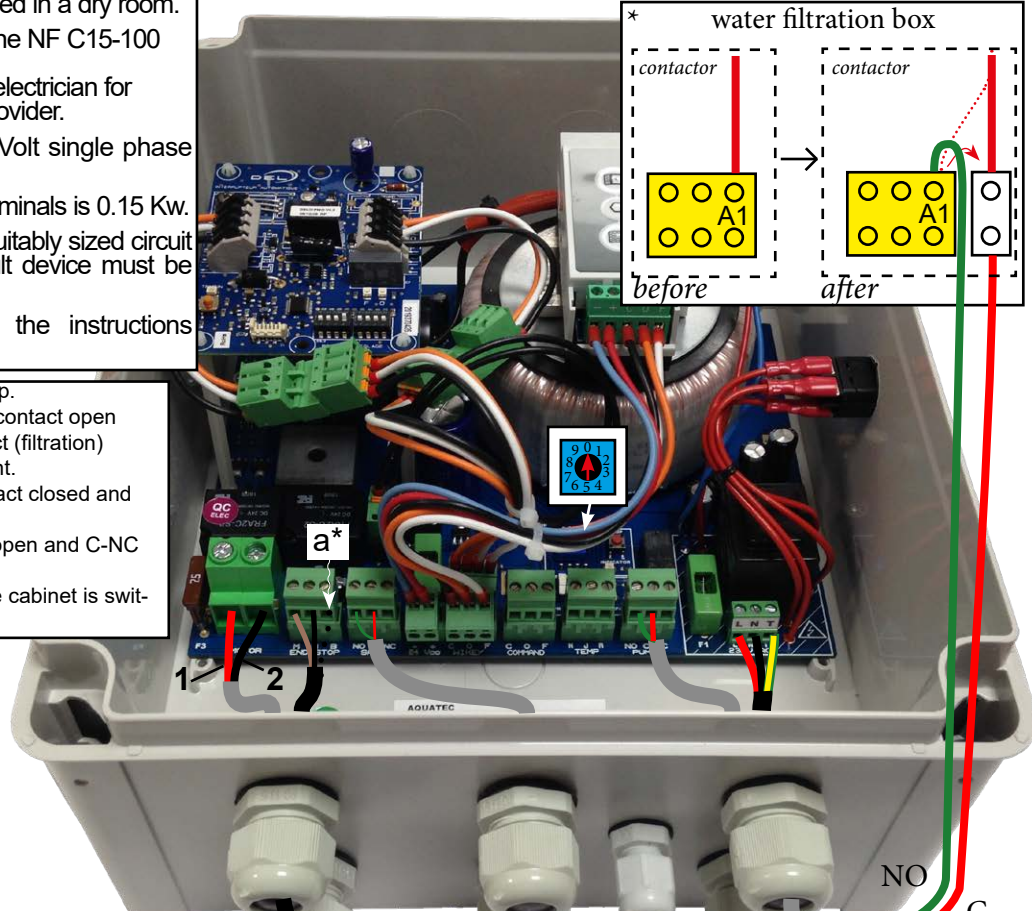
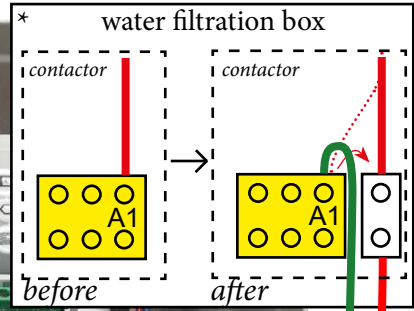

a*
Wire present or not depending on the motor type

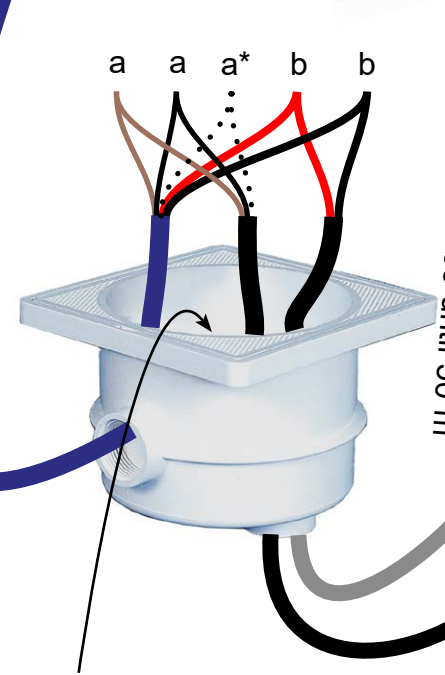
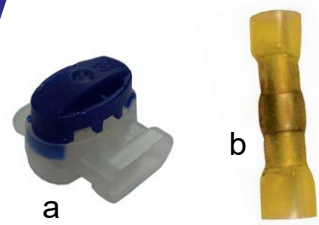

2 X 4 mm² - until 16 m
2 X 6 mm² - from 16 until 25 m
2 X 6 mm² - from 56 until 50 m

3 X 1,5 mm²

**
Salt electrolysis system



Circuit breaker with a 30 mA protection.

Connection
Plug **N** and **L**
230 VDC
monophased 50 Hz

We recommend applying sealing gel in the connection box after having completed the wiring.

ELECTRICAL DRAWING ELECTRICAL PLUG - OPTION



Located between the motor and the control panel, allows to unplug the motor without dismantling it
For winterizing, replace the motor by the winterizing handle

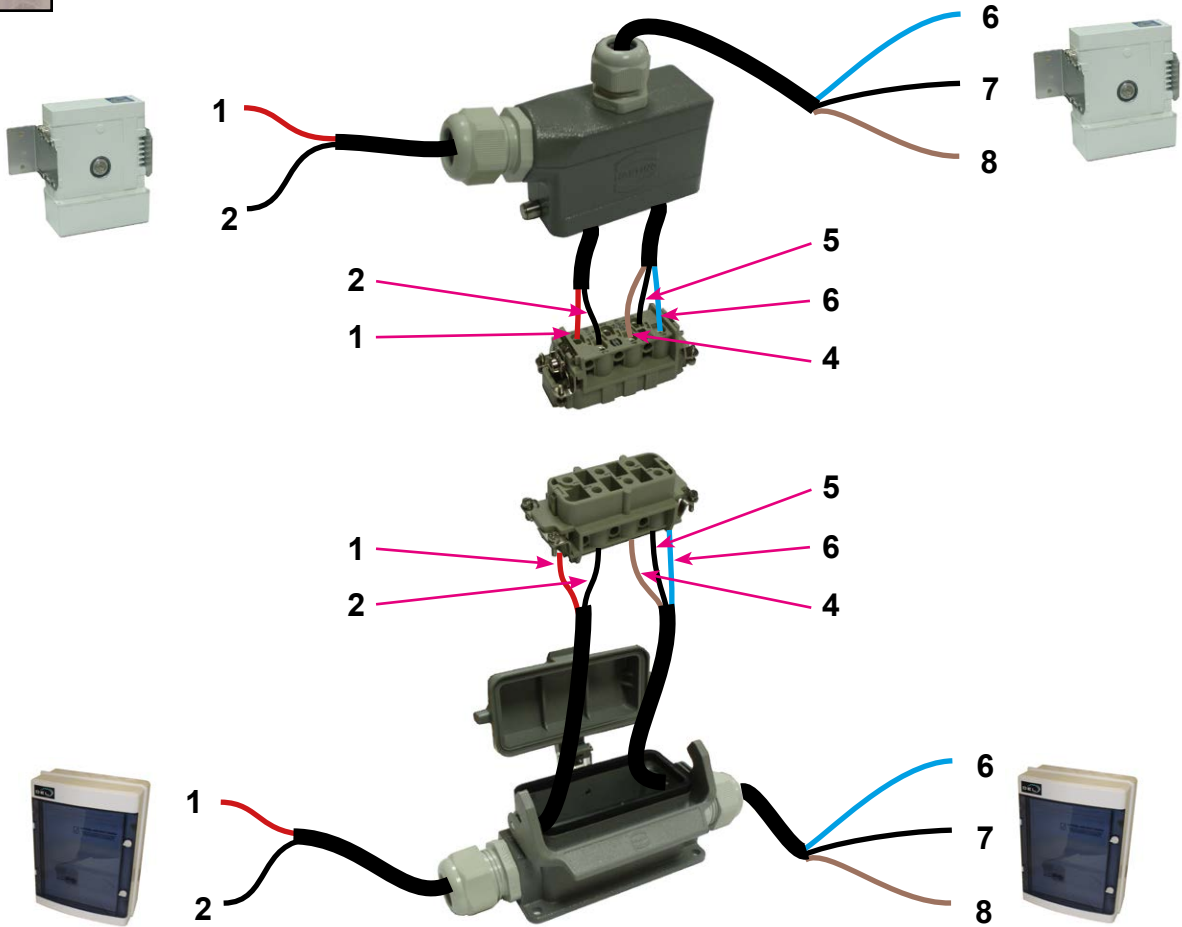

WI-KEY INSTALLING THE CONTROL BOX



red / green flashing = emitter locked
Emitter unlocking procedure see «page 48»

The emitter must be located outside volume 0.

The distance between the emitter and the receiver must not exceed:

- 50 m in an obstacle-free zone.
- 25 m behind a basic wall.
- 15 m behind several walls or an especially thick wall.

we recommend checking emitter/receiver communication before fixing permanently.



- It must be located in a place from which it is possible to check that no one enters the pool during the manoeuvre.
- It is mandatory to install the locking «strip».
- Before fixing the control box, check that the emitter is communicating with the receiver.

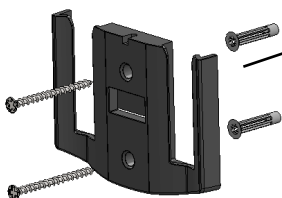

The support must be attached to a fixed support



Closing

Opening



Keyboard lock



Stops the current action

1 Checking of the automatic stop position

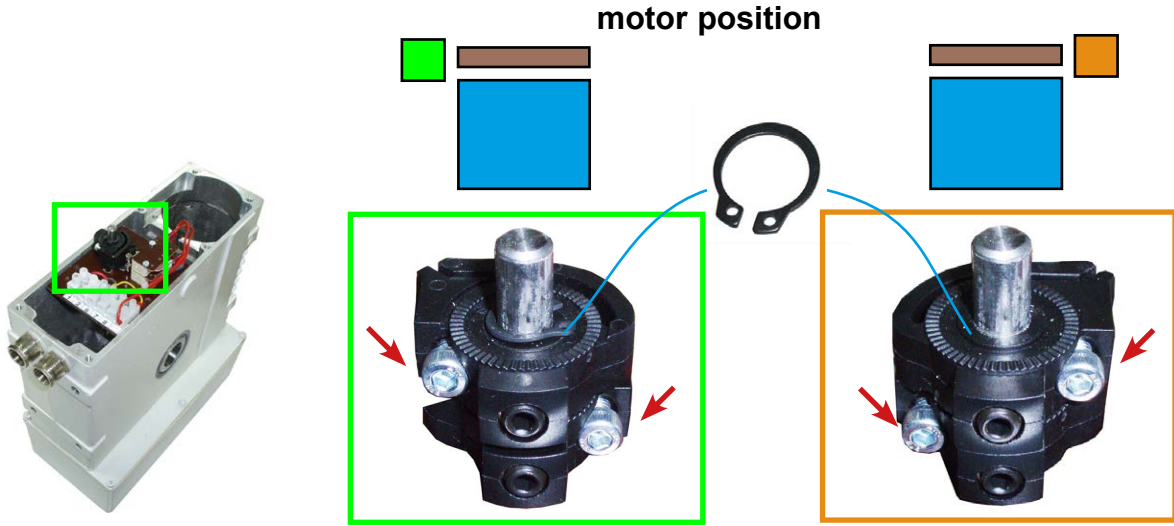

2 Untighten the cam screws

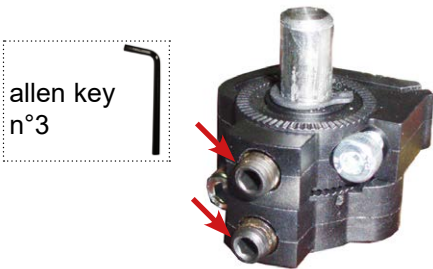

3 Close the electronic card

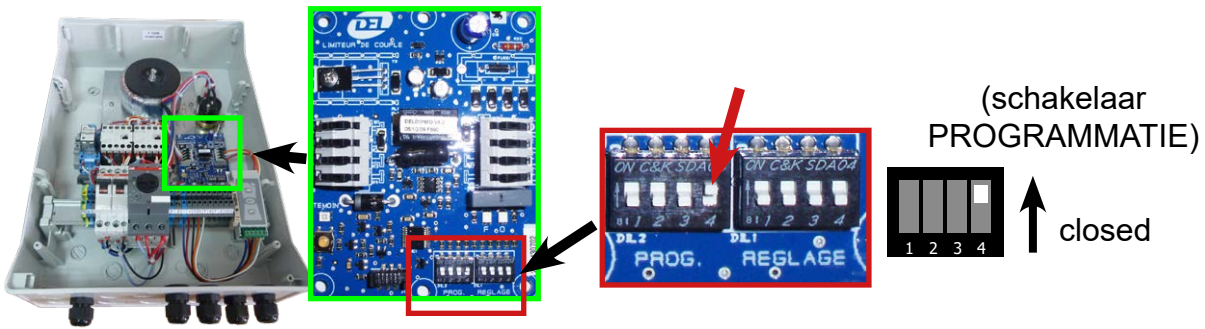

4 Checking of the roll in roll out direction

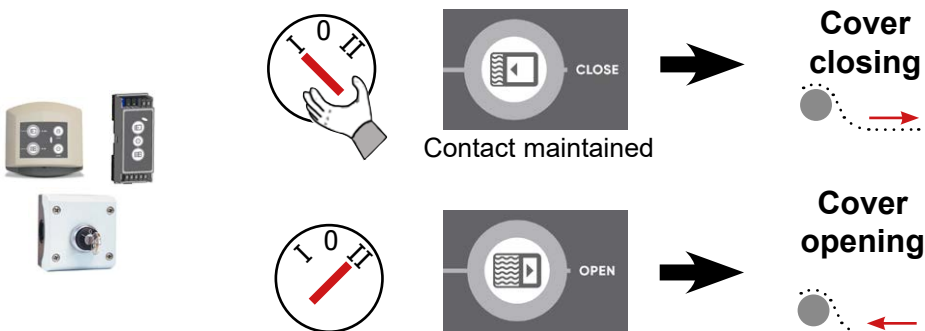

if the control logic is incorrect, Check the wiring installation

5

Cover installation «open pool»



Adjust the position of the cover using the programme «open and closed»



Be careful to choose the right position, it will be the starting reference.

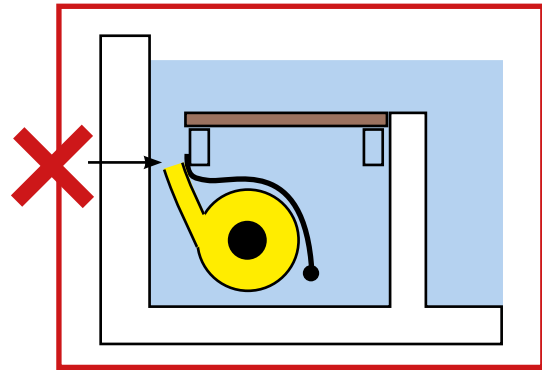
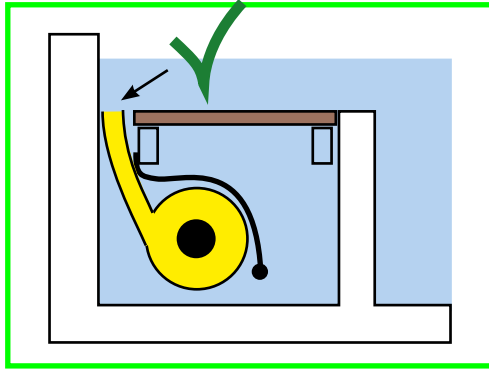

38

6

Recording position «open pool»

Allen key
n°3

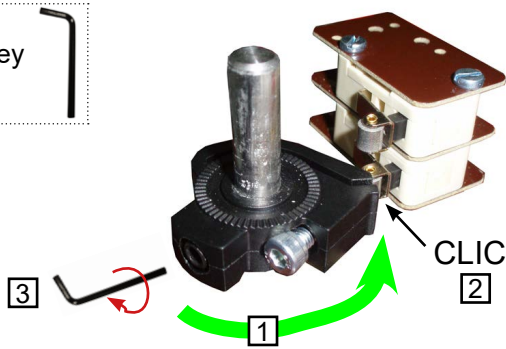

or

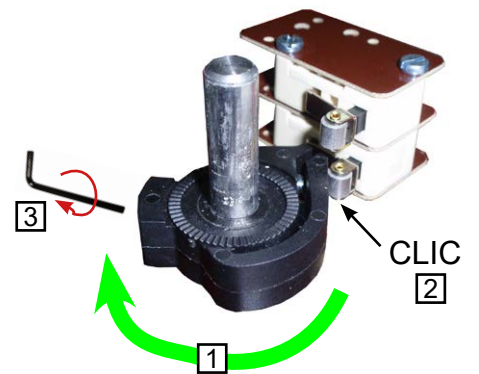

Cover installation «closed pool»



Adjust the position of the cover using the programme «open and closed»

7

Be careful : the last operation used must be a closing.

«if you cannot close the cover, chek the electric control is correct and start the automatic stop ajustement procedure from the deginning. »

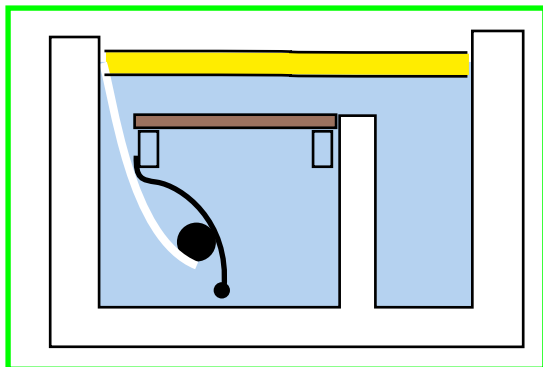

39

Recording position «closed pool»

Allen key n°3

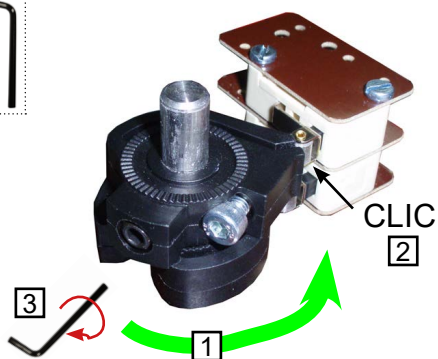

or

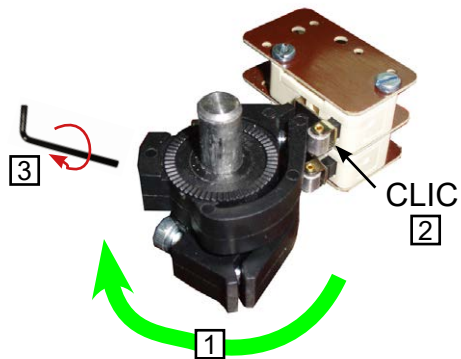

Automatic stop adjustment

8

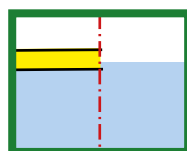
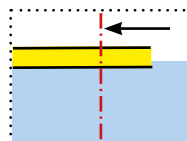
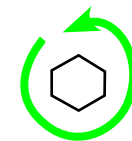
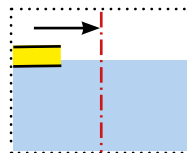
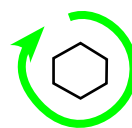
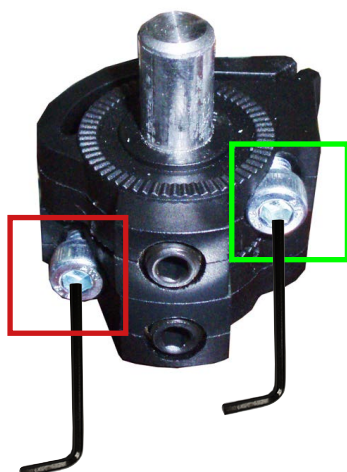
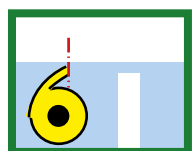
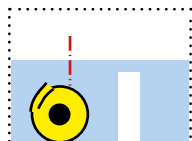
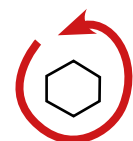
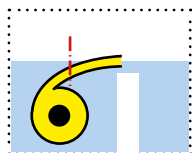
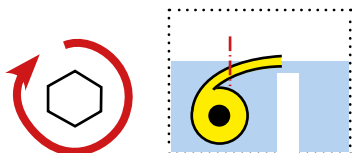

1

1 - Programme starting :

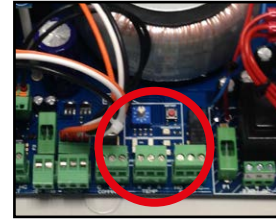
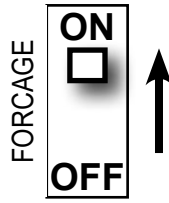
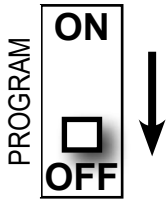

2

check up



Cover closing



Cover opening



if the control logic is incorrect, Check the wiring installation

40

3

Cover installation «open pool»



Adjust the position of the cover using the programme «open and closed»

Be careful to choose the right position, it will be the starting reference.

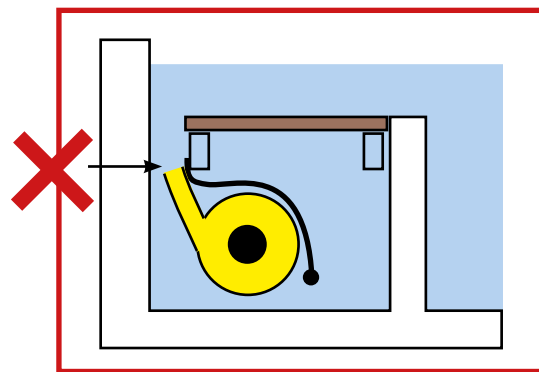
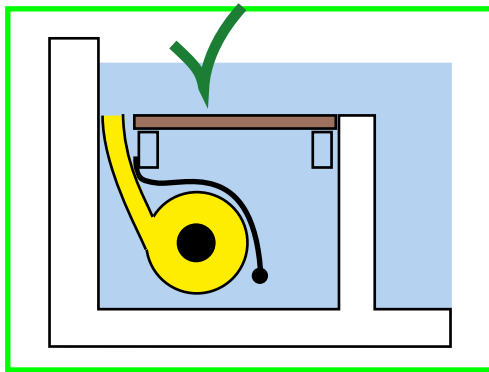

4

Recording position «open pool»

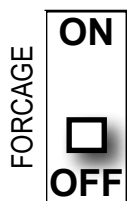
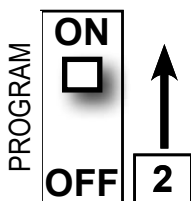

5

Cover installation «closed pool»



Adjust the position of the cover using the programme «open and closed»

Be careful : the last operation used must be a closing.

«if you cannot close the cover, chek the electric control is correct and start the automatic stop adjustment procedure from the deginning. »

If the motor does not run, the red led is off and the key switch cables are properly connected, invert the polarity of the motor cables

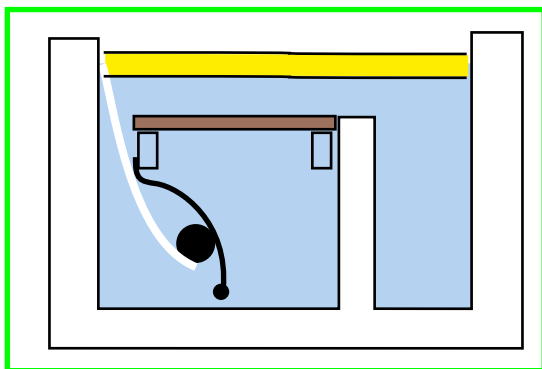

6

Recording position «closed pool»

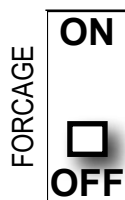
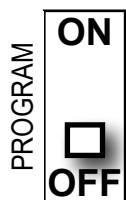

7

Automatic stop adjustment is over.

TORQUE LIMITER DEVICE

INFORMATIONS

The torque limiter device protects the system in case locking kits are unreleased during the opening.

In the event of excessive resistance during opening the sotor is automatically stopped.

Cases of torque limiter activation :

- Unreleased safety locking kit.
- cover rudding (coping stone...)
- Object wedged on / under the cover (cleaner ...).

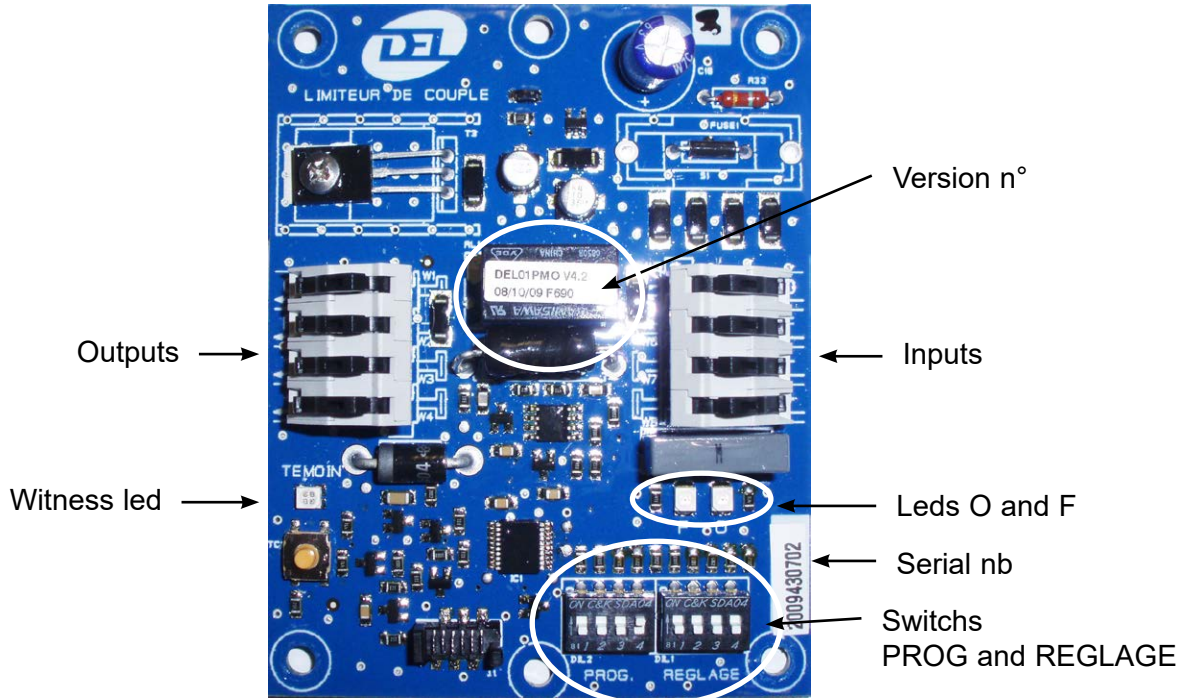

TORQUE LIMITER DEVICE CONTROL CHECKING

- Close the electronic card



(Switch PROG)



- Check:

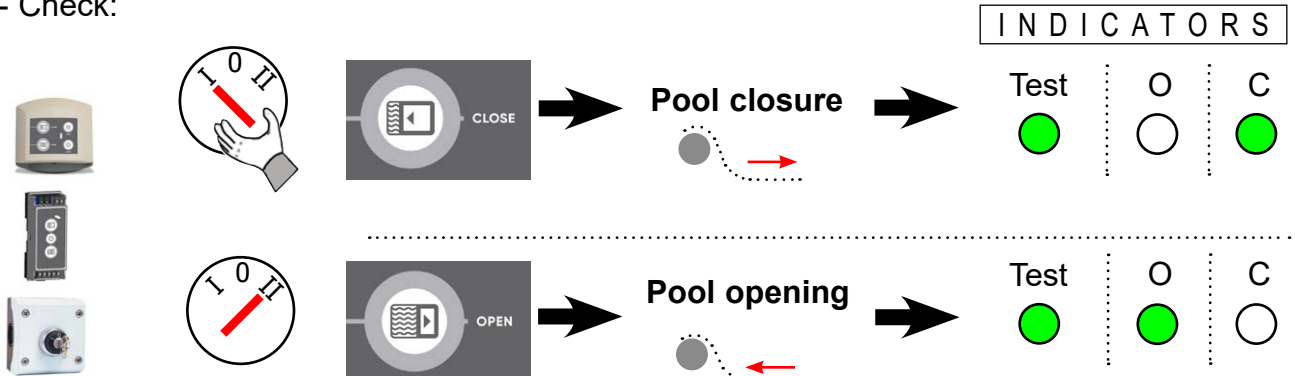

If the key switch is incorrectly wired refer to page 15.

CARD ADJUSTMENT (SWITCH REGLAGE)

Immersed motorisation



Dry pit motorisation



CONTROL TIME ADJUSTMENT (SWITCH REGLAGE)

L = pool length step unit included

$L \leq 12$ m



30 seconds

$L > 12$ m



60 seconds



ADJUSTEMENT OF THE SENSITIVITY (SWITCH PROG)

l = pool width

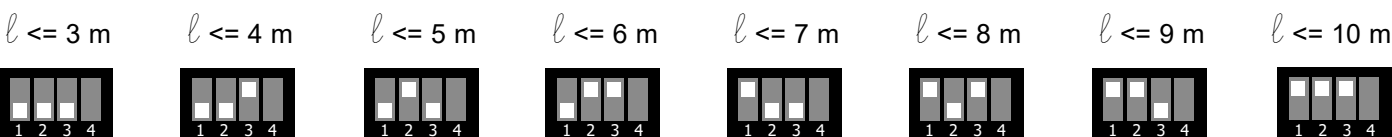

← maximum sensitivity ----- minimum sensitivity →



ACTIVATION (SWITCH PROG)

Open



If you do not activate the torque limiter device, serious damages might happen on the motor, the electric control box, the slats, and the guarantee might not be applicable.



IMPORTANT

Contact maintained more than 3 secs

=

The next opening will be protected



+ 3 seconds

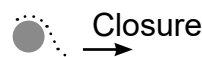

Contact maintained less than 3 seconds

=

The next opening will not be protected



- 3 seconds

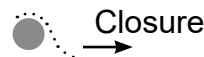

TESTER

A - Block the cover by hand or with safety kits and open the cover.

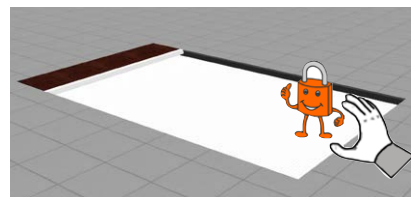

=> The motor is automatically stopped

(If necessary adjust the sensitivity of the switch activation)



in the event of an unexplained activation, reduce the sensitivity level by selecting the setting for the next width up.

Activated card	Witness	
	O	F
Opening, control in progress		
Opening without control		
Closing		
Protection ON		

Push-lock

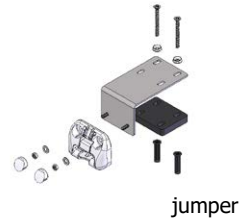
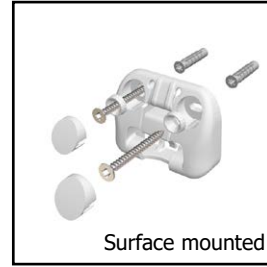
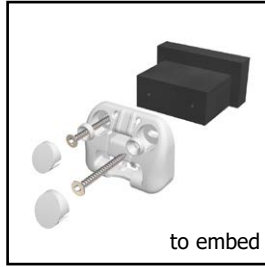

FASTENER KIT POSITIONING RULES

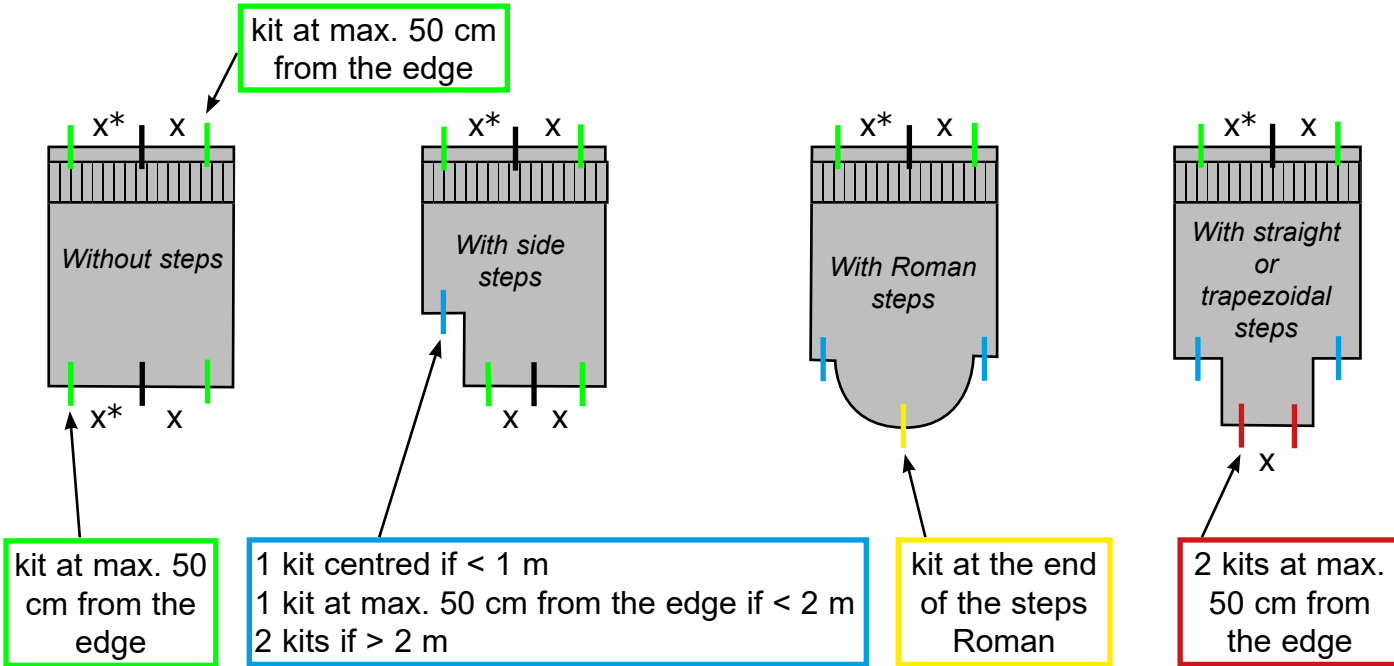

44



* X must never exceed 2 m

The position of the fastener kits on the cover is indicated on the drawings shipped with the slats.

All changes to the positioning of the kits must comply with the rules given above. For other cases please contact us.

A water level regulator is mandatory

Insert mounted model

For concrete and panel pools

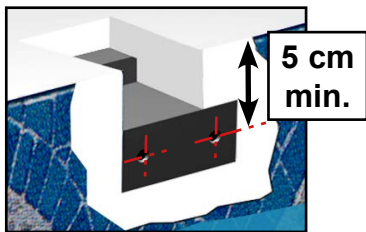

5 cm min.

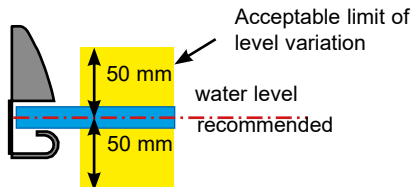

Acceptable limit of level variation

water level recommended

VBA TF Torx stainless steel A4 Ø6 x 50 wood screw

Hollow white Ø16 washer

Inserted part

Screw cap

Hang mounted version

For concrete and panel pools

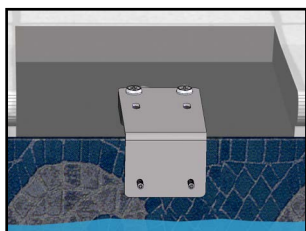

Ø8

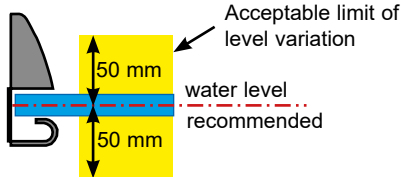

Acceptable limit of level variation

water level recommended

VBA TF Torx stainless steel A4 Ø6 x 50 wood screw

Hollow white Ø16 washer

Hang mount support

Cale 13 mm

Stainless steel nut A4 M10

Ø12 Nylon plug

Screw cap

Surface mounted model

For concrete and concrete block pools, as well as pools with wall thickness greater than or equal to 8 mm

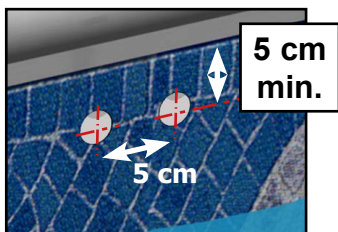

5 cm min.

5 cm

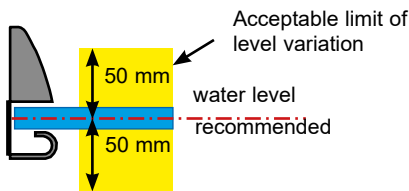

Acceptable limit of level variation

water level recommended

VBA TF Torx stainless steel A4 Ø6 x 50 wood screw

Hollow white Ø16 washer

Universal 8 x 40 plug

Screw cap

Concrete

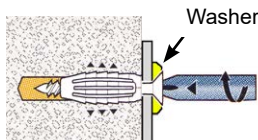

Once the resistance point has been reached stop screwing, this would deteriorate the fixture quality.

Concrete block

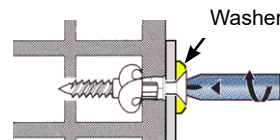

After reaching the resistance point, make 3 more turns of the screwdriver to finish tightening.



Ø8

60 mm "minimum"

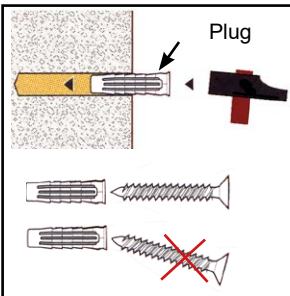

Plug

OPENING/ CLOSURE OF THE POOL

**ALWAYS KEEP AN EYE ON THE POOL DURING OPENING OR CLOSING OPERATIONS.
ALWAYS CHECK THAT THE POOL WATER LEVEL IS CONSTANT AND COMPLIANT WITH THE
RECOMMENDATIONS ON THE INSTRUCTIONS**

- It is imperative not to halt the cover in an intermediate position, this can cause the risk of jamming a bather's body under the cover casing, if a bather uses the pool.
- When using an automatic cleaner under the cover, check that the hose does not affect the movement of the slats when opening and closing the cover.
- It is essential to remove floating objects when opening and closing the cover.
- Do not block the cover while extending or retracting.
- Do not activate the automatic cover when it is iced in.
- The opening or closure operation requires about 2 minutes for one person and about 3 minutes to lock or unlock the attachment kits.

Opening: Always release the cover before starting the motor.

- Unlock all the fastening systems.
- Operate the open control.
- Stow the unlocking tools out of the reach of children.
- Lock the WI-Key command



Closure:

- Operate the «contact maintained during closure» close control
- Lock all the fastener systems.
- Stow the unlocking tools out of the reach of children.
- Lock the WI-Key command



Never place products that were not designed for the purpose on slat covers, as this may warp the slats. Never leave objects on the cover (towels, buoys, etc.) because, in direct sunlight, the slats would be locally expanded and the warranty would be void. «Solar polycarbonate slats are incompatible with bromine treatments and treatments containing bromine. Do not put undiluted chemical products in direct contact with solar polycarbonate slats (e.g. algae protection products). It is essential to first carry out a test on a small surface area.»

IMPORTANT

When closing the pool, it is essential to KEEP THE CONTROL PRESSED FOR AT LEAST 3 SECONDS. This is required to guarantee automatic obstacle detection the next time the cover is opened.

LOCKING THE WI-KEY

- Press on for more than 3 seconds until the pilot flashes

= system locked

UNLOCKING THE WI-KEY

- Press on and keep it pressed.
- At the same time: successively press the following 3 keys:
- The pilot remains on = emitter unlocked

LIGHT INDICATORS

When you press a key, the light indicators below provide information on the Wi-key status (locked/unlocked), as well as the battery charge level.

	Green LED	----->	Wi-key unlocked
	Red/green flashing LED	----->	Wi-key locked
	Orange LED	----->	Battery level low
	Red LED	----->	Change the batteries (2 x LR03)

LOCKING AND RELEASING PUSH-LOCK

Locking

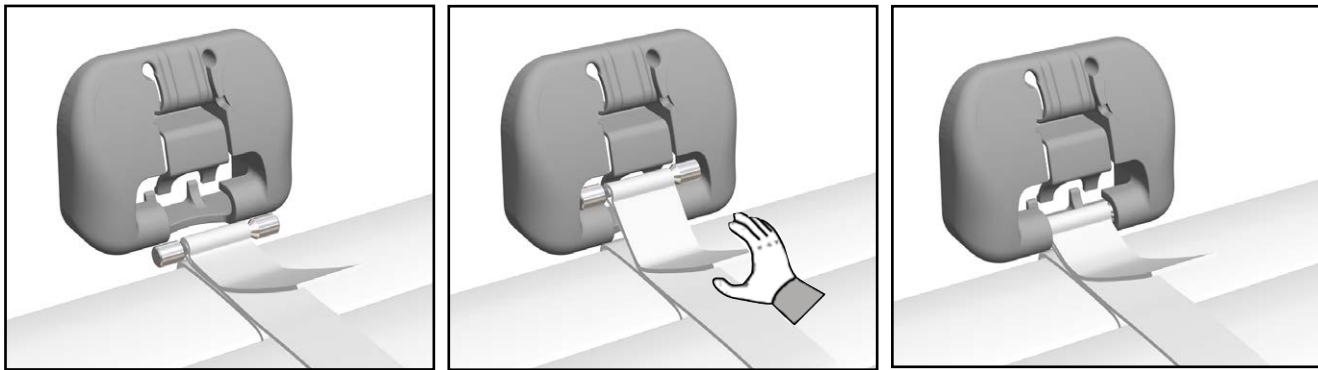

Releasing

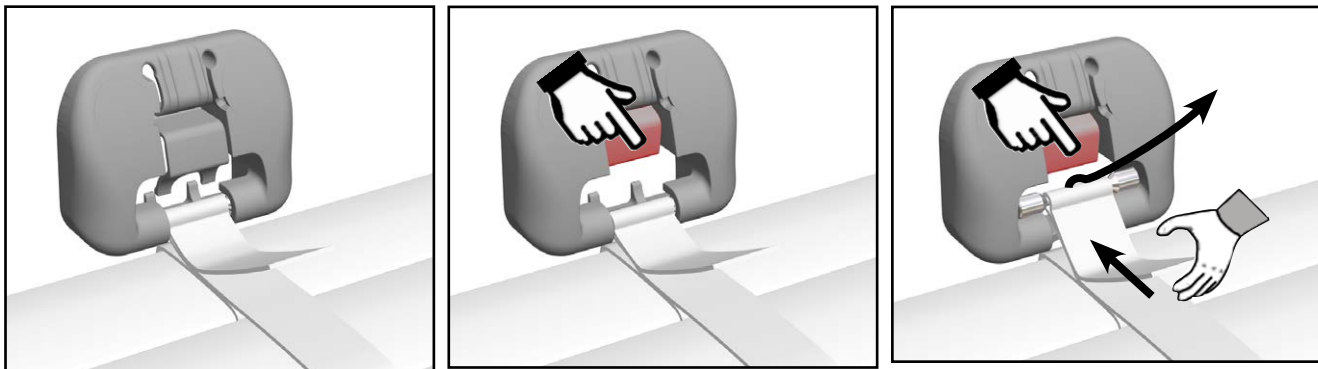

LOCKING AND RELEASING QUICK-LOCK

Locking

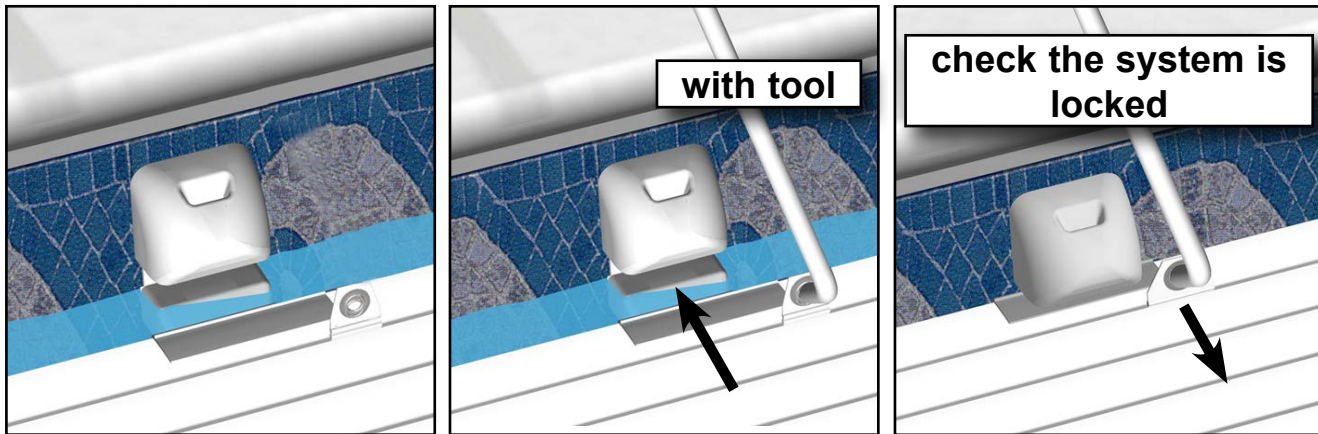

Releasing

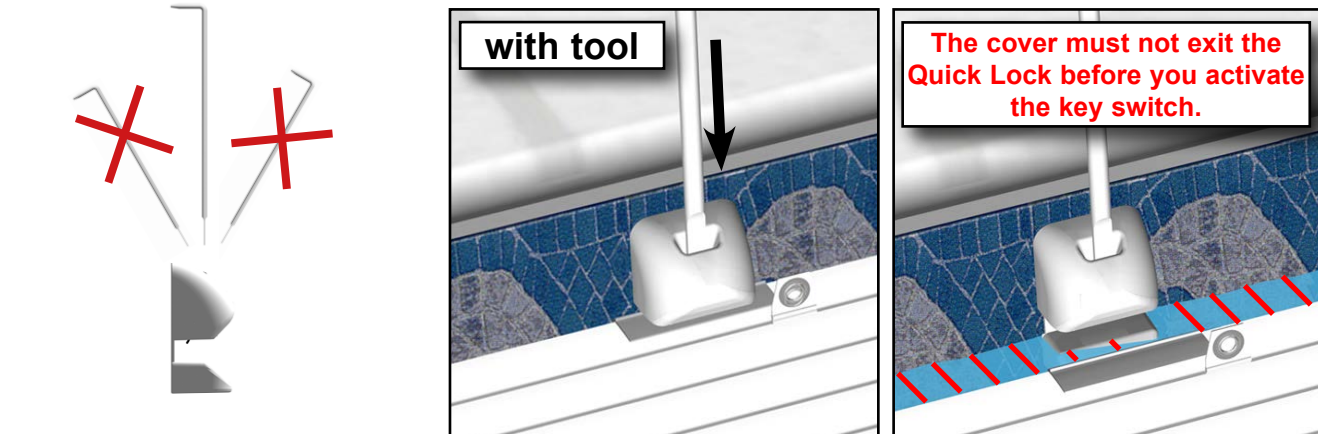

Pairing -- delivered pre-paired



Press «STOP» and, without releasing it, press «O» for more than 3 seconds
OK when the «pilot» flashes green.

an emitter must be paired within the next 30 seconds.

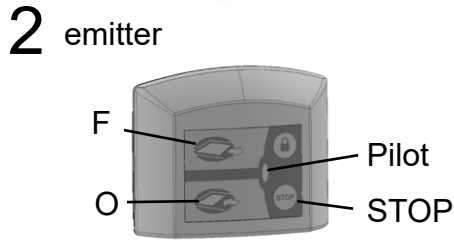

Press «STOP» and, without releasing it, press «O» for more than 3 seconds
OK when the «pilot» flashes red / green.

another emitter must be paired within the next 30 seconds.





Replacing the batteries







Be careful of the seal when re-assembling



	Receiver	Emitter	
Manufacturer	DEL	DEL	
Reference	Wikey receiver	Wikey emitter	
Category	3 (EN 300220-1)	3 (EN 300220-1)	
Range	50m in an obstacle-free zone	50m in a free zone	
	25m through a concrete wall	25m through a concrete wall	
Power supply	12 to 48 VDC 30mA max	Two 1.5V AAA batteries	
Protection index	< IP40	< IP54	



DL6010 CONTROL BOX LED MEANINGS

 Flashing LED	 Flashing LED	 Permanent LED	 Permanent LED
--	--	---	---

 	Initialisation <i>LEDs flash alternatively</i>	 	The motor is running <i>regular slow flashing</i>
--	--	--	---

 	Sensor fault <i>(check connections and cables) permanently on</i>
--	---

 	Electronic fault <i>(check connections and cables / return to the factory) fast flashing</i>
--	--

 	Software fault <i>(reprogram the automatic stops) Permanently on</i>
--	--

POOL WATER LEVEL

- In order to ensure the correct operation of the roller, always check that the pool water level is constant and compliant with manufacturer recommendations.
(the use of a water level regulator is mandatory)
- If the water level is too high, it might come from leaves in the skimmer.
- If the water level is too low there is a risk of jamming.
- In case of hand rails, the pool must be equipped with a water level regulator.

FILTERING

- Programme filtering during sunlight periods and operate it permanently as soon as the water reaches 25°C.

CLEANING (USER'S RESPONSIBILITY)

- Clean your cover fully twice a year (start of season and wintering). This is even more important if you have hard water. If this is the case, use a high pressure cleaner with warm water and a descaling product (see DEL catalogue).

The slats must only be cleaned using clear water or neutral detergents.

Especially avoid using alkaline (basic) or acid cleaning products.

Do not use abrasive products or equipment to clean, this could cause scratches. If necessary make a test on a small area of the cover that is not visible.

- Take the same care to regularly clean the locking systems for optimum operation.
- It is advisable to inspect the whole system in the event of abnormal strain on the cover (eg. somebody falling)
- Check the straps annually

MAINTENANCE

- All work must be carried out by a professional who will contact the manufacturer if necessary. (Contact details on the back of the document)
- All spare parts must be original.
- Inspect the whole cover for damage/wear and tear.
- At the beginning of each season and in the case of accidents (falls or hail on the cover, abnormal strain on the cover, etc.) check that the slats do not have any visible deterioration that could impact the operation of the cover (cracked, punctured, bent slats etc.). Change the slats or the whole cover if necessary.
- In both summer and winter, do not cover the slats with an opaque cover. There is a risk of damage due to excess heat.
- Check the straps (seams) and the anti-abrasion sheath.
- Once a year, check the electrical connections.
- - The «witness» flashes RED = change the control box battery

WINTERING

- Winter the pool depending on its geographic location.
- Close the cover.
- Wintering the gear motors:
- Close the cover in the safety position.
- Take the motor off, grease the stainless steel shaft and store it in a dry, ventilated room.
- Switch the mains supply off (control panel and circuit breaker)
- We recommend you install the IVERNEA winter shield to protect the cover from UVs and dirt

**DEAR CUSTOMERS,
THANK YOU FOR CHOOSING A DEL AUTOMATIC COVER.
PLEASE READ THE INSTRUCTIONS BELOW CAREFULLY.**

·POOLS CAN BE A SERIOUS DANGER FOR CHILDREN. DROWNING CAN HAPPEN QUICKLY.

S A F E T Y A D V I C E

WHEN CHILDREN ARE AROUND THE POOL THIS REQUIRES YOUR CONSTANT VIGILANCE AND ACTIVE SUPERVISION, EVEN IF THEY CAN SWIM.

LEARN LIFE SAVING TECHNIQUES.

REMEMBER AND POST THE EMERGENCY SERVICE NUMBERS CLOSE TO THE SWIMMING POOL.

- FIRE BRIGADE: 18 (IN FRANCE) OR 112 FROM A CELL PHONE
- AMBULANCE : 15 (IN FRANCE)
- POISON CENTRE:

·THIS COVER IS NOT A SUBSTITUTE FOR COMMON SENSE NOR FOR PERSONAL LIABILITY. THE PURPOSE OF THIS COVER IS NOT TO REPLACE THE VIGILANCE OF PARENTS AND/OR RESPONSIBLE ADULTS WHICH REMAIN THE ESSENTIAL FACTORS FOR THE SAFETY OF YOUNG CHILDREN.

·COMPLY WITH THE WATER HEIGHTS DEFINED BY THE MANUFACTURER.

·THE COVER MUST SYSTEMATICALLY BE CLOSED DURING ALL ABSENCES FROM HOME, HOWEVER SHORT.

·MAKE SURE THERE ARE NO BATHERS OR FOREIGN BODIES IN THE POOL BEFORE AND DURING CLOSING.

·PLACE THE NECESSARY TOOLS TO OPEN THE COVER OUT OF THE REACH OF CHILDREN (THE KEY FOR EXAMPLE)

·THE OPENING ACTION OF THE MECHANISM SHOULD ONLY BE UNDERTAKEN BY A RESPONSIBLE ADULT.

·IT IS FORBIDDEN TO CLIMB ONTO, WALK ON, OR JUMP ON AN AUTOMATIC COVER.

·A CHILD CAN DROWN IN UNDER 3 MINUTES, NO TYPES OF PROTECTIVE MEASURE CAN REPLACE SUPERVISION AND VIGILANCE BY A RESPONSIBLE ADULT.

·THE PHYSICAL PRESENCE OF A RESPONSIBLE ADULT IS ESSENTIAL WHEN THE POOL IS OPEN.

SWIMMING POOL BUILDER

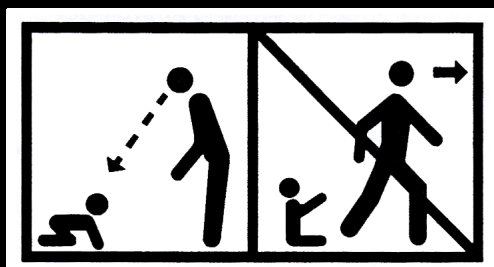

ZA La basse croix rouge 35530 Brécé - FRANCE - tel : + 33 (0)2 99 370 370